

Notes for next year's show:

- Take fewer brochures (about 500 visitor guides and 1,200 brochures)
- Have a rack card with info. on what Denton has to offer "Winter Texans"
- See about hotel/motel coupons
- See if Camping World wants to participate in any way (sponsor the rack card, discounts, etc.)
- Try to find a "giveaway" that can be used in RV's
-

* Contact made w/ Choice Hotels:

Susan West said Jerry Sheats is in Development and Sales and is with Choice Hotels.

The franchises we have that may be interested are:

- Clarion
- OR • Quality Inn (Inn and Suites)



copy to me
if send
show information
or success

January 13, 1999

Denton Convention & Visitor's Bureau
Christine Gossett
414 W. Parkway
Denton, TX 76201

Dear Ms. Gossett,

I would first like to thank you again for exhibiting at the 1999 McAllen International Travel Show. I hope you had a successful show. The numbers have been compiled and this year's attendance was totaled at 8000. As for the VIP Reception, 95 people attended, 40 of which were travel agents, tour operators, and/or group leaders. Lastly, there were a total of 124 booths sold - representing 95 organizations.

Enclosed in this packet you should find:

- List of door prize winners
- List of the attendees of the VIP Reception
- Area travel agent list
- A picture of your booth
- Evaluation form & postage-paid envelope
- Space reservation for the 2000 show

Please complete the evaluation form and the space reservation form and return them in the postage-paid envelope. We strive to improve the show each year and we depend on your comments and suggestions to help us serve you better in the future. We appreciate your feedback.

The space reservation form for the 2000 show does not obligate you to attend, but you will be able to reserve your preferred booth space early. You will be receiving the 2000 show information, including a contract and an invoice, early this summer. We look forward to seeing you in the next millenium!

Sincerely,

Nancy Millar

Nancy Millar
CVB Director

10 N. Broadway • P. O. Box 790
McAllen, Texas 78505-0790

956 682-2871 • 1-800-250-2591
fax 956 681-8571
www.mcallen.org

Affiliated Travel
Gloria Schuller
100 Savannah Ave., Ste. 101
McAllen, TX 78501

Glo Travel Services
Gloria Diaz
4313 N 10TH St.
McAllen, TX 78502

Julie's Travel Concepts
Julie Barnick
5401 N 10TH St.
McAllen, TX 78502

Sanborn's Viva Tours
Ed Gill
2015 S 10TH St.
McAllen, TX 78502

Shands-Brooks Travel
Debbie Brooks
30 Nolana Loop
McAllen, TX 78501

Travel Specialists
3215 N. McColl Rd.
McAllen, TX 78501

Azteca Mexico Tours
Javier Cadena
711 Nolana, Ste. 203-E
McAllen, TX 78504

American Express Travel Service
730 W. Nolana
McAllen, TX 78501

Global Travel & Charters
Jim Maples
1708 N. Jackson Rd.
Pharr, TX 78577

Mexico Adventures
David Flores
1010 Cesar Chavez
Alamo, TX 78516

Fantasy Travel Services
Shawn Doughty
2423 Griffin Pkwy
Mission, TX 78572

Global Travel & Charters
Jim Maples
5017 Expressway 83
McAllen, TX 78504

Rogers Tours
131 S 8TH St.
Donna, TX 78561

Scottie's Tours & Travels
Tina Martin
2717 N 10TH St.
McAllen, TX 78502

Travel Advisors International
Luis Manzano
1908 S Main St.
McAllen, TX 78503

Travel Zone
1201 Chicago Ave.
McAllen, TX 78501

TurTex Tours LC
309 W. Expressway 83
San Juan, TX 78527

Aristos Travel, Inc.
Rosa Maria Soveron
319 S 11TH St.
McAllen, TX 78501

Go With Jol
Larry Rogala
4313 N. 10TH St., Ste. F-8
McAllen, TX 78502

Cruises By Dee
Dee Montalvo
1722 Pecan Ave.
McAllen, TX 78501

Fritz's Adventures
John Fritz
800 E Expressway 83
Pharr, TX 78577

Gray Line Tours/Turimex
Ricardo Macias
1908 S Main St.
McAllen TX 78503

Sanborn's Travel
Anne Foresman
2011 S 10TH St.
McAllen, TX 78502

All Ways Travel
Natie Watua
420 N. 10TH St.
McAllen, TX 78503

Travel Experts
Bill Hewitt
5109 N 10TH St.
McAllen, TX 78502

Travels Only
Rene Cantu
523 S. Closner
Edinburg, TX 78539

Winter Texan Budget Tours
Mejed Khuffash
413 Nolana Loop
McAllen, TX 78501

Avion Travel, Inc.
Norma Casares
5113 N McColl Rd.
McAllen, TX 78501

Chuck Olson Tours
Chuck Olson
3827 N. 10TH St., Ste. 203
McAllen, TX 78503

Echo Travel Agency
1903 S. Closner
Edinburg, TX 78539

1999 McAllen International Travel Show Evaluation Form

Please take a moment to complete this form and mail it in the enclosed postage-paid envelope or fax it to 956/631-8571. Your feedback is vital in helping us to improve the show to make it better for you next year. Thank you.

1. How effective do you feel the show was for you this year?

Excellent Very good Fairly good Not very effective

2. How did you feel about the quality of the attendees?

Excellent Very good Fairly good Poor

3. How did you feel about the quantity of the attendees?

Excellent Very good Fairly good Poor

4. How did you feel about the VIP reception?

Excellent Very good Fairly good Poor

5. How did you feel about the service you received from show personnel?

Excellent Very good Fairly good Poor

6. How did you feel about the communication/correspondence with show management? Was everything clear and timely?

Excellent Very good Fairly good Poor

7. How can the show be improved for next year?

YOUR REPLY WOULD BE GREATLY APPRECIATED!

2000 McAllen International Travel Show Space Reservation Form

Company Name: _____

Contact Person: _____

Address: _____

City: _____ ST: _____ Zip: _____

Phone: _____ Fax: _____

Please hold _____ 10x10 booths for the 2000 McAllen International Travel Show.

Please list your booth number preference:

1st choice: _____ 2nd choice: _____ 3rd choice: _____

Choices may include placement with entities from your region.

This does not obligate you to attend the 2000 show, it is just a reservation and can be canceled. You will still receive the complete show details and contract, but your space will already be set aside for you. If you have any questions please call show management at 1-877-McALLEN (1-877-622-5536). Thank you.

Please fax to 956/631-8571 or return in the postage-paid envelope.



ATTENDEES

McAllen Mobile Park
Janet Ashcraft
4900 N. McColl, #278
McAllen, TX 78504

Mission Mobile Park
Activity Director
930 W. Expressway 83
Mission, TX 78572

Mission Canyon
Activity Director
Rt. 8 Box 3600
Mission, TX 78572

Casa Del Valle
Activity Director
1048 N. Alamo Rd.
Alamo, TX 78516

7 Oaks Country Club
Keith Dietrich
2006 Lake Front Dr.
Mission, TX 78572

Bob Bollman
5105 Doral Ave.
Harlingen, TX 78552

Southern Comfort
Ken Rye
1501 S. Airport Dr., #40
Weslaco, TX 78596

Contact US
P.O. Box 1347
McAllen, TX 78501

Eugene McGown
3100 Umar
McAllen, TX 78504

Wagon City
Mr. & Mrs. Olsen
2905 N. Conway
Mission, TX 78572

Bob Hartness
P.O. Box 1596
McAllen, TX 78505

Casa Del Valle
Emery Otnes
1048 N. Alamo Rd.
Alamo, TX 78516

Mario's Tours
Norma de Ferron
Calle 9, #295
Reynosa, Tamps. 88710
Mexico

Maria Austin
100 W. Moore Rd., #82
Pharr, TX 78577

Jaime Estrada
Rt. 1 Box 58
Alamo, TX 78516

Fiesta Village
Kay King
205 S. Stewart, #99
Mission, TX 78572

Mission Mobile Park
Peg Vogelsang
930 W. Expressway 83
Mission, TX 78572

Adobe Wells Country Club
Ormal Guinn
4901 Daffodil, #45
McAllen, TX 78501

Travel Experts
Noe Tamez
5109 N. 10th St.
McAllen, TX 78504

Fantasy Travel Services
Olivia Mendoza
1502 N. 10th St.
McAllen, TX 78501

Sanborn's International Travel
Arnold Tijerina
2011 S. 10th St.
McAllen, TX 78503

All Ways Travel
Fernando Vera
1908 S. Main St., Second Floor
McAllen, TX 78503

Avion Travel, Inc.
Marisa Garza
5113 N. McColl Rd.
McAllen, TX 78504

Glo Travel Services
Shelley Andreatos
4313 N. 10th, Ste. E
McAllen, TX 78504

Travels, Etc., Inc.
Martha Veach
311 S. Missouri
Weslaco, TX 78596

Trek Travel
Aaron Dagan
2017 W. Expressway 83, Ste. 4
Weslaco, TX 78596

Aristos International Travel
Yvette Salinas
200 S. 10th St., Ste. 1109
McAllen, TX 78501

The Monterrey Connection
J.C. Martinez
(956) 618-1416

Grace Tamesis, M.D.
4426 S. McColl Rd.
Edinburg, TX 78539

Rogers Tours
Alfred W. Rogers
131 S. 8th St.
Donna, TX 78537

Echo Travel Agency
Debbie Kuehn
1903 S. Closner, Ste. 2
Edinburg, TX 78539

Holiday Inn Express
Nannette Palomo
2000 S. 10th St.
McAllen, TX 78501

Radio Unica
Roberto Hugh Gonzalez
201 S. 15th St., Ste. 300
McAllen, TX 78501

Texas Workforce Commission
Lolita Pagarani
1002 E. Expressway 83
Weslaco, TX 78596

Dale Winter, M.D.
1009 S. 77 Sunshine Strip
Harlingen, TX 78550

Office Furniture USA
Perla E. Sandoval
1807 N. 10th St.
McAllen, TX 78501

Rosie Fernandez
(956)926-1633

H. Martin Withington
2424 N. 10th St., Ste. 201
McAllen, TX 78501

Diana Weisser
208 W. Nolana
McAllen, TX 78504

Maynard Kreidler
2100 S. 5th St., #2
McAllen, TX 78503

Chase Bank
Marisa Morales
P.O. Box 1300
McAllen, TX 78505

Marianne Hartness
P.O. Box 1596
McAllen, TX 78505

Diana E. Gutierrez
720 Windsor Glen
Mission, TX 78572

H. Ray Lewis
511 N. Rose Ellen
McAllen, TX 78501

Harvey Kowalski
312 Rio Grande Dr.
Mission, TX 78572

Juanita L. Taylor
304 Admiral Benbow
McQueeney, TX 78123

Edna Houston
LAMAC - H.E.B.
510 N. 15th
McAllen, TX 78501

Alma Ornelas
612 Pineridge
Edinburg, TX 78539

Ellie Cantu
2011 S. 10th St.
McAllen, TX 78501

Cindy Caballero
201 S. Utah
Weslaco, TX 78596

Topp Direct Marketing
Nora Bollman
1222 E. Tyler
Harlingen, TX 78550

Dennis Snyder
3112 Rose Ellen Dr.
McAllen, TX 78503

Mexican Consulate
Maria Del Carmen Austin
600 S. Broadway
McAllen, TX 78501

AAA Personnel
Jennie Morehead
4311 N. 10th St., Ste. C
McAllen, TX 78504

FedEx USA AirbillFedEx
Tracking
Number

809278638686

Form
I.D. No.

0200

Sender's Copy**1 From** (please print and press hard)

Date: 12/16/98 Sender's FedEx Account Number: 113029994

Sender's Name: Christine Gossett Phone: (410) 382-7895

Company: Denton CVB - Chamber of Commerce

Address: 414 W. Parkway Dept./Floor/Suite/Room

City: Denton State: TX ZIP: 76201

2 Your Internal Billing Reference Information
(Optional) (First 25 characters will appear on invoice)**3 To** (please print and press hard)

Recipient's Name: MITS Booth # 414 Phone: (456) 686-3021

Company: FCD CONVENTION DECORATOR, INC.

Address: 1312 EAST UPAS Dept./Floor/Suite/Room

City: McAllen State: TX ZIP: 78501

For HOLD at FedEx Location check here Hold Weekday (Not available on FedEx First Overnight and FedEx Last Overnight)
 Hold 9:00 a.m. to 5:00 p.m. (Not available at all locations. Available on FedEx Priority Overnight and FedEx 2Day only)**For WEEKEND Delivery check here** (Extra charge. Not available by destination) Saturday Delivery (Available for FedEx 1R or 2Y Overnight and FedEx 2Day only)
 NEW Sunday Delivery (Available for FedEx Priority Overnight only)

Service Conditions, Declared Value, and Limit of Liability - By using this Airbill, you agree to the service conditions in our current Service Guide or U.S. Government Service Guide. Both are available on request. SEE BACK OF SENIOR'S COPY OF THIS AIRBILL FOR INFORMATION AND ADDITIONAL TERMS. We will not be responsible for any claim in excess of \$100 per package whether the result of loss, damage, or delay, non-delivery, misdelivery, or misrouting, unless you declare a higher value, pay an additional charge, and document your

actual loss in a timely manner. Your right to recover from us for any loss includes intrinsic value of the package, loss of sales, interest, profit, attorney's fees, costs, and other forms of damage, whether direct, incidental, consequential, or special, and is limited to the greater of \$100 or the declared value but cannot exceed actual documented loss. The maximum declared value for any FedEx Letter and FedEx Pak is \$500. Federal Expresses may, upon your request, and with some limitations, refund all transportation charges paid. See the FedEx Service Guide for further details.

Questions?

Call 1-800-Go-FedEx® (800)463-3339

*The World On Time.***4a Express Package Service** Packages under 150 lbs. Delivery commitment may be later in some areas. FedEx Priority Overnight (Next business morning)
 FedEx Standard Overnight (Next business morning)
 FedEx First Overnight (Earliest next business morning; delivery to select locations) (Rates and rules apply)
 FedEx 2Day (Second business day)
 FedEx Express Saver (Third business day)
FedEx Letter Box not available. Minimum charge: first pound rate.**4b Express Freight Service** Packages over 150 lbs. Delivery commitment may be later in some areas. FedEx Overnight Freight (Next business day)
 FedEx 2Day Freight (Second business day)
 FedEx Express Saver Freight (Up to 3 business days)
(Call for delivery schedule. See back for detailed descriptions of freight services.)**5 Packaging** FedEx Letter (Declared value limit \$500)
 FedEx Pak
 FedEx Box
 FedEx Tube
 Other Pkg.**6 Special Handling** (Time how must be checked)Does this shipment contain dangerous goods? No Yes (Shipper's responsibility) Yes (Carrier's responsibility)
 Dry Ice (Dry Ice, S. UN 1845) Cargo Aircraft Only
*Large amount of dry ice requires a signed air bill package.**7 Payment**Bill to: Sender (Invoice No. in Section 1 will be billed) Recipient (Enter FedEx Account No. or Credit Card No. below) Third Party Credit Card Cash/CheckFedEx Account No: 113029994
Credit Card No. Exp. DateTotal Packages: Total Weight: Total Declared Value*: \$00.00
Total Charges:

*When declaring a value higher than \$100 per shipment, you pay an additional charge. See SERVICE CONDITIONS, DECLARED VALUE, AND LIMIT OF LIABILITY section for further information.

8 Release Signature Sign to authorize delivery without obtaining signature.

Your signature authorizes Federal Express to deliver this shipment without obtaining a signature and agrees to indemnify and hold harmless Federal Express from any resulting claims.

322

Rev. Date 3/98
Form F15E224
©1998 FedEx
PRINTED IN U.S.A.



December 1, 1998

Ms. Alana Myles
Radisson Hotel Denton
2211 N. Interstate 35 E
Denton, TX 76205

Dear Alana:

In January I will go to McAllen, Texas to participate in a travel show for "Winter Texans". The show will be a great opportunity to showcase the recreation and leisure activities in Denton. Would the Radisson be interested in donating a weekend getaway package for the VIP door prize drawing?

Please contact me if you are interested. I will need a description of the package for the announcer, too. Thank you in advance for your support!

Sincerely,

Christine Gossett
Denton Convention & Visitor Bureau



Free
Samples

FREE
ADMISSION

Winter Texan Expo '99

McAllen Civic Center
McAllen, Texas
 January 27, 28, 1999
 9:00 a.m. - 5:00 p.m.
 (Both days)

Casa de Amistad
Harlingen, Texas
 February 2, 3, 1999
 9:00 a.m. - 5:00 p.m.
 (Both days)

Free
Drawings

**"The Largest Winter Texan Event
 in the Rio Grande Valley"**

Free
Prizes



**COME PLAY THE TEXAS STATE BANK
 "TEXAS TWISTER" MONEY MACHINE**

**Doctors • Chiropractors • Furniture Companies • Travel Agencies
 Hospitals • Restaurants • Chamber of Commerce • Banks & Financial
 RV Dealers • Tire Companies • Fruit & Vegetable Dealers
 Medical Equipment & Much, Much More!**

Winter Texan, this is your show!

New Entertainment This Year: John Wayne Impersonator, Dr. Gene Howard

Cloggers
 Mariachis

**Free Admission
 Compliments of:**



THE MONITOR

**Be sure to visit
 all exhibitors
 and sponsors.
 They are there
 for you.**

Co-Sponsored by:

- The Monitor
- Valley Morning Star
- Texas State Bank
- McAllen Medical Center
- Valley Keyboards

- Hess Air
- Whalens Furniture
- Valley Garden Center
- Klements Grove
- Payne Dealer Group

- Active Mobility
- Medi-stat/Therapies of Texas
- Fuddruckers
- Rio Grande Valley Livestock Show

McAllen Medical Center
 Edinburg Regional Medical Center
 UHS Rehabilitation Pavilion

© 1999 UHS HEALTH SERVICES, INC. TEXAS



Winter Texan Expos I & II

McAllen Civic Center January 27 & 28, 1999
Harlingen Casa de Amistad February 2 & 3, 1999

According to the latest survey, Winter Texans spend \$318 million in the Rio Grande Valley each year. For anyone who wants to get their share of this lucrative tourist market, these two shows are the prime opportunity. They are annual events which are held each year at the peak of the winter season when the Winter Texan population is at its highest point.

The Expos are always a sell out. All exhibit space is sold completely and attendance on show days is always fantastic.

The Expos are the largest in the entire Rio Grande Valley and are the largest Winter Texan Expos in the entire state of Texas. They will attract approximately 40,000 people.

Marketing is directed to those businesses that deal with and are of interest to seniors and Winter Texans. As a result, they are more interested in attending the shows in order to see the exhibitors and obtain promotional material or other show discounts. The end result is much higher attendance and more successful shows. An additional attraction is that there is "No Admission" charge.

A high advertising budget allows extensive promotion of the Expos by radio, television, newspaper as well as direct contacts with all RV parks in the Valley. For maximum exposure, promotional material is posted in all RV and trailer parks as well as in other businesses patronized by the tourists long before the Expos.

Additional attractions are planned for the upcoming Expos. Local and well known "Mariachis" will perform as well as a unique group of "Cloggers". The McAllen Expo will feature a favorite of many, well known impersonator of John Wayne, Dr. Gene Howard. Dr. Howard has appeared on numerous radio and TV shows and is well known as a patriotic speaker and entertainer. He was recently presented the prestigious "Spirit of America" award for his Patriotic and moral stand for America. This will be a real hit with the Winter Texans due to the age group and since a high percentage are Veterans.

Expos I & II are an ideal opportunity for exhibitors to introduce and promote their business or products to thousands of people on a one to one basis. In addition to the sales of products or services, special show discounts, promotional and advertising materials, coupons, etc. can be distributed to attract new customers to your business.

P.O Box 2951 • McAllen, Texas 78502 • Phone (956) 682-9580 • Fax (956) 682-9582

Exhibit space rental is as follows:

The 10' X 10' Booth space is \$550.00 for each show.

The 10' X 20' Booth space is \$895.00 for each show.

The professional decoration of the exhibit halls consists of a completely furnished booth with eight foot back drop curtains, three foot side curtains in attractive and pleasing colors, skirted table(s) chairs and identification sign. Electrical service is furnished at no charge.

Twenty four hour security is provided during move in as well as during the Expos.

For additional information or to arrange for reservations, please contact our offices at (956) 682-9580 or fax (956) 682-9582.

Capitalize on these last two shows of the Twentieth Century. Reserve your booth space now.

The bottom line This is your once a year opportunity to have thousands of potential customers before you. If you are interested in getting your part of the millions of dollars spent by the Winter Texans in the Valley each year, then Winter Texan Expos I & II are for you.

The Eleventh Annual McAllen International Travel Show

January 6th & 7th, 1999
McAllen Civic Center

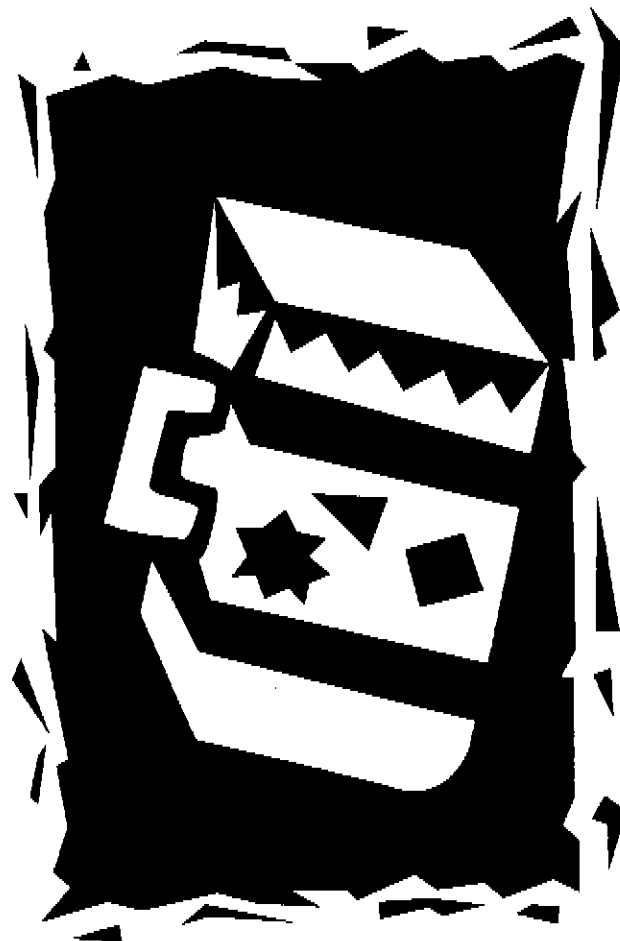

Sponsored by the McAllen Chamber of Commerce

1999 McALLEN INTERNATIONAL TRAVEL SHOW

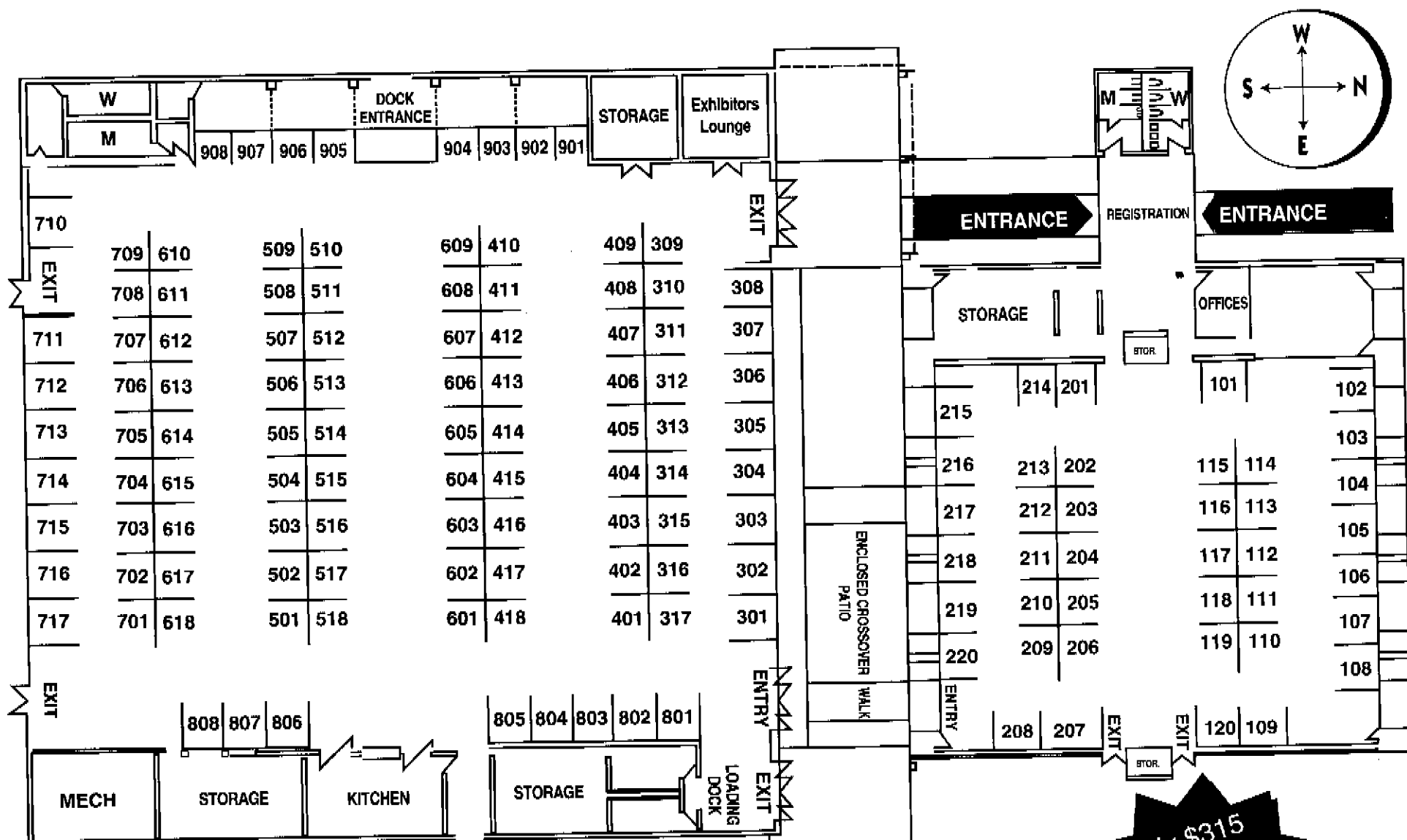

Hours			
Setup	Tuesday	January 5	12:00 - 7:00 p.m.
Setup	Wednesday	January 6	8:00 - 10:00 a.m.
Public Show	Wednesday	January 6	10:00 - 5:00 p.m.
VIP Reception	Wednesday	January 6	5:30 - 7:00 p.m.
Public Show	Thursday	January 7	10:00 - 5:00 p.m.

**Only \$315
per 10 x 10
Booth!
Sign up
TODAY!**



Join us, this January 6th & 7th, for the Eleventh Annual McAllen

International Travel Show, sponsored by the McAllen Chamber of Commerce. This year's show will prove to be bigger and better than ever. We continually strive to improve the show so that our exhibitors get the highest value for their investment. Thanks to all of the previous year's exhibitors whose comments and suggestions have helped us improve the show for 1999.

The goal of the McAllen International Travel Show is to give our exhibitors the opportunity to showcase their products or destinations to the tens of thousands of "Winter Texans" who migrate south to the *Texas Tropics*. This show is restricted to travel and tourism related organizations only and is offered FREE to the public. The show is publicized via local TV, radio and newspaper advertising. This in this advertising effort by official McAllen International Travel magazine-like section dedicated to Show, its exhibitors and travel articles. Check out the *Details*

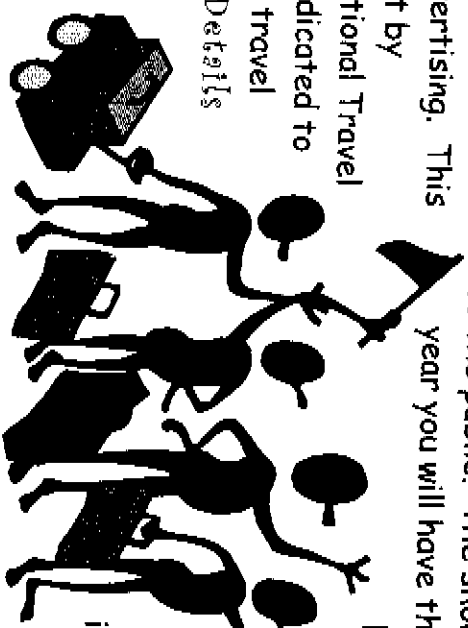

Some of the exhibitor suggestions hours (10am-5pm), to Wednesday evening, wider isles for improved traffic flow, switching the main entrance to the Tourist Center and more opportunities for exposure through advertising opportunities.

year you will have the opportunity to participate purchasing an AD in the Show newspaper tab, a travel, the Travel related topics and and learn more!

improvements made due to include: improved show changing the VIP reception

Please review all of the details about this year's show and the many opportunities you have for marketing your organization to the tens of thousands of seniors who are in the habit of traveling and have the time and the money to do so. What a great demographic to market to, and the McAllen International Travel Show is the ideal vehicle to use! Please contact me personally if you have any questions or need further information. I look forward to seeing you at this year's show!

Sincerely,

Shawn

Shawn Withington
Show Manager



McAllen International Travel Show 1-800-250-2591

Details, Details, Details ...

Eleventh Annual
McAllen International
Travel Show

Wednesday, January 6, 1999
General Public: 10am to 5pm
VIP Reception: 5:30pm to 7pm

Thursday, January 7, 1999
General Public: 10am to 5pm
Breakdown: 5pm to 10pm

Who Should Exhibit?

- Tour Operators
- Hotels & Resorts
- Car Rental Companies
- Cruise Lines
- RV Parks & Campgrounds
- Airlines
- Tourism Offices
- Travel Agencies

Registration Includes

10' x 10' Pipe and Drape; 6-foot skirted table, 2 chairs, 2-110v outlets and a 7" x 44" ID sign. **New VALUE ADDED** features include: listing by booth in the newspaper TAB, a 1 column x 1 inch "Classified AD" (per registration) in the TAB and web page link to *themonitor.com*.

Terms

Each booth registration is \$315. Full payment is requested with signed contract. All payments are due by December 15, 1998. NO refunds on cancellations made after December 15, 1998.

Maximize Your Exposure

Purchase an AD in the McAllen International Travel Show newspaper TAB and promote your attendance in the show. This TAB is an ideal vehicle to reach tens-of-thousands of local area residents and Winter Texans.

Giveaways & Door Prizes!

Exhibitors are encouraged to bring giveaways and donate door prizes. You are welcome to register folks at your booth or let us handle all of the work for you. ALL prizes will be given to the winners after the show.

McAllen has full jet service via Continental & American Airlines. There are several car rental companies in the area; contact information will be in the Exhibitor packets.



Hotel Accommodations

With over 20 hotels in the area you won't have trouble finding one to fit your taste or budget. A complete list of hotels and special Travel Show rates will be included in the Exhibitor packet.

Exhibitor Packets

Once payment is received, a detailed exhibitor packet will be sent to you. It will include the sign-up forms for nametags, door prize donations, "Classified AD" information (Monitor TAB) and the FINAL DETAILS about the show.

Decorator

Information about shipping instructions, service order forms for carpet, special decorations, and services will be included in the Exhibitor packet.



Setup & Breakdown

Booths can be set up on Tuesday, January 5, 1999 from 12 noon to 7pm. Exhibitors may enter the hall at 8am on Wednesday. Displays can be dismantled after 5pm on Thursday.

Security

The hall will have security both Tuesday and Wednesday nights. The Civic Center parking lot will be patrolled during setup, hours and Every effort will be made to protect your goods; however, the McAllen Chamber of Commerce is not responsible for lost or stolen property.



Lots to See & Do!

McAllen offers plenty of diversions to keep you busy during any "down-time" you might have, including: dining, nightlife, and shopping, MEXICO! Call 1-800-250-2591, for a Visitors Guide.



? Questions ?

If you have any questions about the 1999 McAllen International Travel Show, please call Shawn Withington, at 1-800-250-2591.

INVOICE

November 30, 1998

McAllen Chamber of Commerce
P.O. Box 790
McAllen, TX 78505-0790

BILL TO: Denton Convention & Visitor's Bureau
Ms. Gossett
414 W. Parkway
Denton, TX 76201

CVB#

Description	Quantity	Total
Travel Show Booth	1	\$315.00
TOTAL DUE		\$315.00

Due no later than December 15, 1998

If payment has been sent please disregard this notice. Thank you.

If you have any questions regarding this invoice,
please call 1-877-McALLEN (622-5536)



December 11, 1998

Denton Convention & Visitor's Bureau
Christine Gossett
414 W. Parkway
Denton, TX 76201

Dear Ms. Gossett:

Thank you for exhibiting in the 1999 McAllen International Travel Show. Please make sure the door prize information is accurate. At this time you have registered the following **GENERAL PUBLIC** door prizes:

1. 1 Denton umbrella
- 2.

You have also registered the following **VIP** door prizes:

1. Golf package for 2
- 2.

According to our records we still need the following items from you:

ITEM	Need
NO Additional information needed	X
Name tag/ID Sign Forms	
General Public Door Prize Registration*	
VIP Door Prize Registration*	
Classified Ad information	

If you have already sent these items please disregard.

***OPTIONAL**

Please forward any items to Show Management as soon as possible. If you have any questions please call 1-877-McALLEN (1-877-622-5536). Thank you.

Sincerely,

Shawn Withington
Show Manager

10 N. Broadway • P. O. Box 790
McAllen, Texas 78505 0790

956 682-2871 • 1-800-250-2591
fax 956 631 8571
www.mcallen.org

SHIPPING INFORMATION

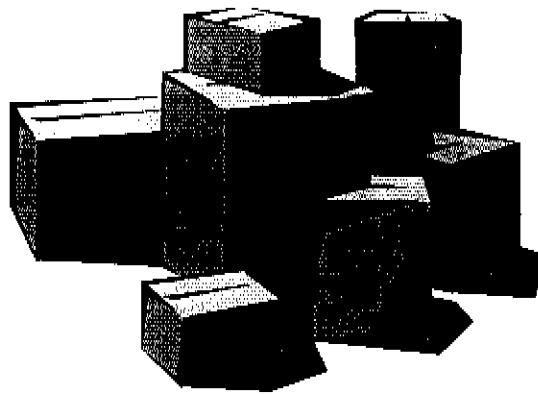

Due to the Christmas holidays, FCD will be closed from 12/19/98 thru 12/27/98.
Make sure your shipments arrive before or after these dates.

All materials should be delivered to FCD before 1/4/99,
otherwise ship your materials directly to the Civic Center.

SAMPLE SHIPPING LABELS

TRAVEL SHOW	Booth #: <u>414</u>	TRAVEL SHOW	Booth #: _____
FCD Convention Decorator, Inc. 1312 East Upas McAllen, TX 78501		McAllen Civic Center 1300 South 10th Street McAllen, TX 78501	

Please direct any questions about shipping, drayage and display rentals directly to FCD.

Billing Address: FCD Expo Convention Decorator, Inc.

P.O. Box 4123

McAllen, TX 78502-4123

Phone: 956/682-0711.

Fax: 956/686-3021

See the enclosed Exhibitor Service Manual for complete details.



SPD ✓

CONVENTION & VISITORS BUREAU
a division of the McAllen Chamber of Commerce

Denton CVB
Christine Gossett
414 West Parkway
Denton, TX 76201

November 17, 1998

Dear Ms. Gossett:

Thank you for ~~exhibiting at the~~ 1999 McAllen International Travel Show. You have been assigned booth # 414. Enclosed in this packet you will find:

- ◆ Reminder of Final Details
- ◆ Updated booth layout
- ✓◆ Hotel accommodations & transportation information
- ◆ Shipping information
- ✓◆ Name tag and booth ID sign form
- ✓◆ General Public Door Prize Registration form
- ✓◆ VIP Door Prize Registration form
- ◆ Classified Ad information for the Monitor TAB
- ◆ Plant/Flower Rental Information
- ◆ Exhibitor Service Manual from FCD Expo Convention Decorator, Inc.

Please return the forms to show management by December 1, 1998. If you have any questions please call toll-free 1-877-McALLEN (1-877-622-5536). Thank you for your prompt attention.

Sincerely,

Shawn Withington 1-877-622-5536 toll free
Show Manager

Bring about 3,500 brochures

- Approximately 10,000 attend

- About 100 VIP's attend

(travel agents & tour operators)

10 N. Broadway • P. O. Box 790
McAllen, Texas 78505-0790

956 682-2871 • 1-800-250-2591
fax 956 631-8571
www.mcallen.org

Hotel Accommodations

Tues, Jan 5 AMERICAN
 Flt. #1051 Departs 6:36 pm at DFW
 8:12 pm arrival
 Friday, Jan. 8th
 Flt. #1227 11:40 am from McAllen
 arrives 1:15 pm
 R.T. Fare \$204 round-trip airfare
 Holding conf. # TMMCQL
 Holding until 12/02/98

Direct service into McAllen: American 800-433-7300 & Continental 800-525-0280
 Service into the McAllen Area: Southwest (Harlingen) 800-435-9792

## Drury Inn 687-5100 * 687-5100 * 800-325-8300	\$62.95	\$72.95	Quick+	No
## Embassy Suites 686-3000 * 972-1370 * 800-EMBASSY	\$89.00	\$89.00	Full	Yes
## Holiday Inn Civic Center 686-8471 * 682-7187 * 800-839-8748	\$78.00	\$88.00	NO	Yes
## Holiday Inn Express-McAllen 686-1741 * 682-7187 * 800-839-2748	\$69.00	\$79.00	Quick+	Yes
## La Quinta Inn 956 area code 687-1101 * 687-9265 * 800-531-5900 conf. # 11187574	\$68.00	\$73.00	Quick	Yes
## McAllen Airport Hilton Inn 687-1101 * 687-7840 * 800-346-2878	\$84.00	\$94.00	Full	Yes
## Microtel 630-2727 * 630-0666 * 800-621-5890	\$41.00	\$45.00	Quick	No
## Ramada Limited-McAllen 686-4401 * 682-9538	\$59.00	\$59.00	Quick	No
## Rodeway Inn 686-1586 * 686-4173	\$43.00	\$48.00	Quick	No
## Super 8 782-3330 * 782-8881	\$40.00	\$45.00	Quick	No

(All Area Codes are 956)



Direct service into McAllen: American 800-433-7300 & Continental 800-525-0280
 Service into the McAllen Area: Southwest (Harlingen) 800-435-9792



Advantage Rent-A-Car 631-7900 Budget Rent-A-Car 686-0323
 Dollar Rent-A-Car 687-7297 Avis/Hertz/ National



Plant/Flower Information



Company	Phone Fax	Items (For Sale or Rent)	% OFF	Delivery	Credit Cards
Waugh's Nursery	686-5591 686-0994	Plants, flowers & gift baskets	Call for details	YES	Visa, M/C, AmEx, Disc.
Valley Garden Center	682-9411 682-5604	Plants, flowers, arrangements	10%	YES	Visa, M/C, AmEx, Disc.
Klement's Grove	682-2980 682-2998	Gift Baskets of fruit and stuff	10%	YES	Visa, M/C
Cottage Garden Flowers 954/686-3461	800-962-5143 682-2063	Flowers, plants, balloons, gift baskets	15%	YES	Visa, M/C, AmEx, Disc.
Jack-Lins Florist	686-5252 686-7035	Plants, balloons, flowers, gift baskets	10%	YES	Visa, M/C, AmEx, Disc.

Design - arranging stars on
something

BOOTH NUMBER REVISION: PLEASE NOTE!!

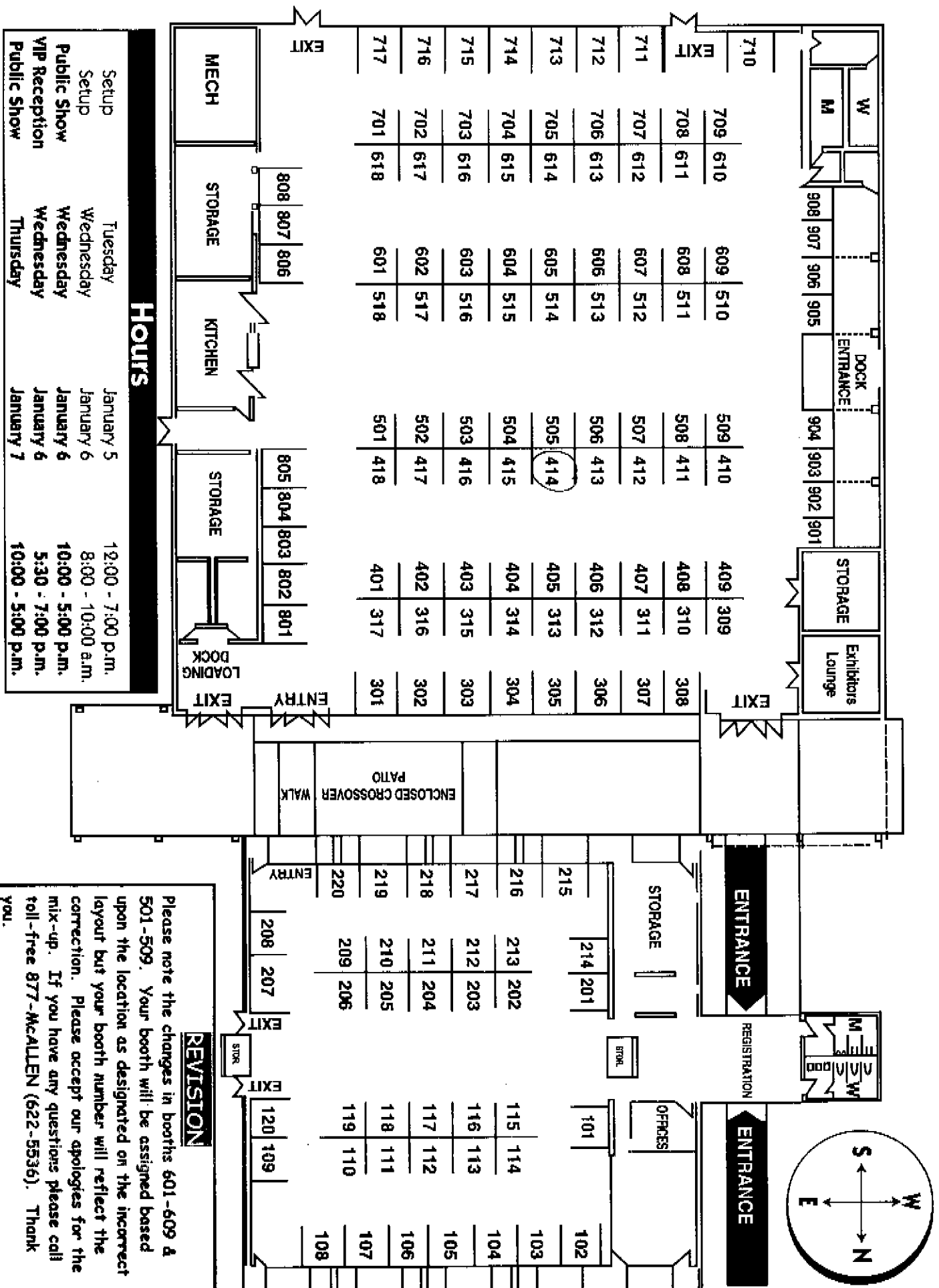

	Tuesday	Wednesday	Thursday
Setup	January 5	January 6	January 7
Public Show	January 6	January 6	January 7
VIP Reception	January 6	January 6	January 7
Public Show	January 7	January 7	January 7

HOURS

	January 5	January 6	January 7
Setup	12:00 - 7:00 p.m.	8:00 - 10:00 a.m.	10:00 - 5:00 p.m.
Public Show	8:00 - 10:00 a.m.	10:00 - 5:00 p.m.	5:30 - 7:00 p.m.
VIP Reception	5:30 - 7:00 p.m.	5:30 - 7:00 p.m.	10:00 - 5:00 p.m.
Public Show	10:00 - 5:00 p.m.	10:00 - 5:00 p.m.	10:00 - 5:00 p.m.

Send Confirmation Report

Name: CVB

ID: 940 382 6287

12 Nov'98 11:00AM Page 1

Job	Start time	Usage	Phone Number or ID	Type	Pages	Mode	Status
544	11/12 11:00AM	0'32"	19566318571	Send	1/ 1	EC 98	Completed

Total: 0'32" Pages sent: 1 Pages printed: 0

McAllen International Travel Show
January 6 & 7, 1999
Exhibitor Registration

Company Name: Denton Convention & Visitor Bureau
 Contact Person: Christine Gossett
 Address: 414 W. Parkway
 City: Denton ST: TX zip: 76201
 Phone: 940/382-7895 Fax: 940/382-6287

\$315 per 10 x 10 Booth

Price includes: pipe & draped booth, skirted 6' table, two chairs, 2-110v outlets & a 7"x44" sign.
 NEW VALUE ADDED: Monitor TAB "Classified AD", TAB booth listing and web-page link with themonitor.com.

1 # booth(s) at \$315 each Total Due: \$ 315.00

Please list your booth number preference:

1st choice: 401-409 2nd choice: 601-609 3rd choice: 317-309

◆ Choices may include placement with entities from your region. ◆

Every effort will be made to honor your choices; however, final placement is at the show manager's discretion.

ALL PAYMENTS DUE by December 15, 1998 or space will be reassigned.

In witness whereof, the above agreement (including the Rules & Regulations on the Back of this form) is signed on this 12 day of November, 1998.

Christine Gossett
 EXHIBITOR'S SIGNATURE

PLEASE return white copy along with PAYMENT to: McAllen Chamber of Commerce—Travel Show
 P.O. BOX 790
 McAllen, TX 78505-0790
 PH: 956/682-2871 FAX: 956/681-8571

FOR OFFICE USE ONLY

Rcvd _____ Rspd _____ Asgn _____
 Pmt _____ Pmt \$ _____ Pmt # _____

Faxed
 11/12/98
 Payment
 Due by
 12-15-98

McAllen International Travel Show
January 6 & 7, 1999
Exhibitor Registration

Company Name: Denton Convention & Visitor Bureau
Contact Person: Christine Gossett
Address: 414 W. Parkway
City: Denton ST: TX zip: 76201
Phone: 940/382-7895 Fax: 940/382-6287

\$315 per 10 x 10 Booth

Price includes: pipe & draped booth, skirted 6' table, two chairs, 2-110v outlets & a 7"x44" sign.
NEW VALUE ADDED: Monitor TAB "Classified AD", TAB booth listing and web-page link with themonitor.com.

1 # booth(s) at \$315 each Total Due: \$ 315.00

Please list your booth number preference:

1st choice: 401-409 2nd choice: 601-609 3rd choice: 317-309

◆ Choices may include placement with entities from your region. ◆

Every effort will be made to honor your choices; however, final placement is at the show manager's discretion.

ALL PAYMENTS DUE by December 15, 1998 or space will be reassigned.

In witness whereof, the above agreement (including the Rules & Regulations on the Back of this form) is signed on this 12 day of November, 1998.

Christine Gossett

EXHIBITOR'S SIGNATURE

CVB #516

by along with PAYMENT to:

McAllen Chamber of Commerce—Travel Show
P.O. BOX 790
McAllen, TX 78505-0790
PH: 956/682-2871 FAX: 956/631-8571

FOR OFFICE USE ONLY

Rcv'd _____ Rspd _____ Asgn _____

Pmt _____ Pmt \$ _____ Pmt # _____

The Monitor-Travel Show
Tabloid Display Advertising
Contract



Company Name: _____

Contact Name: _____

Address: _____

City: _____ ST: _____ Zip: _____

Phone: _____ FAX: _____



Size: _____ Page

Rate: \$ _____

___ Color*: \$ _____

Total Due: \$ _____

All materials must be camera-ready to size *OR* on disk.

**Contract, materials and payment
DUE: December 1, 1998**

Signed: _____ Date: _____

Name: _____ Title: _____

**optional*

Please mail Payment to: McAllen Chamber of Commerce/MITS
P.O. Box 790
McAllen, TX 78505-0790
PH: 956/682-2871 FAX: 956/631-8571

Final Details

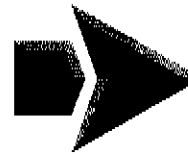

Booth #: 414

Please read all of the enclosed paperwork, it will have the answers to any of the questions you might have. If you still have questions, please call toll free 1-877-MCALLEN (1-877-622-5536).

THINGS TO DO	DEADLINE	DONE
1. Nametag/Booth Sign	12/1/98	<input checked="" type="checkbox"/>
2. Classified Ad Information(included)	12/1/98	<input checked="" type="checkbox"/>
3. Door Prize Registrations	12/1/98	<input checked="" type="checkbox"/>
4. Display Ad Contract & Materials (optional)	12/1/98	<input type="checkbox"/>
5. Make hotel & transportation reservations	12/4/98	<input checked="" type="checkbox"/>
6. Ship materials to FCD (see attached)	12/1/98 12/15/98	<input checked="" type="checkbox"/>
7. Order additional display items from FCD: <i>Carpet, tall tables & chairs, plants, etc.</i>	12/29/98	<input checked="" type="checkbox"/>

Make
cont. #
111 875 74

Show Schedule

Set-up	Tuesday	January 5, 1999	12 noon to 7pm
Set-up	Wednesday	January 6, 1999	8:00 am to 10:00 am
OPEN General Public	Wednesday	January 6, 1999	10:00 am to 5:00 pm
OPEN VIP Reception	Wednesday	January 6, 1999	5:30 pm to 7:00 pm
OPEN General Public	Thursday	January 7, 1999	10:00 am to 5:00 pm
Tear-down	Thursday	January 7, 1999	5:01 pm to 10:00 pm

Don't forget!

Tabloid Display Advertising Opportunity

Increase your visibility by purchasing an advertisement in the official Travel Show tabloid that will be distributed to 55,000 households and to the attendees of the show. A small B/W ad is as low as \$125 or go all out with a full page 4C ad for \$975. Call 1-877-622-5536 for more information. *These rates are 15%-25% OFF the regular Monitor prices!!*

EXHIBITOR SERVICE MANUAL



**F.C.D. EXPO CONVENTION
DECORATOR, INC.**

F.C.D. EXPO CONVENTION DECORATOR INC.
P.O. BOX 4123 McALLEN TX 78502
956-682-0711 FAX 956-686-3021

YOUR FIRM NAME Denton Convention & Visitor Bureau
ADDRESS 414 W. Parkway CITY Denton STATE TX ZIP 76201
TEL# 940/382-7895 FAX# 940/382-6287
CONTACT PERSON Christine Gussett

PAYMENT POLICY

ONE COPY OF RENTAL FORM WITH YOUR CHECK OR CREDIT CARD INFORMATION, MUST BE FORWARDED TO F.C.D. AT THE ABOVE ADDRESS. RETAIN ONE COPY FOR YOUR FILE. FULL PAYMENT OF RENTAL CHARGES MUST ACCOMPANY YOUR ORDER TO QUALIFY FOR THE ADVANCE ORDER PRICE. ALL ORDER RECEIVED AT THE EXHIBITOR SERVICE DESK WILL BE CHARGED AT FLOOR PRICES. USE THE CREDIT CARD AUTHORIZATION BELOW. PURCHASE ORDERS DO NOT QUALIFY FOR THE ADVANCE PRICE.

SHOW SITE ORDERS: SERVICES ORDERED AT THE SHOW SITE WILL NOT BE PROCESSED WITHOUT FULL PAYMENT AT THE TIME THE ORDER IS PLACED.

SHIPPING FREIGHT/LABOR ORDER: MUST BE PREPAID IN ADVANCED

RECAP OF ORDERS

BOOTH FURNISHINGS.....	\$	<u>18.00</u>
SIGNS.....	\$	_____
BOOTH CLEANING.....	\$	_____
SUBTOTAL.....	\$	<u>18.00</u>
TAX 8.25%.....	\$	_____
ESTIMATED DRAYAGE.....	\$	_____
ESTIMATED LABOR.....	\$	_____
		TOTAL AMOUNT DUE \$ <u>18.00</u>

CREDIT CARD CHARGE AUTHORIZATION

IF YOU WISH TO PLACE THIS ORDER ON YOUR CREDIT CARD, PLEASE COMPLETE THE FOLLOWING:

CARD HOLDER NAME(PLEASE PRINT): Christine Gussett - Denton Chamber of Commerce
(Convention & Visitor Bureau)
CARD NUMBER: 3782 697196 81046 AE MASTERCARD VISA
EXP DATE: 10/99

Christine Gussett
SIGNATURE OF AUTHORIZATION

BANK

F.C.D. EXPO CONVENTION DECORATOR INC.

P.O. BOX 4123 McALLEN TX 78502

PH # 956-682-0711 FAX # 956-686-3021

SHIPPING: 1312 E. UPAS McALLEN TX 78501

SHOW NAME: MacAllen Int. ^{Travel Show}	BOOTH # 414-20
FIRM NAME: Denton Convention & Visitor Bureau	
ADDRESS: 414 W. Parkway	
CITY: Denton	STATE: TX, 76201
PHONE: (940) 382-7895	FAX: 940/382-6287
REPRESENTATIVE: Christine Gossett	

DISPLAY TABLES SKIRTED	ADVANCED PRICE	FLOOR PRICE	QTY	EXTENSION
4' LONG 30" HIGH	\$22.00	\$29.00		
6' LONG 30" HIGH	\$27.00	\$34.00	2	
8' LONG 30" HIGH	\$32.00	\$39.00		
TALL TABLES & SKIRTS				
4' LONG 42" HIGH	\$32.00	\$39.00		
6' LONG 42" HIGH	\$37.00	\$44.00		
8' LONG 42" HIGH	\$42.00	\$49.00		
UNDRAPED DIS. TABLES				
4' LONG 30" HIGH	\$12.00	\$17.00		
6' LONG 30" HIGH	\$18.00	\$23.00	1	
8' LONG 30" HIGH	\$24.00	\$29.00		
UNDRAPED TALL TABLES				
4' LONG 42" HIGH	\$19.00	\$24.00		
6' LONG 42" HIGH	\$25.00	\$30.00		
8' LONG 42" HIGH	\$31.00	\$38.00		
TABLE TOP RISERS				
4' LONG 10" HIGH	\$14.00	\$18.00		
6' LONG 10" HIGH	\$22.00	\$26.00		
8' LONG 10" HIGH	\$28.00	\$35.00		
RISERS ARE COVERED WHITE VINYL				
EXTRA DRAPING				
DRAPING INCLUDING STEEL TO COVER ADDITIONAL AREA				
CIRCLE COLOR: RED GREEN GOLD ROYAL BLUE BLACK				
3' HIGH DRAPE PER LN FT	\$4.00	\$6.00		
8' HIGH DRAPE PER LN FT	\$6.00	\$8.00		
STEEL ONLY:				
3' UPRIGHT	\$3.00	\$4.00		
8' UPRIGHT	\$4.00	\$5.00		
12' UPRIGHT	\$10.00	\$12.00		
BASE PLATES	\$5.00	\$6.00		
EXPANDERS	\$5.00	\$6.00		

NOTE: ADVANCED PAYMENT IN FULL IS REQUIRED.
ORDERS RECEIVED WITHOUT FULL PAYMENT WILL
BE INVOICED AT FLOOR PRICE. CUSTOMER ASSUMES
ALL RESPONSIBILITY FOR LOSTED RENTAL ITEMS

CHAIRS	ADVANCED PRICE	FLOOR PRICE	QTY	EXTENSION
ARM CHAIR	\$25.00	\$29.00		
PADDED SIDE CHAIR	\$19.00	\$22.00		
PADDED HIGH STOOL	\$25.00	\$30.00		
CARPET				
CARPET 9' X 10'	\$55.00	\$70.00		
CARPET 9' X 20'	\$90.00	\$110.00		
CARPET 9' X 30'	\$130.00	\$175.00		
<input type="checkbox"/> SILVER <input type="checkbox"/> RED <input type="checkbox"/> BLUE <input type="checkbox"/> HUNTER GREEN				
CARPET INSTALLED FRONT EDGE TAPED				
CARPET PADDING				
PADDING 9' X 10'	\$20.00	\$25.00		
PADDING 9' X 20'	\$40.00	\$45.00		
ADDITIONAL SIDES OF CARPET TAPED				
CARPET TAPING / LINEAL FT \$5.00				
RIGHTSIDE <input type="checkbox"/> LEFTSIDE <input type="checkbox"/> REAR <input type="checkbox"/>				
MISCELLANEOUS				
WASTEBASKET	\$5.00	\$6.00		
EASEL FLOOR	\$10.00	\$12.00		
COFFEE TABLE 30"X17"	\$25.00	\$30.00		
PEGBOARD METAL FRAME				
4' X 8' PEGBOARD	\$50.00	\$60.00		
<input type="checkbox"/> HORIZONTAL <input type="checkbox"/> VERTICLE				
SHELVE UNIT METAL FRAME				
3-SHELVES 4' X 8' X 12"	\$50.00	\$60.00		
TOTAL LEFT COLUMN		\$18.00		
TOTAL RIGHT COLUMN		0		
SUBTOTAL				
SALES TAX 8.25%		non-tax entity		
TOTAL \$		\$18.00		
PAYING BY CREDIT CARD				
PLEASE FILL OUT CREDIT CARD APPROVAL FORM ON RECAP SHEET				



F.C.D.
Expo
Convention Decorator
Inc.

P.O. Box 4123
McAllen, TX 78502

TEL: (956) 682-0711
FAX: (956) 686-3021

McAllen Int'l. Travel Show

BOOTH NUMBER

414

FIRM NAME Denton Convention & Visitor Bureau
ADDRESS 414 W. Parkway
CITY Denton STATE TX ZIP 76201
TELEPHONE 940/302-7895 EXTENSION _____
REPRESENTATIVE
IN CHARGE Christine Gossett

FREIGHT ORDER FORM

DRAYAGE RATES:

ADVANCE SHIPMENTS - Shipments of common freight and crated exhibits will be received (Minimum 200 lbs. per shipment) and stored up to 30 days prior to set up date, delivered to booth, and at close of show, delivered from booth to common carrier at loading dock of exhibit area. This also includes removal, storage, and return of empty crates or containers, when necessary.

PER CWT (100 lbs)

ADVANCED (01)

\$35

PER CWT

DIRECT SHIPMENTS - (During setup hours only) We will receive shipments of common freight and crated exhibits from outside carrier or owner's vehicle at the Exhibit Hall. Unloading, delivery to booth, and at close of the show, delivery from booth to common carrier at loading dock. This also includes removal, storage, and return of empty crates or containers, when necessary.

DIRECT (02)

\$35

PER CWT

- Shipments containing uncrated, unskidded, loose, or padded display items will be assessed an additional 25% of quoted rate.
- Shipments arriving and/or departing prior to 8:00 a.m. and after 4:30 p.m. weekdays, Saturdays, Sundays and holidays will be assessed an additional 25% of quoted rate.
- Shipments requiring special handling due to arrival time, size, or type of equipment will be assessed an additional 25% of quoted rate.
- Shipments must have bill-of-lading or delivery receipts showing number of pieces, certified weight, and description of materials.

SHIPPING ADDRESS:

F.C.D. EXPO CONVENTION DECORATOR INC.
1312 E. UPAS
McALLEN TX 78501

BILLING ADDRESS:

F.C.D. Expo Convention Decorator, Inc.
P. O. Box 4123
McAllen, TX 78502-4123

LIABILITY:

- FCD will not be responsible for damage to uncrated, unskidded, and concealed damage to materials for any reason.
- FCD will not be responsible for loss or theft of materials after deliver to booth or before pick-up for loading out at show termination.
- Exhibitor routings on outbound shipments will be honored when possible. In the event the designated carrier fails to pick up by the specified time, such shipments will be re-routed by FCD.
- FCD is not responsible for shipments left in booth by exhibitor. We will count and ship pieces as we find shipment when we remove from exhibit hall.
- Make certain all of your materials are properly insured against fire, theft, and all hazards while in transit and to and from your booth and for the duration of the exhibition. This may be done with "riders" to existing insurance

TOTAL \$ _____

PAYMENT DUE \$ _____

SERVICE DESK:

FIESTA CONVENTION DECORATOR, INC. will have a service desk located in a convenient location should you require further assistance at set up and dismantle times.

SERVICE FORMS:

Included in this service kit are order forms for various services you may require for your exhibit, along with our charges for these services. The forms are to be returned to the address on the order form. Please note on the enclosed cover sheet that various items are being provided for each booth space by Show Management. When ordering, please order only those items you will require above and beyond those being provided. Please analyze your needs carefully and return your order form two weeks prior to the show. Avoid premium rates for late orders, **ADVANCED ORDERS MUST BE ACCOMPANIED BY PAYMENT.**

QUESTIONS AND ADJUSTMENTS:

Any discrepancy in items ordered and items received or any complaint or question concerning service, etc. must be reported to Fiesta Convention Decorator Service Desk immediately upon noting the same. Your problems will be resolved and/or any valid adjustment will be made at that time, and approved by Fiesta Convention Decorator Supervisor in charge. Credits and adjustments will not be made on such information received after the show.

PAYMENT POLICY:

To qualify for discount prices, full payment must be included with your orders and must be received at least two weeks prior to show opening. Orders without payment will not be processed.

All orders, including labor and material handling, must be paid before close of show. For your convenience, we will accept Visa, MasterCard and American Express, as well as, travelers checks, company checks and cash. A credit card authorization form is enclosed. Advanced payment for drayage should be based on estimated weight and advance payment for labor should be based on estimated installation and dismantle of labor.

If you wish to charge the amount of your order to your credit card account, please complete the following information requested and return this with your order. This form authorizes Fiesta Convention Decorator, Inc. to charge your account in reference to expenses incurred at show.

SEE ATTACHED FORMS

F.C.D. EXPO CONVENTION DECORATOR INC.



P.O. BOX 4123 ♦ McALLEN TX 78502
Phone 956-682-0711 ♦ Fax 956-686-3021

EVENT NAME: McALLEN INTERNATIONAL TRAVEL SHOW

EVENT PLACE: McALLEN CONVENTION CENTER DATE: JANUARY 6, 7, 1999

DEAR EXHIBITOR:

WE TAKE GREAT PLEASURE IN ADVISING YOU THAT WE HAVE BEEN DESIGNATED AS THE OFFICIAL SERVICE CONTRACTOR FOR THE FORTHCOMING SHOW. IT IS EXTREMELY IMPORTANT YOU REFER TO THE ENCLOSED ORDER FORMS SO THAT WE MAY MEET YOUR NEEDS. PLEASE READ INFORMATION CONTAINED IN THE EXHIBITOR SERVICE KIT.

TO RECEIVE THE DISCOUNT PRICE, ORDERS MUST BE PAID IN FULL TWO WEEKS PRIOR TO EVENT. PLEASE ADD THE APPROPRIATE SALES TAX (8.25%) TO YOUR ORDER. TO BE TAX EXEMPT YOU MUST BE A GOVERNMENT OR NON PROFIT ORGANIZATION. A RESALE CERTIFICATE IS NOT ACCEPTABLE AS WE ARE NOT PROVIDING SERVICES TO BE RESOLD.

PLEASE INCLUDE SHOW OR EVENT NAME ON ALL RETURN PAPER WORK.

BOOTH INFORMATION

BOOTH: THIS IS BASED ON A SINGLE , BOOTH IF YOU HAVE A LARGER BOOTH ADD EQUIPMENT ACCORDINGLY PER BOOTH.

EACH BOOTH IS PROVIDED WITH 8' TALL BACK DROP DRAPE AND 3' TALL SIDE CURTAIN, ONE 7" X 44" ONE LINE COMPANY NAME SIGN, ONE 6FT SKIRTED TABLE , TWO FOLDING CHAIRS

THE BOOTH COLOR WILL BE ROYAL BLUE AND WHITE

PLEASE DO NOT SEND FREIGHT TO CONVENTION HALL AS THEY HAVE NO STORAGE AREA. THE CONVENTION SITE WILL NOT ALLOW FREIGHT TO BE DELIVERED BEFORE THE DAY YOU AS AN EXHIBITOR MOVE IN.

IF YOU ARE NEEDING TO SHIP EARLY, PLEASE SEE FREIGHT FORMS. PLEASE REMEMBER THIS A HOLIDAY SEASON WE WILL BE CLOSED FROM DECEMBER 19 THROUGH 27, 1998

IF YOU NEED NO RENTAL SERVICE FROM US, PLEASE DISREGARD ALL OF THOSE FORMS.

F.C.D. EXPO CONVENTION DECORATOR INC.



P.O. BOX 4123 McALLEN TX 78502
PHONE: 956-682-0711 FAX: 956-686-3021

CLEANING ORDER FORM:

VACUUMING SWEEPING OF BOOTH, EMPTYING OF WASTEBASKET, ASHTRAYS OR SMOKE STANDS IS NOT INCLUDED IN YOUR BOOTH SPACE RENTAL. IF YOU REQUIRE THESE SERVICES YOU NEED TO ORDER THEM.

BOOTH CLEANING: ALL RATES ARE BASED ON 10'X10' BOOTH SPACE

_____ @\$ 6.00 VACUUMING BOOTH ONCE ONLY PRIOR TO SHOW OPENING

_____ @\$ 6.00 DAILY VACUUMING INCLUDING EMPTYING WASTEBASKET
ASHTRAYS AND SMOKE STANDS

_____ PLEASE SPECIFY NUMBER OF DAYS NEEDING SERVICE

**NOTE: ALL RENTAL CARPET ARE DELIVERED CLEAN TO BOOTH SPACE.
HOWEVER DURING SET UP THE CARPET CAN BECOME SOILED. WE SUGGEST
THAT YOU ORDER CLEANING SERVICE AT LEAST ONCE PRIOR TO SHOW
OPENING.**

SUBTOTAL: _____

8.25% TAX: _____

TOTAL: _____

COMPANY NAME: _____

BOOTH NUMBER: _____

AUTHORIZED BY: _____



BOOTH NUMBER _____

 FIRM NAME _____
 ADDRESS _____
 CITY _____ STATE _____ ZIP _____
 TELEPHONE _____ EXTENSION _____
 REPRESENTATIVE _____
 IN CHARGE _____

DISPLAY LABOR ORDER FORM

RATES:

Straight Time	Monday - Friday	8:00 a.m. - 6:30 p.m.	\$30.00
	Saturday & Sunday	6:30 p.m. - 12:00 p.m.	\$45.00
			Per Hour

All work performed without direct exhibitor supervision will receive a 25% supervision charge
 MINIMUM CHARGE: ONE (1) HOUR PER MAN

TYPE OF SERVICE:

"Proceed" FCD Supervision
 FCD will proceed with your display setup unless you instruct us otherwise. Work will be done on straight time, unless move-in schedule does not permit. Our charge for this service is 25% of the total Labor Bill with a \$25.00 minimum.

Please complete information at right:

<input type="checkbox"/> Labor to Install (01,05,06)	Number of Crates _____	Self Contained Unit _____
	Setup plans attached _____	Photo Enclosed _____
<input type="checkbox"/> Labor to Dismantle (03,07,08)	Setup Plans in Crate _____	Special Instructions _____
	Carpet: FCD _____ OWN _____ Color _____	

"Do Not Proceed" Exhibitor will supervise
 All work to be performed ONLY under Supervision of Exhibitor Representative:
 Representative's Name: _____
 Exhibitor will check in at service desk to pick up men.

SCHEDULES:

INSTALLATION (01,02)				DISMANTLE (03,04)			
Number of Men	Date	Start Time	Number of Hours	Number of Men	Date	Start Time	Number of Hours

Authorized Signature _____ Printed Name _____ Title _____

Representative will call for labor at service desk.

- Labor ordered and not called for by the exhibitor will be billed at one (1) hour no-show charge per man.
- Work start time can only be guaranteed in those cases when men are requested for the start of the workday; 8:00 a.m.

PLEASE COMPLETE ALL OUTBOUND DOCUMENTS AT THE
 SERVICE DESK PRIOR TO SHOW CLOSE.

TOTAL _____

PAYMENT DUE

\$ _____

F.C.D.

Expo
Convention Decorator
Inc.

PO. Box 4123
 McAllen, TX 78502

TEL: (956) 682-0711
 FAX: (956) 686-3021

BOOTH NUMBER _____

FIRM NAME _____
 ADDRESS _____
 CITY _____ STATE _____ ZIP _____
 TELEPHONE _____ EXTENSION _____
 REPRESENTATIVE _____
 IN CHARGE _____

SIGNAGE ORDER FORM

SIGNAGE RATES

QUANTITY	SIZE	DISCOUNT		STANDARD	EXTENSION	QUANTITY	SIZE	DISCOUNT		STANDARD	EXTENSION
		RATE	RATE					RATE	RATE		
_____	7"x11"	\$11.00	\$14.00	_____	_____	_____	28"x44"	\$34.00	\$40.00	_____	_____
_____	11"x14"	\$16.50	\$22.50	_____	_____	_____	40"x60"	\$65.00	\$85.00	_____	_____
_____	9"x44"	\$18.75	\$22.75	_____	_____	_____	Additional Words	\$1.10 per word		_____	_____
_____	14"x22"	\$22.50	\$28.00	_____	_____	_____	Easel Back	\$3.00		_____	_____
_____	22"x28"	\$32.50	\$40.00	_____	_____	_____				_____	_____

Prices are based on white showcard with black, red, blue, or burgundy lettering. Prices include eight (8) words. Foamcore, Corex, and other sign materials are available as well as special showcard colors and lettering. Logo work, special designs, & cut out letters: Please call for price quotations.

BANNER RATES:

_____ Sign, Cloth Banner with Grommets, unframed, white background*	\$8.00 per sq. ft.	\$10.00 per sq. ft.
_____ Sign, Indoor Musline or Paper Banner, white background*	\$6.00 per sq. ft.	\$8.00 per sq. ft.
_____ Foamcore signs* - \$7.00 per sq. ft.		
_____ All Banners - \$75.00 minimum order. * Colored backgrounds, 20% additional		
_____ Wood Framed Backing on Signs - Additional 50¢ per sq. ft.		

COPY:

_____ Letter Color
 _____ Showcard Color

_____ "



_____ "

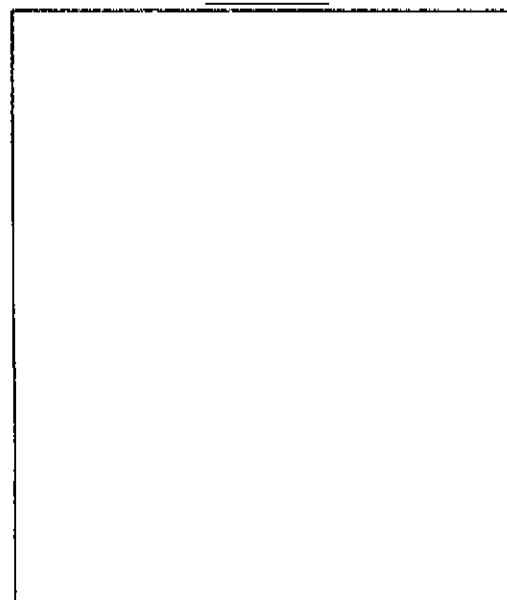

TOTAL \$ _____
 TAX 8.25% \$ _____
 PAYMENT DUE \$ _____

**TO RECEIVE ADVANCED PRICES,
 ORDERS MUST BE RECEIVED 2 WEEKS
 PRIOR TO SHOW DATE WITH FULL PAYMENT.**

 AUTHORIZED SIGNATURE

Please return to:
Micro Solutions Inc.
 1311 East Hackberry
 McAllen, Texas 78501
 Phone (956)682-1819
 Fax (956)682-8560

Audio Visual
 Computer Equipment
 Advanced Orders
At least 10 days
 prior to show date

VIDEO EQUIPMENT	Qty.	Advance	On-site
1/2" Video Cassette Player w/ auto repeat	___	\$60.00	\$75.00
3/4" Video Cassette Player w/ memory & auto repeat	___	\$75.00	\$87.50
20" Monitor / Receiver	___	\$60.00	\$75.00
26" Monitor / Receiver	___	\$85.00	\$97.50
35" Monitor / Receiver	___	\$195.00	\$215.00
46" Projection TV	___	\$300.00	\$325.00
20" Monitor / VCR Combo	___	\$125.00	\$145.00
Video Equipment Stand	___	\$20.00	\$30.00
VHS Camcorder	___	\$100.00	\$120.00
Laser Disc Player	___	\$75.00	\$87.50

COMPUTER SETUP	Qty.	Advance	On-site
Internet Setup	___	\$65.00	\$75.00
33.6 Modem Installed	___	\$45.00	\$55.00
Pentium II 300Mhz PC	___	\$185.00	\$205.00
Pentium II 233Mhz PC	___	\$155.00	\$175.00
Pentium 200Mhz PC	___	\$100.00	\$115.00
Pentium 100Mhz PC	___	\$65.00	\$75.00
20" VGA Monitor	___	\$200.00	\$225.00
26" VGA Color Monitor	___	\$250.00	\$275.00
30" VGA Color Monitor	___	\$300.00	\$325.00
35" VGA Color Monitor	___	\$350.00	\$375.00
PC Interface & Cable (6")	___	\$50.00	\$60.00
Color LCD Panel w/Hi Ovrhd	___	\$325.00	\$350.00

SOUND EQUIPMENT	Qty.	Advance	On-site
Cassette Tape recorder/player	___	\$20.00	\$30.00
CD Player	___	\$35.00	\$45.00
Earphones or Headphones (4)	___	\$15.00	\$25.00
Microphone	___	\$20.00	\$30.00
Large Sound System Package	___	\$100.00	\$120.00
Lg. Power Speaker each	___	\$35.00	\$45.00
Wireless Microphone	___	\$100.00	\$125.00
Headset Microphone (hdwire)	___	\$25.00	\$30.00

SPECIAL NEEDS

This order form displays only a handful of items in our inventory. Please call Micro Solutions if what you need is not listed, and we will do our best to fulfill your needs. Networking available.

RENTAL AGREEMENT

It is understood and agreed the customer is RENTING Micro Solutions equipment for a specified period of time (1 day priced as above) and is responsible for its safe return. Customer agrees to be billed for any damages or losses of the equipment caused other than normal operation. Orders after the deadline are subject to availability. Cancellation of equipment ordered must be received one week prior to delivery date to avoid the minimum one day charge.

TOTAL COST CALCULATION

Equipment Subtotal X _____ days	\$ _____
Handling Charge (taxable)	\$ 36.00
Local Tax 8.25%	\$ _____
Total	\$ _____

Electrical & Lighting Order Form
Rockhill Productions
P.O. Box 4123 McAllen, Texas 78502
Ph # (956)664-0202 Fax # (956)686-3021

All order forms must be received by us with payment in full within 7 days of show set up date to receive the preshow price. Preshow order payments must be paid with check or money order.
****NOTE** All 240 volt electricity service is SINGLE PHASE. Three phase electricity is not available.**

ELECTRICAL SERVICE				
120 Volt	Qty.	Preshow	Show	Total
1500 Watts (15 amps)-----	_____	\$37.50	\$47.50	\$ _____
2000 Watts (20 amps)-----	_____	\$47.50	\$57.50	\$ _____
3000 Watts (30 amps)-----	_____	\$57.50	\$67.50	\$ _____
1. Subtotal---\$				
120 volt / 1500 watt is set with a duplex edison service outlet. All other 120 volt is set with single end outlet or with tie in.				
240 Volt (Single Phase Only)	Qty.	Preshow	Show	Total
3000 Watts (15 amps)----- Straight Blade---Twist Lock---Tie In	_____	\$47.50	\$57.50	\$ _____
4000 Watts (20 amps)----- Straight Blade---Twist Lock---Tie In	_____	\$57.50	\$67.50	\$ _____
6000 Watts (30 amps)----- Straight Blade---Twist Lock---Tie In	_____	\$67.50	\$77.50	\$ _____
10000 Watts (50 amps)----- Straight Blade---Twist Lock---Tie In	_____	\$87.50	\$97.50	\$ _____
<i>Please circle above :</i> Straight blade, Twistlock or Tie In				
2. Subtotal---\$				

Booth Lighting----- Installed in your booth			
	Preshow	Show	Total
Two 100 watt lights-----	\$15.00	\$20.00	\$ _____
Four 100 watt lights-----	\$25.00	\$30.00	\$ _____
Six 100 watt lights-----	\$35.00	\$40.00	\$ _____
3. Subtotal---\$			

Compressed Air--- \$80.00 per day X _____ DAYS (0 - 120 psi) Be sure number of days to include set up day if desired.	4. Subtotal---\$
--	-------------------------

Total of all four subtotals---\$ _____

Make checks payable to:

Rockhill Productions

Show Date : _____

Show Name : _____

Company : _____

Booth # : _____

Contact Name : _____

All equipment used in these services is the property of Rockhill Productions and will be picked up at the end of the show.

All preshow orders are installed prior to your arrival and cannot be refunded. It is important to notify us of any changes in your order prior to set up. We will be unable to provide new service hookups the day of the show opening.

Unauthorized use of electricity or sharing of electricity, lighting or compressed air with another booth is NOT PERMITTED & WILL BE DISCONNECTED.

Using existing house electrical outlets is not allowed as all electrical has been re-routed for the trade show

ALL PAYMENTS MUST BE PAID IN FULL PRIOR TO OPENING OF SHOW TIME. FAILURE TO DO SO MAY RESULT IN REMOVAL OF ORDERED SERVICE.

FAX



Date: 12/1/98
Number of pages 7
(including cover sheet)

TO: Shawn

FROM: Christine Asselt
Denton Convention &
Visitor Bureau

PHONE:
FAX #: 956/631-8571

PHONE: 940/382-7895
FAX #: 940/382-0040

Papers for the MITS.

h:rfax



Travel Show TAB

Classified AD



Your Travel Show booth registration(s) entitle your company/organization to **ONE** 1 column* x 1 inch classified AD **PER** booth purchased. If you purchased more than one booth your AD space increases by 1 inch down the column.

You may use this space any way you wish. Include your logo, design an ad to fit the space, or just send back this form and we will layout your classified ad for you. For example:

McAllen, TX Visit the "Texas Tropics" and experience south Texas hospitality. Mexico is just 10 minutes away, best bird watching in the US, lots to see & do. Call for a visitor guide. Toll Free 1-877-MCALLEN

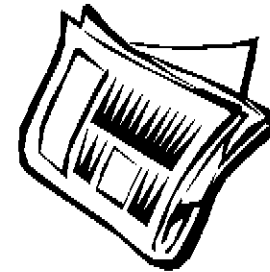

Company: Denton Convention & Visitor Bureau Booth #: 414

** See attached*

(Use the space above or attach a separate sheet)

DUE BY: December 1st

FAX to 956/631-8571

OR

Mail to:

McAllen Chamber of Commerce/MITS

P.O. Box 790

McAllen, TX 78505-0790

956/682-2871 or 877-622-5536

* 1 column = 2 inches

Classified ad copy for McAllen Travel Show

Denton, TX Visit our historic downtown square with its century old courthouse and unique galleries, museums, shops, antique stores and restaurants. Cultural events. Lakeside recreation and camping. Denton has it all! Call for visitor information. Toll free 1-888-381-1818. Or visit our website at www.denton-chamber.org.

Ad for Denton CVB , Booth # 414

Name Tags & Booth ID Sign

Company: Denton Convention & Visitor Bureau

Booth #: 414

Booth ID Sign to read EXACTLY as follows:

Name Tags:

First & Last Name	Company/Organization
Christine Gossett	Denton Convention & Visitor Bureau

Fax to: 956/631-8571

OR

Mail to: McAllen Chamber of Commerce/MITS
P.O. Box 790
McAllen, TX 78505-0790
956/682-2871 or 877-622-5536

Due December 1, 1998

VIP Door Prize Registration

Exhibitors will distribute door prizes for the VIP's to the individual winners during the VIP Party on Wednesday. Guests will draw a ticket that will have the booth number of the donating vendor and will proceed to that booth to collect their prize. VIP's are not eligible until they have visited 35 vendor booths. A listing of all door prizes will be handed out to the attendees as they enter the reception.

Company: Denton Convention & Visitor Bureau Booth #: 414

Qty.	Description of Item Donated	Value
1	Golf Package for two (see attached)	\$ 200
		\$
		\$
		\$
		\$
		\$
		\$
		\$
		\$
		\$
		\$
		\$
		\$
		\$
		\$

FAX to 956/631-8571 OR Mail to: McAllen Chamber of Commerce/MITS
P.O. Box 790
McAllen, TX 78505-0790
956/682-2871 or 877-622-5536

Due December 1, 1998

#10

September 14, 1998

Bearer

A golf package for two (to include overnight accommodations, green fees, cart rental, range balls, and club storage) at the Radisson Hotel Denton and Eagle Point Golf Club. Also included, breakfast buffet for two to be served in Carmen's Restaurant. Call for advanced reservations and tee times.

The Chili Society

9/14/98

Denton CVB Booth #414
VIP Door Prize Drawing

General Public Door Prize Registration

Please complete this form and return it if you plan to give away door prizes to the General Public. A listing of all door prizes will be printed in the Monitor Tab, only those registrations received by the deadline will be included in the insert. Attendees will be registering for door prizes as they enter the show or you can register people at your booth if you want. Do not award prizes or ask for winners to be announced during the show. All General Public door prizes will be distributed after the show by show management.

Company: Denton ~~Area~~ Convention & Visitor Bureau Booth #: 414

Qty.	Description of Item Donated	Value
1	Denton Umbrella	\$ 10
		\$
		\$
		\$
		\$
		\$
		\$
		\$
		\$
		\$

- We will register people at our booth and turn in the winner's names.
 We will not register people at our booth.

FAX to 956/631-8571 OR Mail to: McAllen Chamber of Commerce/MITS
P.O. Box 790
McAllen, TX 78505-0790
956/682-2871 or 877-622-5536

Due December 1, 1998