

P400.6
 7268
 96/07-09

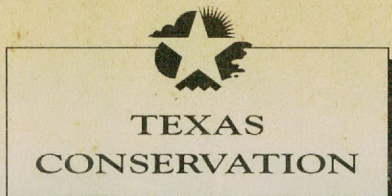

PASSPORT

Vol. 5 No. 3 • July 1996 - Sept. 1996

JOURNAL

Government Publications
 Texas State Documents

SEP 17 1996

Depository
 Dallas Public Library

NEW LOOK COMING!

Your *Texas Conservation Passport Journal* looks and feels different - why? Because we are under construction!

A revised format for the *Passport Journal* will be introduced with the next issue. The new look will complement the other new services that have been phased in since last December.

We started by introducing the Texas Outdoor Connection, a statewide electronic purchasing system that lets you buy your Conservation Passport in nearly 3000 retail outlets as well as in state parks (at some locations you can buy with a credit card).

In May we expanded your membership options by introducing the new Gold and Silver, two-level, membership program (see page 8 for benefits).

And in September, we will introduce the new image for the *Passport Journal*. You will still get advance notice of park events and activities but we will expand our coverage of events at wildlife management areas and will keep you up-to-date on the exciting new technology of fish hatcheries. Look for it in your mailbox this September!

NONGAME AND URBAN PROGRAM
WILDSCAPING

Wildscaping means inviting critters to fly, crawl or hop on over to your yard for a lovely stay or a quick bite to eat. Hummingbirds and butterflies may simply pass through to take advantage of nectar sources like clematis vine, lantana, mistflower, scarlet sage or verbena. Or, you can attract mosquito-eating birds and bats as permanent residents by putting up a bird or bat house.

A wildscaped yard is a small habitat area that provides places for birds, toads, frogs and small mammals to feed and drink, escape from predators and raise their young. It can be as simple as providing feeders, birdbaths, and nest boxes for birds, or as elaborate as creating rock-lined ponds and restoring native vegetation.

Texas Wildscapes suit residential yards, business and office properties, parks, apartment complexes and even ranches and farms.

EXAMPLE OF A WILDSCAPE PLAN

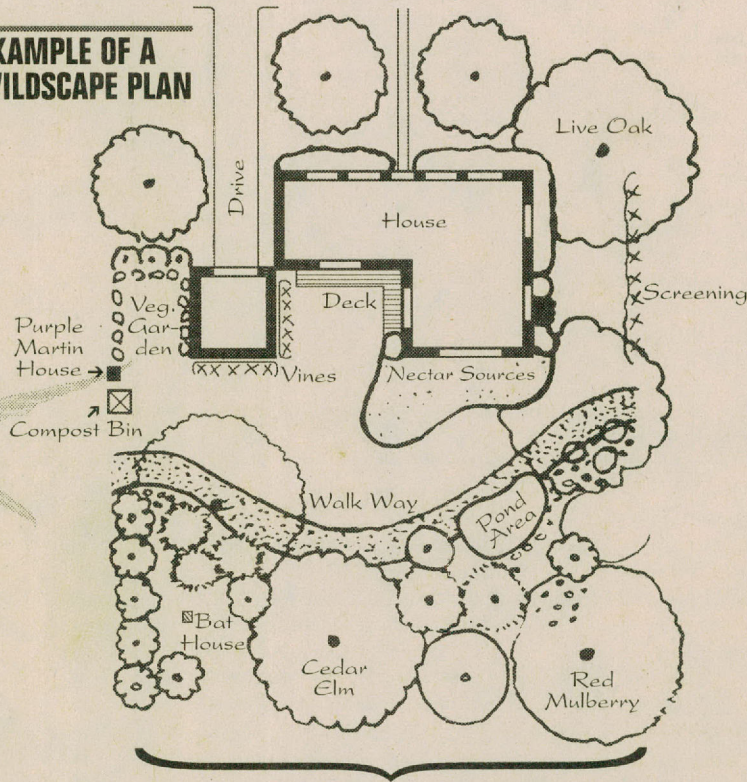

- Shade Trees**
 Live Oak
 Red Mulberry
 Cedar Elm

- Nectar sources:**
 Clematis Vine
 Lantana
 Mistflower
 Scarlet Sage
 Verbena

- Wildlife Area:**
 American Beautyberry
 Cherry Laurel
 Mexican Plum
 Persimmon

- Vines and Screening:**
 Coral Honeysuckle
 Dwarf Wax Myrtle
 Passion Flower Vine

- Pond Area:**
 Buttonbush
 Cardinal Flower
 Horsetail
 Louisiana Iris
 Swamp Lily

TEXAS PARKS AND WILDLIFE

Passport Benefits ...page 8
 Events 2-5, 8
 Drive Across Texas 6-7

For more information, contact the Wildscapes Coordinator at 1-800-792-1112.

EXPLORE THE REAL TEXASSM

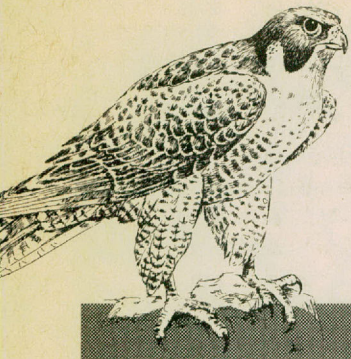

BIRDS

GULF COAST

Fennessey Ranch Bird & Wildlife Tours - Sept., every Thursday & Saturday morning. Guided wildlife tours on privately-owned historic Fennessey Ranch, established in 1834. A rare opportunity for birders and naturalists to view some of the 400-plus species of birds and wildlife who visit the ranch. 8 a.m., fee \$12.50 per person, reservations required, Fennessey Ranch Tours, 512-529-6600.

Hummingbird Hayrides - Sept., mornings and late afternoons. Observe hundreds of hummingbirds feeding on wild turks cap and roosting by the Mission River. 8 a.m., fee \$15 per person, reservations required, Fennessey Ranch Tours, 512-529-6600.

PINEYWOODS

Daingerfield SP Silent Hunters - Aug. 31. Slide presentation on owls, followed by a predator-calling demonstration. Starts 8 p.m., fee TCP members free; general \$1 adults, \$.50 children 12 and under, reservations available but not required, 903-884-3833.

Lake Bob Sandlin SP Birds at Your Feeder - Aug. 17. Birds you might see in your backyard. Starts 8 p.m., fee TCP members free; general \$1 adults, \$.50 children 12 and under, reservations available but not required, 903-884-3833.

Tyler SP Hunters of the Night - Aug. 3. Excellent presentation on owls. Starts 8 p.m., fee TCP members free; general \$1 adults, \$.50 children 12 and under, reservations available but not required, 903-884-3833.

PRAIRIES AND LAKES

Dinosaur Valley SP Wild Bird Rehabilitation - July 13; Aug. 10; Sept. 14. Learn how injured birds are rehabilitated and released, includes slide show and live birds that have been rehabilitated. Presented by L. Clauser with Wild Bird Rehabilitation, Inc. 2-3 p.m., 817-897-4588.

SOUTH TEXAS PLAINS

Chaparral WMA Birds Of The Brush Country - Aug. 9, 10, 11. Participants will be allowed to assist with mist netting and bird banding activities from 6:00 a.m. to 10:00 a.m. each morning. Area nature trails will be open from noon Aug. 9 to noon Aug. 11, reservations required, 210-676-3413.

Choke Canyon SP/Calliham Unit Birding - Aug. 24. Guided tour of the bird trail. TCP required. 9 a.m.-noon, fee \$5 per person, reservations required, 512-786-3868.

BATS

HILL COUNTRY

Old Tunnel WMA Bat Emergence Tour - July, Aug. & Sept., every Thursday & Saturday. Observation of bat emergence, with interpretation by park naturalist. TCP required. Limited seating for non-TCP members. Bring a flashlight. Flash photography will be permitted for two minutes during the emergence. One hour before sunset, fee TCP members free; general \$5, \$2 children 16 & under, reservations required, contact Blanco SP, 210-833-4333.

PANHANDLE PLAINS

Caprock Canyons Trailway SP Evening Bat Flight - Sept., every Saturday. Open air ride along Trailway to Clarity Tunnel. Bat flight after sunset. Call for time, fee TCP members \$5; general \$7, \$3 children 12 and under, reservations available but not required, 806-455-1492.

ARTS & CRAFTS

HILL COUNTRY

Landmark Inn SHP Soap Making - July 18-19. Participants are to bring two glass corning ware casserole dishes to serve as molds and two stainless steel or glass bowls. Choose from several 19th century formulas like honey, rosemary, and Castile. This is a two day workshop. 1-5 p.m. July 18, 9 a.m.-noon July 19, fee \$30 TCP members, general \$40, deposit and application due by the first day of class, reservations required and can be made by calling the park at 210-931-2133, reservations to stay at Landmark Inn may be made by calling 512-389-8900.

Grandma's Lost Art - Aug. 3-4. Two day workshop teaching the once-popular art of tatting. The first day will be a brief introduction on the history of tatting along with learning the basic knots. Second day a review, explanation of principles of the patterns, and continuation of hands-on learning. 1-5 p.m. Aug. 3, 9 a.m.-noon Aug. 4, fee \$25 TCP members, general \$30, plus \$15 for tatting kit and instruction book, deposit and application due by July 29, instructor W. Moses teaches tatting at the University of Texas, reservations required and can be made by calling the park at 210-931-2133, reservations to stay at Landmark Inn may be made by calling 512-389-8900.

PRAIRIES AND LAKES

Eisenhower SP Nature Crafts - Aug. 3, 10, 17, 24. Create a craft project that will attract nature to your backyard or just looks pretty, using materials from nature. 3-4 p.m., based on craft, reservations required, 903-465-1956.

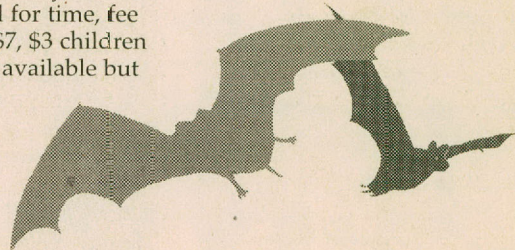

SPLISH - SPLASH

HILL COUNTRY

Guadalupe River SP The World of Aquatic Ecology - July 20. The river will come alive! Seine for aquatic organisms and observe them through microscopes. There will be a river habitat presentation by aquatic ecologist B. Moring. 1-3:30 p.m., fee TCP members \$3; general \$5, 210-438-3343.

Honey Creek SNA Aquatics - July 13. Hike to Honey Creek and learn about water resources and its relationship with fish and aquatic insects. A great wet activity! 9-11 a.m., fee \$2 per person, \$5 per family, 210-438-2656.

PRAIRIES AND LAKES

Fairfield Lake SP Boat Tour - July & Aug., every Saturday. Two hour boat tour of the lake and its unique natural resources. 10 a.m.-noon, fee TCP members \$10; general \$15 adults, \$10 children 16 and under, reservations required, 903-389-4514.

Inks Lake SP Devils Waterhole Canoe Tour - Explore the geological and natural features with an emphasis on local birds. 4-6:30 p.m., fee TCP members \$3; general \$5 adults, \$3 seniors and children 12 and under, reservations required, guides P. Kisel and J. Holland, 512-793-2223.

SOUTH TEXAS PLAINS

Choke Canyon SP/Calliham Unit Fishing Clinic - Aug. 17. Children 6-12 years old will be shown how to rig their poles and fish. Poles and bait will be provided. 9 a.m.-noon, reservations required, 512-786-3868.

COWBOY TRADITIONS

PRAIRIES AND LAKES

Cleburne SP Cowboy Music Concert - Aug. 10; Sept. 7. Relax under the stars and learn about the cowboy lifestyle through the music and poetry of the Old West, performed by cowboy singer Steve Schick. Bring a lawn chair. Dates subject to change-call ahead to confirm. 8-10 p.m., July and August free, Sept. fee \$3 adults, \$1 children 6-12, 817-645-4215.

Cowboy Campfire & Poetry - Sept. 7. Enjoy a peaceful evening of cowboy poetry around a campfire. Learn and experience the cow camp lifestyle through cowboy characters as portrayed by David Kester. Bring a lawn chair. 8:30-10 p.m., 817-645-4215.

HAPPY TRAILS

PANHANDLE PLAINS

Caprock Canyons SP Canyon Ramblings - July 20; Aug. 17. Travel the back trails of Caprock Canyons with a ranger in an open air vehicle for a view of wildlife, beautiful scenery and a rough and rumbling ride. 5:30-7:30 p.m., fee TCP members \$5; general \$7 adults, \$3 children 12 and under, reservations required, 806-455-1492.

Caprock Canyons Trailway SP Harvest Moon Mountain Bike Ride -Sept. 28. Ride the Trailway under the full moon. Annual DORBA-sanctioned mountain bike ride. Helmet and headlight required. Call for time, reservations available but not required, 806-455-1492.

PRAIRIES AND LAKES

Lake Somerville SP/Nails Creek Unit Tour de Somerville - Aug. 24. Night bicycle ride on the scenic 14 mile trailway. 6 p.m.-midnight, fee \$30, reservations required, 408-289-2392 or 409-542-0964.



STARGAZING

PINEYWOODS

Caddo Lake SP & WMA Stargazing Party - Sept. 7. Bring a flashlight and binoculars to a stellar occasion. View planets and constellations aided with telescopes from the Ft. Worth Sidewalk Astronomers. Starts 9 p.m., reservations available but not required, 903-884-3833.

PRAIRIES AND LAKES

Cleburne SP "Star Gazing" Beginning Astronomy - July 20. Become familiarized with constellations of the season as well as specific stars and objects of interest. A few telescopes will be provided; you are encouraged to bring your own telescope or binoculars and blanket or chair. 8:30-10 p.m., 817-645-4215.

Dinosaur Valley SP Sidewalk Astronomy - Aug. 10. Slide presentation and stargazing with telescopes. Starts at dusk, 817-897-4588.



For information on purchasing a Texas Conservation Passport call 1-800-792-1112 8 a.m.-5 p.m.

Monday - Friday

or

you can call

1-800-895-4248

to purchase your Passport with a credit card.

Know before you go!

Texas Conservation Passports are for adults, age 17 and older. Children and young adults do not need to have a Conservation Passport and are not eligible for Passport discounts.

- See Drive Across Texas, Page 6-7, for directions to activities.
- Some of these activities require one Conservation Passport per person age 17 and over.
- Some activities require **reservations**.
- Most activities have a **limit on group size**.
- For **reservations** and information, call the phone number listed with the activity.
- For WMAs, the best time to catch the biologist in the office is on a weekday 8 to 9 a.m. and 12 to 1 p.m.
- Call WMAs before going to visit to make sure you can have access.
- Abbreviations:

SP = State Park

SFH = State Fish Hatchery

SHP = State Historical Park

SNA = State Natural Area

WMA = Wildlife Management Area

TCP = Texas Conservation Passport

TPWD = Texas Parks & Wildlife Department

Explore...Continued on page 4



PARK RESERVATIONS

Campsites, cabins, shelters and group facilities can be reserved for up to eleven months in advance. Reservations **must** be made at least **three days in advance** of your planned stay.

REGULAR RESERVATION HOURS

Monday through Friday
9 a.m. to 6 p.m.

OUR PHONE NUMBERS

To make reservations
1-512-389-8900
To cancel reservations
1-512-389-8910
Information 1-800-792-1112
Press 3 for Park Information and then 3 again for All Other Park Information.

You can still make reservations directly at:

Indian Lodge 915-426-3254
Texas State Railroad 1-800-442-8951

GULF COAST

Matagorda Island SP History Tour - Aug. 10. Visit the lighthouse and grave sites, learn about the origins of the island from 5000 years ago until World War II. Not wheelchair accessible. TCP required. 10 a.m.-4 p.m., ferry fee \$10 adults, \$5 children under 12 plus \$2 tour fee, reservations required, 512-983-2215.

HILL COUNTRY

Fort McKavett SHP 1870s-80s Uniforms and Weapons Demonstrations - July 20; Aug. 3, 17; Sept. 7, 21. Guided tour including a demonstration of the uniforms and equipment of the infantry and cavalry of the 1870s. 10 a.m.-3 p.m., fee TCP members free; general \$2 adults, \$1 seniors and children 6-12, reservations available but not required, 915-396-2358.

Landmark Inn SHP Tour de Castroville - Aug. 10. Guided tour of the historic Landmark Inn and two private homes. Fee \$8 TCP members; general \$10, reservations required, 210-931-2133.

PANHANDLE PLAINS

San Angelo SP Petroglyph Tour - Aug. 11; Sept. 14. Visit site of a pre-historic village and see the rock art they left. 9 a.m.-noon, fee TCP members free, general \$2 adults, \$1 children 12 and under, reservations available but not required, 915-949-4757.

PINEYWOODS

Texas State Railroad SHP Steam Train Restoration Shop Tours - July 20; Aug. 17; Sept. 21. Visit one of the best known steam train restoration facilities in the nation. View operating steam engines, coaches and other historical railroad equipment. Located at the Rusk Depot. Fee train fares \$15 adults, \$9 children, reservations recommended, 1-800-442-8951.

PRAIRIES AND LAKES

Cleburne SP Texas Trivia Game - July 27; Aug. 24. Test your knowledge of Texas! Learn about the nature, history, geography and state parks of our great state. 8-9:30 p.m., 817-645-4215.

Fanthorp Inn SHP Stagecoach Days - July 13; Aug. 10; Sept. 14., second Saturdays. Ride on a replica of an 1850s Concord Stagecoach. Enjoy dulcimer music, artisan demonstrations, and tour the 1834 Stagecoach Inn. 1-4 p.m., fee \$4 adults, \$2.50 children 12 and under, 409-873-2633.

Texian Days - Sept. 28. Annual town celebration of early life in Anderson. Texas Army encampment at Fanthorp Inn, chuckwagon cooking, dulcimer players, storytellers and craft artisans. Stagecoach

rides are available at \$4 adults, \$2.50 children 12 and under. 10 a.m.-4 p.m., 409-873-2633.

Monument Hill/Kreische Brewery SHP Historic Brewery Tour - July, Aug. & Sept., every Saturday & Sunday. Guided tours of Kreische Brewery, one of the first commercial brewing operations in Texas. Learn how beer was brewed in the early days of statehood and how German culture contributed to the diversity of Texas. 2-3 p.m. and 3:30-4:30 p.m., fee TCP members free; general \$2 adults, \$1 students and children under 5 free. Reservations required, guided tours for students on a field trip via prior reservation is \$.50 per person, 409-968-5658.

Stephen F. Austin SHP Historical Tour - July, Aug. & Sept., every Saturday. Guided tour of the first Anglo colony in Texas, founded by Stephen F. Austin, the "Father of Texas." 1-2 p.m., fee \$2 adults, \$1 children 12 and under, reservations available but not required, 409-885-3613.

Washington-On-The-Brazos SHP Junior Ranger Program - July, every Wednesday, Thursday & Friday. Through hands-on activities, interactive games, demonstrations and crafts, Junior Ranger children (6-12) will learn about Texas history and family life during the Republic years, plants and animals and their amazing adaptations to survival, conservation, recycling, and wildlife habitats. 9 a.m.-noon, fee \$3 per child per day, reservations required, 409-878-2214.

Call ahead before visiting a Wildlife Management Area!

We don't want to miss you and we often leave our gates locked.

Come visit us for our special events or on your own, but let us open the doors first!

The best time to catch a biologist in an office is on a weekday early in the morning (8-9 a.m.) or during lunch because we work outside!

HIKES & WALKS

BIG BEND COUNTRY

Elephant Mountain WMA Canyon Hike - Sept. 21. Moderately strenuous 2-3 mile hike into one of the canyons of the WMA to view wildlife and its habitat. Hikers must be in good health and provide own high clearance vehicle, food, and water. 8 a.m.-approx. 2p.m. TCP required. Reservations required, 915-364-2228.

GULF COAST

Matagorda Island SP Beachcombing and Shelling Tour - July 21; Aug. 3. Six hours of shelling and beachcombing. Information on mollusks, tropical drift seeds and the ecosystems of gulf barrier islands will be provided by park staff. Bring a lunch for picnicking on the beach. Transportation is an open 4-wheel drive vehicle so dress for the weather. TCP required. 10 a.m.-5 p.m., ferry fee \$10 adults, \$5 children; \$2 tour fee, reservations required, 512-983-2215.

Marine Ecosystems Tour - July 20; Aug. 4. This marine environment will be experienced through a variety of sampling methods on both the bay and the Gulf beach of the island. Bring lunch, water, hard soled shoes for wading (tennis shoes) and an interest in the marine environment. Not wheelchair accessible. TCP required. 10 a.m.-4 p.m., ferry fee \$10 adults, \$5 children under 12, plus \$2 tour fee, reservations required, 512-983-2215.

HILL COUNTRY

Colorado Bend SP Gorman Falls Hike - July, Aug. & Sept., every Saturday and Sunday. Caravan from park headquarters to the Gorman area of the park and then hike to below the falls. From trail head, it's a one-and-a-half mile round-trip over beautiful hill country terrain. No pets allowed on tour. No restrooms or drinking water available in Gorman Falls

area. 10 a.m. & 2 p.m. Saturdays and 10 a.m. on Sundays weather permitting, \$2 per adult, \$1 for children 6 through 12 years old, under 6 years old free, 915-628-3240.

Honey Creek SNA Lower Edwards Plateau Ecosystem Walk - July 27; Aug. 10, 17, 31; Sept. 7, 28. Two mile guided walk with an interpretation of cultural, biological and geological histories of the Hill Country. 9-11 a.m., fee \$2 per person, \$5 per family, 210-438-2656.

Archeology Walk - July 20. Discussion of prehistoric Indian cultures of Central Texas followed by a guided walk with further interpretation of how the land and resources were used. 9-11 a.m., fee \$2 per person, \$5 per family, 210-438-2656.

Ethnobotany Walk - Aug. 3, 24; Sept. 14. Guided walk along the canyon to learn about uses of common native plants for food, medicine and fiber. 9-11 a.m., fee \$2 per person, \$5 per family, 210-438-2656.

Wildlife and Plant Walk - Sept. 21. Wildlife and Wildlife Ecology and Plants and plant uses of the Texas Hill Country led by award-winning photo-naturalist Allen Perry. 9-11 a.m., fee \$2 per person, \$5 per family, 210-438-2656.

PANHANDLE PLAINS

Big Spring SP Nature Walk and Sunset Tales - July 13, 20, 27. Walk with the park manager and discover century-old rock carvings on "Scenic Mountain." Learn about local flora and fauna. Watch the sunset off the top of the bluff while being entertained by a storyteller. Hear tales of treasure, cowboys, Indians, hauntings and more! Walk starts at 8 p.m., storytelling at 9 p.m., 915-263-4931.

San Angelo SP Dinosaur Walk - July 13. Hike back in time where dinosaurs once roamed the earth! See sauropod tracks in an ancient creek bed. 9 a.m.-noon, fee

TCP members free; general \$2 adults, \$1 children 12 and under, reservations available but not required, 915-949-4757.

Nature Trail Hike - July 28. Hike scenic trails with park naturalist. 9 a.m.-3 p.m., fee TCP members free; general \$2 adults, \$1 children 12 and under, reservations available but not required, 915-949-4757.

Macey's Ridge Tour - Aug. 3. Hike scenic trail to Macey's Ridge, where early pioneer made his last stand. 9 a.m.-noon, fee TCP members free; general \$2 adults, \$1 children 12 and under, reservations available but not required, 915-949-4757.

PINEYWOODS

Village Creek SP Guided Nature Trail Hike - July 13, 20, 27; Aug. 3, 10, 17, 24. Two hour, two mile hike through remnants of the Old Texas Big Thicket. 9-11 a.m., fee TCP members free; general \$1 adults, \$.50 children 12 and under, reservations required, 409-755-7322.

PRAIRIES AND LAKES

Cleburne SP Nature Trail Walk - Sept. 15. Guided walk on the Coyote Run Nature Trail. Interpretation of trees, wildflowers, animals and geology of the park. 9-11 a.m., reservations required, 817-645-4215.

Stephen F. Austin SHP Nature Trail Walk - July, Aug. & Sept., every Saturday. Learn about native plants and animals. 10 a.m.-11 a.m., fee \$2 adults, \$1 children 12 and under, reservations available but not required, 409-885-3613.

SOUTH TEXAS PLAINS

Bentsen-Rio Grande Valley SP/Las Palomas WMA Nature Tours - July 17; Aug. 7, 21. Guided nature tours in the lower Rio Grande Valley. TCP required. 8 a.m.-4 p.m., reservations required, 210-585-1107.

OUTDOOR CHALLENGES

PRAIRIES AND LAKES

Cleburne SP Kids' Wilderness Survival - Sept. 29. A fun way for kids to learn what to do if they get lost. Kids must be accompanied by a parent. 9 a.m.-noon, reservations required, 817-645-4215.

HILL COUNTRY

Colorado Bend SP Wild Cave Tours - July, Aug. & Sept., every Saturday & Sunday. The crawling tour takes you through several relatively small and progressively more difficult caves. The walking tour takes you to Gorman Cave.

Starts 9:15 a.m. Saturdays and Sundays for walking tours and 1:30 p.m. Saturdays for crawling tours, resources and weather permitting, \$10 per person for walking tour and \$15 per person for crawling tour, reservations required, 915-628-3240.

PANHANDLE PLAINS

Big Spring SP Comanche Warrior Triathlon & 10K Run - July 28. Triathlon starts at 7:30 a.m., separate 10K run starts at 9 a.m. Fee includes carbo feed, T-shirt, swim cap, certificate. fee \$35, over 65 free, reservations required, 915-263-7641.

Explore...Continued on page 8

HILL COUNTRY

Colorado Bend SP

In Lampasas and San Saba counties on the Colorado River, about 10 miles above Lake Buchanan, near the community of Bend. Bend is north of Llano via State Highway 16 or west of Lampasas via U.S. Highway 183/190. Paved access to Bend via Ranch Roads 501, 580 or 581. From Bend there are approximately 4 miles of unpaved road to the park entrance, 915-628-3240.

Fort McKavett SHP

In Menard County, northwest of Junction. From I.H. 10 take R.M. 1674 north to park.

Guadalupe River SP

In Kendall and Comal counties, 30 miles north of San Antonio on State Highway 46 between Boerne and U.S. Highway 281, 210-438-2656.

Honey Creek SNA

Access through Guadalupe River State Park, see above, 210-438-2656.

Landmark Inn SHP

In Castroville on U.S. Highway 90 about 25 miles west of San Antonio, 210-931-2133.

Old Tunnel WMA

In Kendall County. From Fredericksburg, take U.S. Highway 290 east 1-mile to Old San Antonio Road (also Grapetown exit). Head south on Old San Antonio Road 10 miles to the WMA on the left. From Comfort, take Ranch Road 473 north (go past Sisterdale turnoff) 12 miles to the WMA on the right, 210-868-7304.

BIG BEND COUNTRY

Elephant Mountain WMA

In Brewster County about 26 miles south of Alpine on the east side of State Highway 118, 915-364-2228.

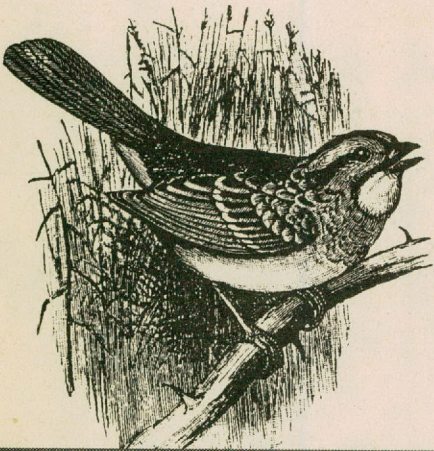

PRAIRIES AND LAKES

Cleburne SP

In Johnson County. From Cleburne take U.S. Highway 67 west for approximately 4 miles, turn on Park Road 21 for 6 miles, 817-645-4215.

Dinosaur Valley SP

In north central Somervell County about 58 miles southwest of Fort Worth. Travel 4 miles west of Glen Rose on F.M. 205/Park Road 59, 1 mile to headquarters, 817-897-4588.

Eisenhower SP

In northern Grayson County 5 miles northwest of Denison. Take U.S. Highway 75A (now State Highway 91) north to F.M. 1310, turn northwest and travel about 2 miles to Park Road 20, 903-465-1956.

Fairfield Lake SP

In Freestone County near Fairfield. From I.H. 45 take U.S. Highway 84 east to F.M. 488, go north to F.M. 2570, then go east to Park Road 64, 903-389-4514.

GULF COAST

Fennessey Ranch

In Refugio County between Refugio and Bayside off F.M. 2678. For detailed directions call 512-529-6600.

Matagorda Island SP

In Calhoun County, about 50 miles southeast of Victoria; park headquarters, dock and information center at Port O'Connor, 512-983-2215.

SOUTH TEXAS PLAINS

Bentsen-Rio Grande Valley SP

In southwestern Hidalgo County near Mission. Take U.S. Highway 83 to Mission, continue west to the exit on Inspiration Road, travel 3 miles west on Business 83 to F.M. 2062. Continue south 3 miles to park entrance, 210-585-1107 or 210-585-0902.

Chaparral WMA

In La Salle and Dimmit counties 8 miles west of Artesia Wells on F.M. 133, 210-676-3413.

Choke Canyon SP/Calliham Unit

In McMullen and Live Oak counties about 70 miles south of San Antonio. On the north side of State Highway 72, about 8 miles west of Three Rivers, 512-786-3868.

Fanthorp Inn SHP

In Grimes County on State Highway 90, 10 miles east of Navasota, 409-873-2633.

Lake Somerville SP/Nails Creek Unit

Located in Burleson County northwest of Brenham. Nails Creek Unit is located on F.M. 180, 15 miles off U.S. Highway 290, 409-289-2392.

Monument Hill/Kreische Brewery SHP

In Fayette County off U.S. Highway 77 in La Grange, 409-968-5658.

Stephen F. Austin SHP

In Austin County. From I.H. 10 exit F.M. 1458 north, 2 miles turn left on Park Road 38, 409-885-3613.

Washington-on-the-Brazos SHP

In Washington County 21 miles northeast of Brenham. From Brenham, take State Highway 105 to F.M. 912. From Navasota, take State Highway 105 west 8 miles to F.M. 1155, 409-878-2214.

July 1996- Sept. 1996, Vol. 5, No. 3

Texas Conservation Passport Journal

Texas Parks and Wildlife Department

To manage and conserve the natural and cultural resources of Texas for the use and enjoyment of future generations.

George W. Bush, Governor of Texas

Commission

Lee Bass, Chairman, Fort Worth
Nolan Ryan, Vice Chairman, Alvin
Mickey Burleson, Temple
Ray Clymer, Wichita Falls
Ygnacio Garza, Brownsville
Richard (Dick) Heath, Dallas
Terese Tarlton Hershey, Houston
Susan Howard-Chrane, Boerne
Walter Umphrey, Beaumont
Perry R. Bass, Chairman Emeritus,
Forth Worth

Andrew Sansom, Executive Director

Journal

Emily Carter, Editor
Susie Schulte, Events Editor
Linda Wells, Graphic Designer
Dawn Dittman Coronado, Marketing Director
Linda Adkins, Creative Director

TEXAS CONSERVATION PASSPORT JOURNAL (ISSN 10832823) (USPS 012968) is published quarterly by the Texas Parks and Wildlife Department, 4200 Smith School Rd., Austin, TX 78744. Both the \$50 and \$25 membership fees include the \$4.95 annual cost of this publication. Periodicals postage paid at Austin, TX.

POSTMASTER:

Send address changes to
Texas Conservation Passport Journal
4200 Smith School Rd.
Austin, TX 78744

© 1996 Texas Parks and Wildlife Department

DRIVE ACROSS TEXAS

TRAVEL DIRECTIONS TO PARKS AND OTHER PLACES

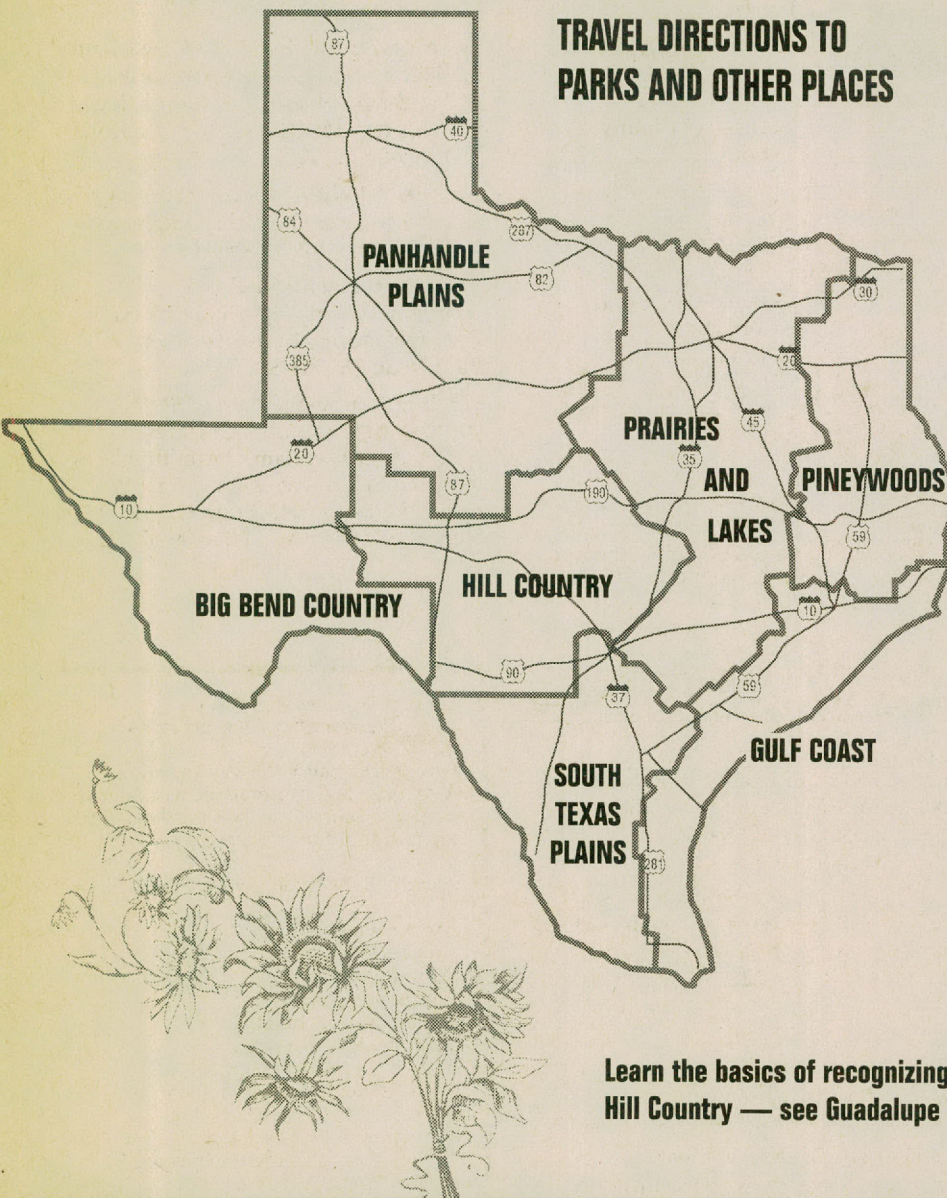

Learn the basics of recognizing common plants in the Hill Country — see Guadalupe River SP, back cover.

PANHANDLE PLAINS

Big Spring SP

In Howard County 36 miles east of Midland, or 100 miles west of Abilene. From Midland, take I.H. 20 east to Big Spring, take Business 20 exit eastbound, turn right onto F.M. 700, park is located on the right, 915-263-4931.

Caprock Canyons SP

In southeastern Briscoe County near Quitaque. The park is bordered on the north by State Highway 256, the entrance is on the south and accessible to Quitaque on Ranch Road 1065, 806-455-1492.

Caprock Canyons Trailway SP

In Briscoe County in Quitaque, on State Highway 86, 806-455-1492.

Palo Duro Canyon SP

In Randall County 12 miles east of Canyon on State Highway 217. From Amarillo, it is south on Ranch Road 1541 and then 8 miles east on State Highway 217, 806-488-2227.

San Angelo SP

In Tom Green County, 1 mile west of San Angelo, on the O.C. Fisher Reservoir, via either U.S. Highway 87 or 67 to F.M. 2288 to park entrance, 915-949-4757.

PINEYWOODS

Atlanta SP

In Cass County. From Dallas/Fort Worth, exit I.H. 30 at U.S. Highway 259 south, turn east onto State Highway 77, 903-884-3833.

Caddo Lake SP & WMA

In Harrison County 15 miles northeast of Marshall. Take State Highway 43 north to F.M. 2198, turn east and travel about 3/4-mile to Park Road 2, 903-679-3351.

Daingerfield SP

In Morris County. From Mt. Pleasant, exit on Ferguson Road. Follow State Highway 49 to the park, about 18 miles from I.H. 30, 903-645-2921.

Lake Bob Sandlin SP

In Titus County exit I.H. 30 on State Highway 37 south at Mt. Vernon. Go .8-mile, turn left on Ranch Road 21, go 10.2 miles to park entrance, 903-572-5531.

Martin Dies, Jr. SP/Angelina Neches/Dam B

In Jasper County between Woodville and Jasper on U. S. Highway 190, 409-384-5231.

Texas State Railroad SHP

Palestine Depot in Anderson County. In Palestine, 2 miles east of Loop 256 on U.S. Highway 84. Rusk Depot in Cherokee County, 2 miles west of Rusk via U.S. Highway 84, 903-683-2561.

Tyler SP

In Smith County 2 miles north of I.H. 20 on Farm Road 14 north of Tyler, 214-597-5338.

Village Creek SP

In Hardin County 10 miles north of Beaumont in Lumberton. From Beaumont, take U.S. Highway 69 north towards Lumberton, take Mitchell Road exit just before the U.S. Highway 69/96 north split, turn right onto Mitchell Road take an immediate left onto Village Creek Parkway and go approximately 2 miles. Turn right on Alma Drive, cross tracks and turn left. Go approximately .4-mile and turn left into park, 409-755-7322.

PLANTS & WILDLIFE

BIG BEND COUNTRY

Elephant Mountain WMA Desert Bighorn Viewing Tour - July 13. Driving tour of the WMA, with stops to observe sheep and other points of interest. You must furnish your own high clearance vehicle. A good spotting scope is a necessity. TCP required. 8 a.m.-3 p.m., reservations required, 915-364-2228.

HILL COUNTRY

Guadalupe River SP Plant Identification - Aug. 24; Sept. 21. Learn the basics of recognizing common plants of the Hill Country. We will use an easy plant key which you will take home. 1-3 p.m., fee \$6 per person, reservations required, 210-438-2656.

PANHANDLE PLAINS

San Angelo SP Wildlife Call Tour - Aug. 18. Listen and watch as park naturalist calls in wildlife. 7-10 a.m., fee TCP members free; general \$2 adults, \$1 children 12 and under, reservations available but not required, 915-949-4757.

PINEYWOODS

Caddo Lake SP & WMA Predators - July 20. Slide program on animals that survive by hunting and how we can help these animals survive. The program will be followed by a predator calling demonstration. Starts 8 p.m., fee TCP members free; general \$1 adults, \$.50 children 12 and under, reservations available but not required, 903-884-3833.

Martin Dies, Jr. SP Quest for Fire - July 20. Learn how fire has played an important role in the makeup of many plant communities throughout North America. 7-8:30 p.m., fee \$2 adults, \$1 children 12 and under, reservations available but not required, 409-384-5231.

The Mysterious Mountain Lion - Aug. 17. The big cat of Texas will be the topic of the evening. Learn about this elusive feline ecology and on-going data collection from past years to the present and what we can do to help out the effort. Meet behind the Nature Center at the Walnut Ridge Unit of the park. 7-8:30 p.m., fee \$2 adults, \$1 children 12 and under, reservations available but not required, 409-384-5231.

PRAIRIES AND LAKES

Cleburne SP Saturday Night at the Movies - Aug. 17. Enjoy an entertaining nature documentary. Bring a lawn chair. 8-10 p.m., 817-645-4215.

Eisenhower SP Nature Watch - July, Aug. & Sept., every Saturday. Bring your lawn chair, sit back and enjoy the Nova series of nature programs. 8-9 p.m., reservations available but not required, 903-465-1956.

SOUTH TEXAS PLAINS

Chaparral WMA Reptiles of South Texas - July 12, 13, 14. Nature trails and campground will be open to the public from noon on July 12 to noon July 14. Guided tours of nature trails will be conducted at 6 p.m. on July 12 and 7:30 a.m. July 13 and 14. There will be a slide presentation on south Texas reptiles with live specimens on July 13 at 10:30 a.m., reservations available but not required, 210-676-3413.

Choke Canyon SP/Calliham Unit Alligator Nesting Tour - July 13, 20, 27; Aug. 3. See a film on alligators, experience a hands-on demonstration, then visit a nesting site. 1-3 p.m., fee TCP members \$5; general \$8, senior citizens \$5, children 12 and under free, reservations required, 512-786-3868.

Wildlife Track I.D. - Aug. 10. Learn to identify wildlife tracks and make plaster-of-paris copies of animal prints. 9 a.m.-noon, fee TCP members \$3; general \$5 adults, \$3 senior citizens, children 12 and under free, reservations required, 512-786-3868.

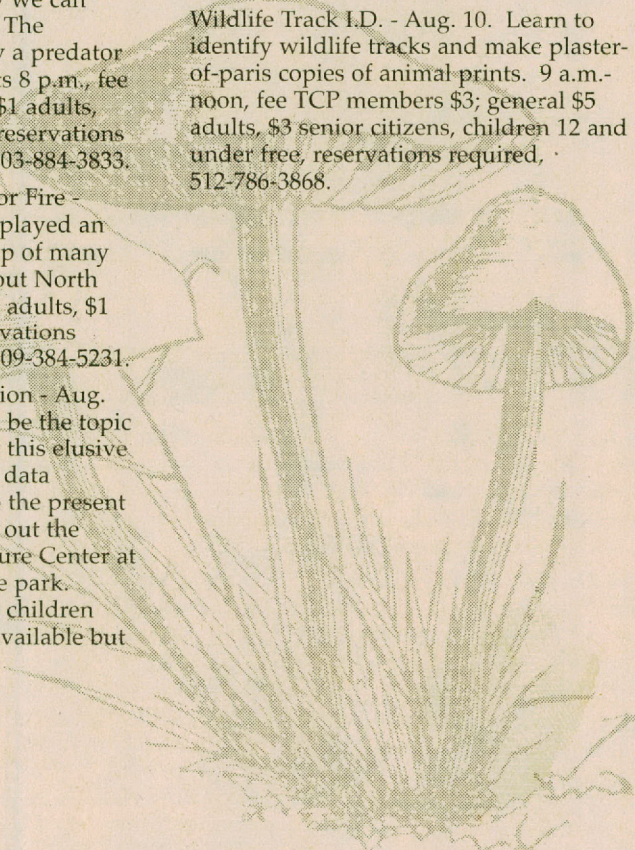

Join Texas Parks and Wildlife - and Explore the real Texas!

\$50 Gold Passport

- ✪ A windshield decal for no-hassle park entry!
- ✪ Unlimited vehicle entry to Texas state parks for all passengers in a vehicle with a decal and free tours for the Passport member at state historical parks!
- ✪ Plus all benefits of the Silver Passport!

\$25 Silver Passport

- ✪ *Texas Conservation Passport Journal!*
- ✪ Discounts on Texas Conservation Passport tours!
- ✪ Access to Wildlife Management Areas!
- ✪ News of Fish Hatcheries!
- ✪ A subscription price of \$10.50 to *Texas Parks & Wildlife* magazine for one year!

TEXAS
CONSERVATION
PASSPORT
JOURNAL
4200 Smith School Road
Austin, TX 78744

