

1990 COUNTY BLOCK MAP (RECREATED): PANOLA County

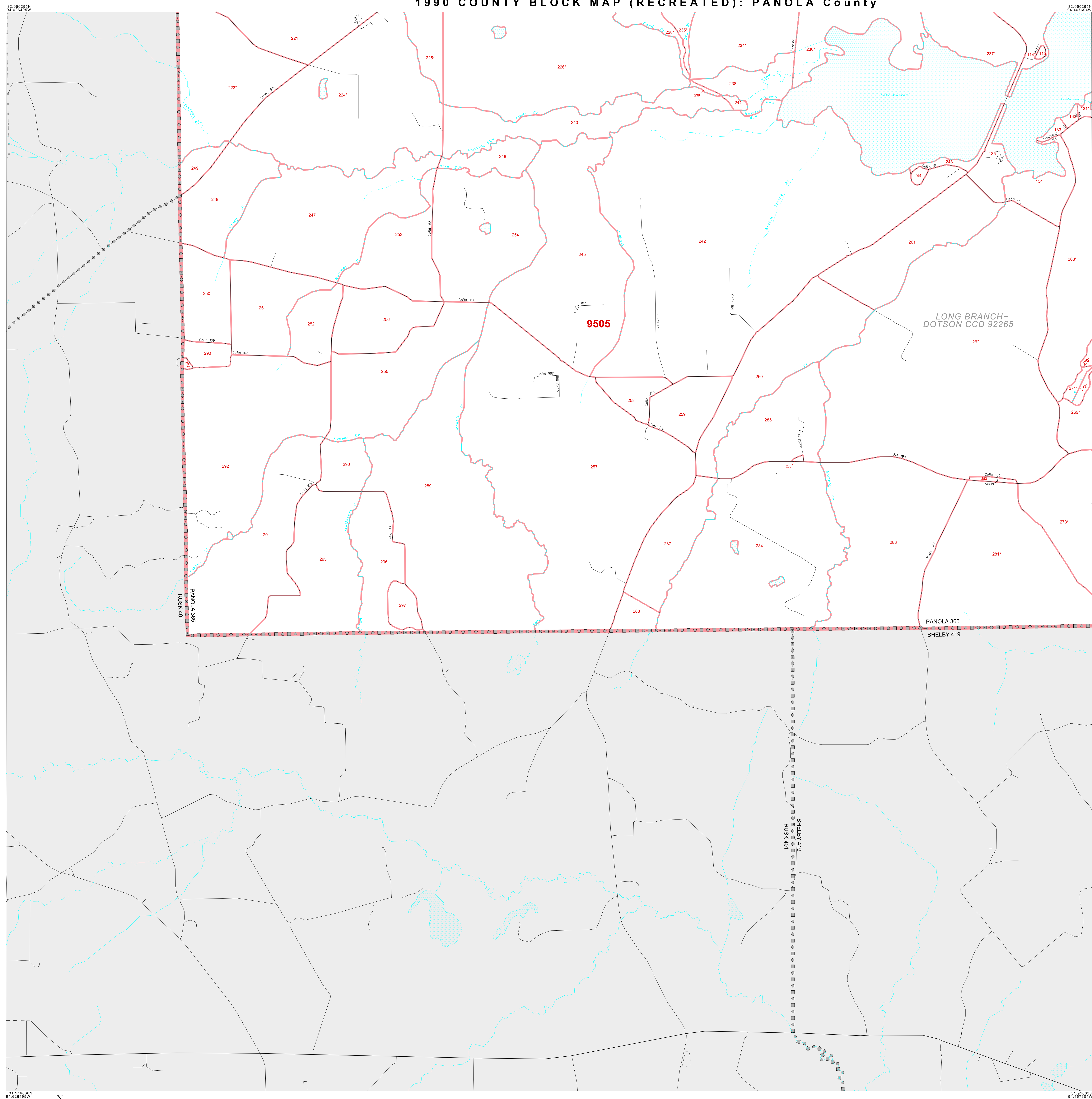

LEGEND

SYMBOL	NAME STYLE
☆ ☆ ☆ ☆ ☆	INTERNATIONAL
★ ★ ★ ★ ★	AIR
◇ ◇ ◇ ◇ ◇	Trust Land
▽ ▽ ▽ ▽ ▽	TJSA / TDSA / ANVSA
▲ ▲ ▲ ▲ ▲	ANRC
■ ■ ■ ■ ■	MINOR CIVIL DIV ¹ / CCD
□ □ □ □ □	Place within Subject Entity
▨ ▨ ▨ ▨ ▨	Incorporated Place / CDP ¹
▩ ▩ ▩ ▩ ▩	Place outside of Subject Entity
▬	Census Tract / BNA ²
—	BLOCK ³

ABBREVIATION REFERENCE: AIR = American Indian Reservation; Trust Land = Off-Reservation Trust Land; TDSA = Tribal Jurisdiction Statistical Area; TJSA = Tribal Designated Statistical Area; ANVSA = Alaska Native Village Statistical Area; ANRC = Alaska Native Regional Corporation; CCD = Census Civil Division; CDP = Census Designated Place; BNA = Block Numbering Area

FEATURES

Highway	Pipe/Paver Line	Stream/Shoaling
Secondary Road	Ridge/Physical Feature	Intermittent Stream
Leap Trail/Wharve/Ferry	Property/Fence Line	River
Railroad	Nonvisible Boundary	Gravel

Where international, state, and/or county boundaries coincide, the map shows the boundary symbol for only the highest-ranking of these boundaries.

¹ A "*" following a place name indicates that the place is also a false MCD; the false MCD name is not shown.

² In 1990, the crew-of-vessel population of ships at sea was allocated to census tracts with a "00" suffix. An anchor symbol appeared on the 1990 maps locating a crew-of-vessel tract. These maps show a very small area symbolized as a census tract with the census tract number shown near the area.

³ A "*" following a block number indicates that the block number is repeated elsewhere in the block.

Key to Adjacent Sheets

9	10
13	14

Sheet Location within Entity

SHEET 13 OF 16 PARENT SHEETS
TOTAL SHEETS: 22 (Index 1; Parent 16; Inset 5)