

1990 COUNTY BLOCK MAP (RECREATED): LAMB County

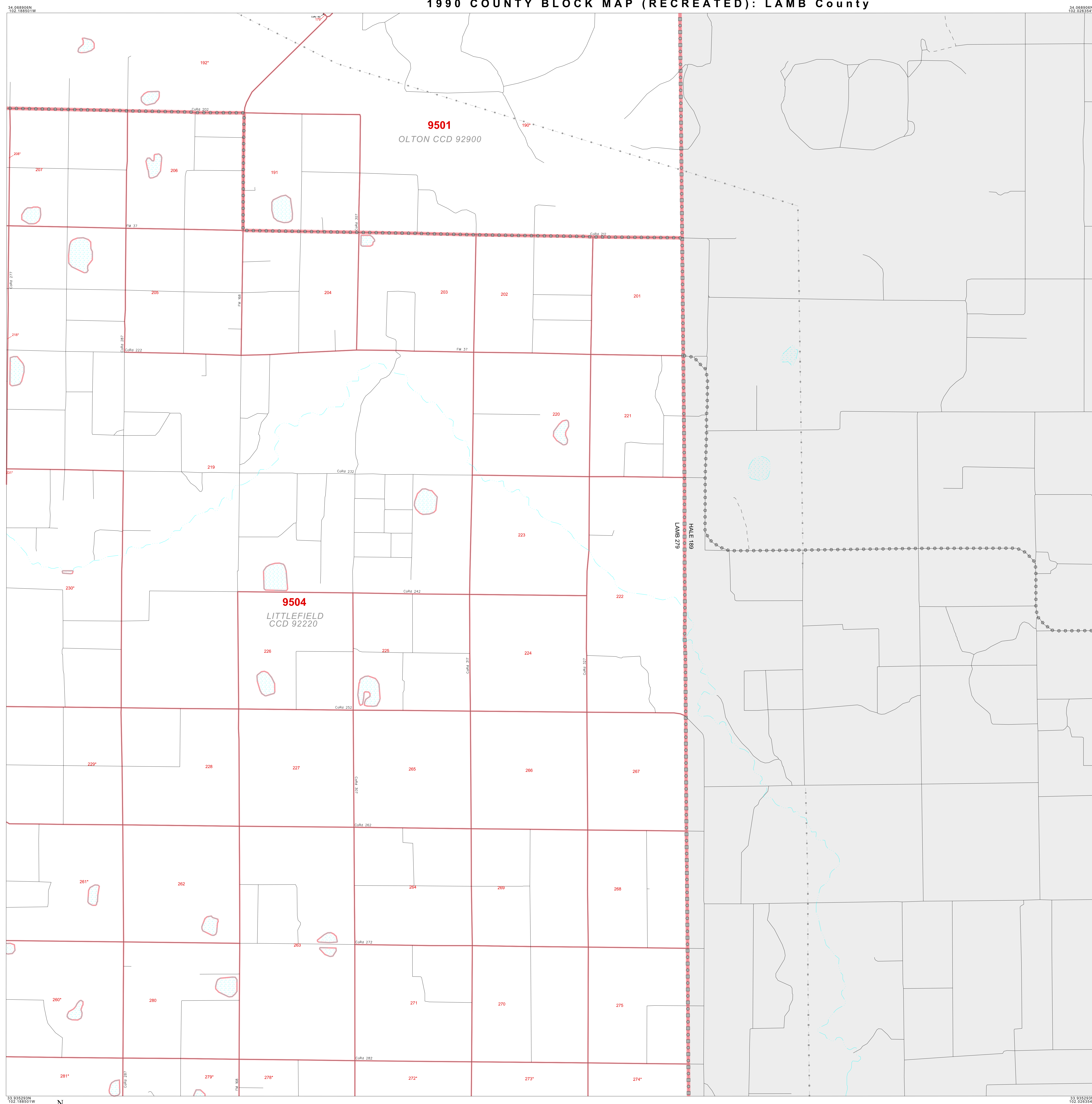

LEGEND

| SYMBOL | NAME STYLE |
|--------|---------------------------------------|
| ☆☆☆☆ | INTERNATIONAL |
| ***** | AIR |
| ◇◇◇◇◇ | Trust Land |
| ▽▽▽▽▽ | TJSA / TDSA / ANVSA |
| ▲▲▲▲▲ | ANRC |
| ▣▣▣▣ | MINOR CIVIL DIV ¹ / CCD |
| ○ | Place within Subject Entity |
| □ | Incorporated Place / CDP ¹ |
| ▨ | Place outside of Subject Entity |
| ▨ | Incorporated Place / CDP ¹ |
| ▨ | Census Tract / BNA ² |
| ▨ | BLOCK ³ |

ABBREVIATION REFERENCE: AIR = American Indian Reservation; Trust Land = Off-Reservation Trust Land; TDSA = Tribal Jurisdiction Statistical Area; TJSA = Tribal Designated Statistical Area; ANVSA = Alaska Native Village Statistical Area; ANRC = Alaska Native Regional Corporation; CCD = Census Civil Division; CDP = Census Designated Place; BNA = Block Numbering Area

FEATURES

| | | |
|-----------------------------|------------------------|---------------------|
| Highway | Pipe/Paver Line | Stream/Shoreline |
| Secondary Road | Ridge/Physical Feature | Intermittent Stream |
| Deep Trench/Warehouse/Ferry | Property/Fence Line | River |
| Railroad | Nonvisible Boundary | Canal |

Where international, state, and/or county boundaries coincide, the map shows the boundary symbol for only the highest-ranking of these boundaries.

¹ A "*" following a place name indicates that the place is also a false MCD; the false MCD name is not shown.

² In 1990, the census-of-vessels population of ships at sea was allocated to census tracts with a "SP" suffix. An anchor symbol appeared on the 1990 maps locating a census-of-vessels tract. These maps show a very small area symbolized as a census tract with the census tract number shown near the area.

³ A "*" following a block number indicates that the block number is repeated elsewhere in the block.

33 835200N 102 188501W

34 064906N 102 026354W

Entity Type: County
Name: Lamb County (279)
ST: Texas (48)

Key to Adjacent Sheets

| | |
|----|----|
| 7 | 8 |
| 11 | 12 |
| 15 | 16 |

Sheet Location within Entity

SHEET 12 OF 16 PARENT SHEETS
TOTAL SHEETS: 25 (Index 1; Parent 16; Inset 8)

The plotted map scale is 1:20000

1:0 9 8 7 6 5 4 3 2 1 0 1 km 1.0 mi

Source: U.S. Census Bureau's TIGER database (Census 2000) Projection: State-based Albers' Equal Area U.S. DEPARTMENT OF COMMERCE Economics and Statistics Administration U.S. Census Bureau

1990 COUNTY BLOCK MAP (RECREATED)
(PDRDLK) 19548279012000000000