

# 1990 COUNTY BLOCK MAP (RECREATED): DICKENS County

### LEGEND

| SYMBOL                          | NAME STYLE                            |
|---------------------------------|---------------------------------------|
| *****                           | INTERNATIONAL                         |
| *****                           | AIR                                   |
| *****                           | Trust Land                            |
| *****                           | TJSA / TDSA / ANVSA                   |
| *****                           | ANRC                                  |
| //////                          | MINOR CIVIL DIV <sup>1</sup> / CCD    |
| Place within Subject Entity     | Incorporated Place / CDP <sup>1</sup> |
| Place outside of Subject Entity | Incorporated Place / CDP <sup>1</sup> |
| ————                            | Census Tract / BNA <sup>2</sup>       |
| ————                            | BLOCK <sup>3</sup>                    |

**ABBREVIATION REFERENCE:** AIR = American Indian Reservation; Trust Land = Off-Reservation Trust Land; TDSA = Tribal Jurisdiction Statistical Area; TJSA = Tribal Designated Statistical Area; ANVSA = Alaska Native Village Statistical Area; ANRC = Alaska Native Regional Corporation; CCD = Census Civil Division; CDP = Census Designated Place; BNA = Block Numbering Area

#### FEATURES

|                         |                        |                     |
|-------------------------|------------------------|---------------------|
| Highway                 | Pipe/Paver Line        | Stream/Shoaline     |
| Secondary Road          | Ridge/Physical Feature | Intermittent Stream |
| Deep Trench/Wharf/Ferry | Property/Fence Line    | River               |
| Railroad                | Nonvisible Boundary    | Creeks              |

Where international, state, and/or county boundaries coincide, the map shows the boundary symbol for only the highest-ranking of these boundaries.

<sup>1</sup> A "\*" following a place name indicates that the place is also a false MCD; the false MCD name is not shown.

<sup>2</sup> In 1990, the crew-of-vessel population of ships at sea was allocated to census tracts with a "SV" suffix. An anchor symbol appeared on the 1990 maps locating a crew-of-vessel tract. These maps show a very small area symbolized as a census tract with the census tract number shown near the area.

<sup>3</sup> A "\*" following a block number indicates that the block number is repeated elsewhere in the block.

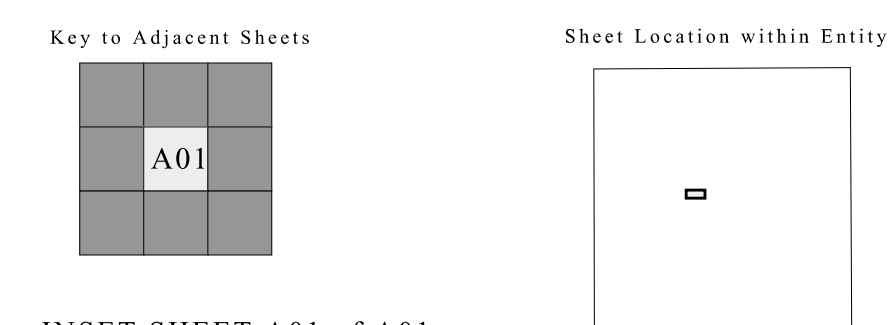
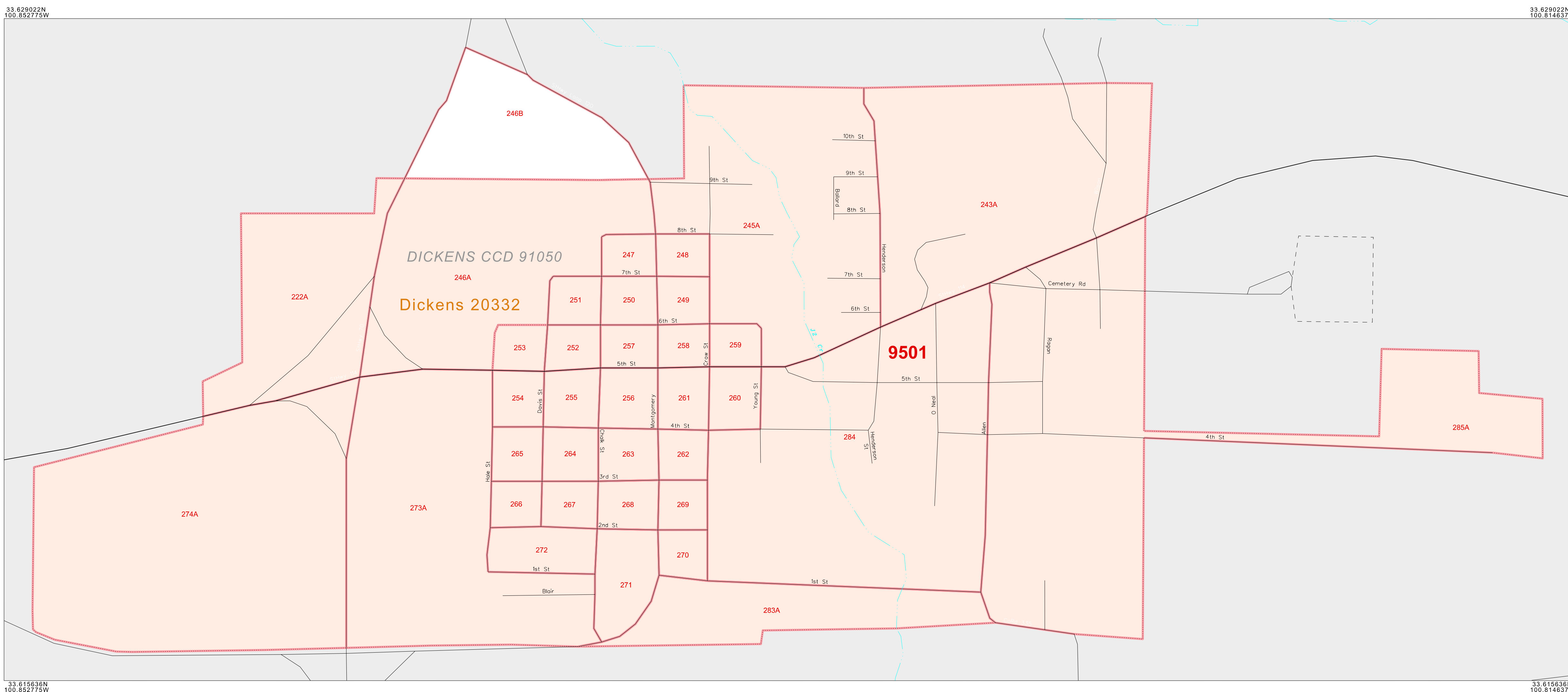

INSET SHEET A01 of A01  
TOTAL SHEETS: 12 (Index 1; Parent 9; Inset 2)

ENTITY TYPE: County  
NAME: Dickens County (125)  
ST: Texas (48)

