

CENSUS 2000 BLOCK MAP: HOPKINS County

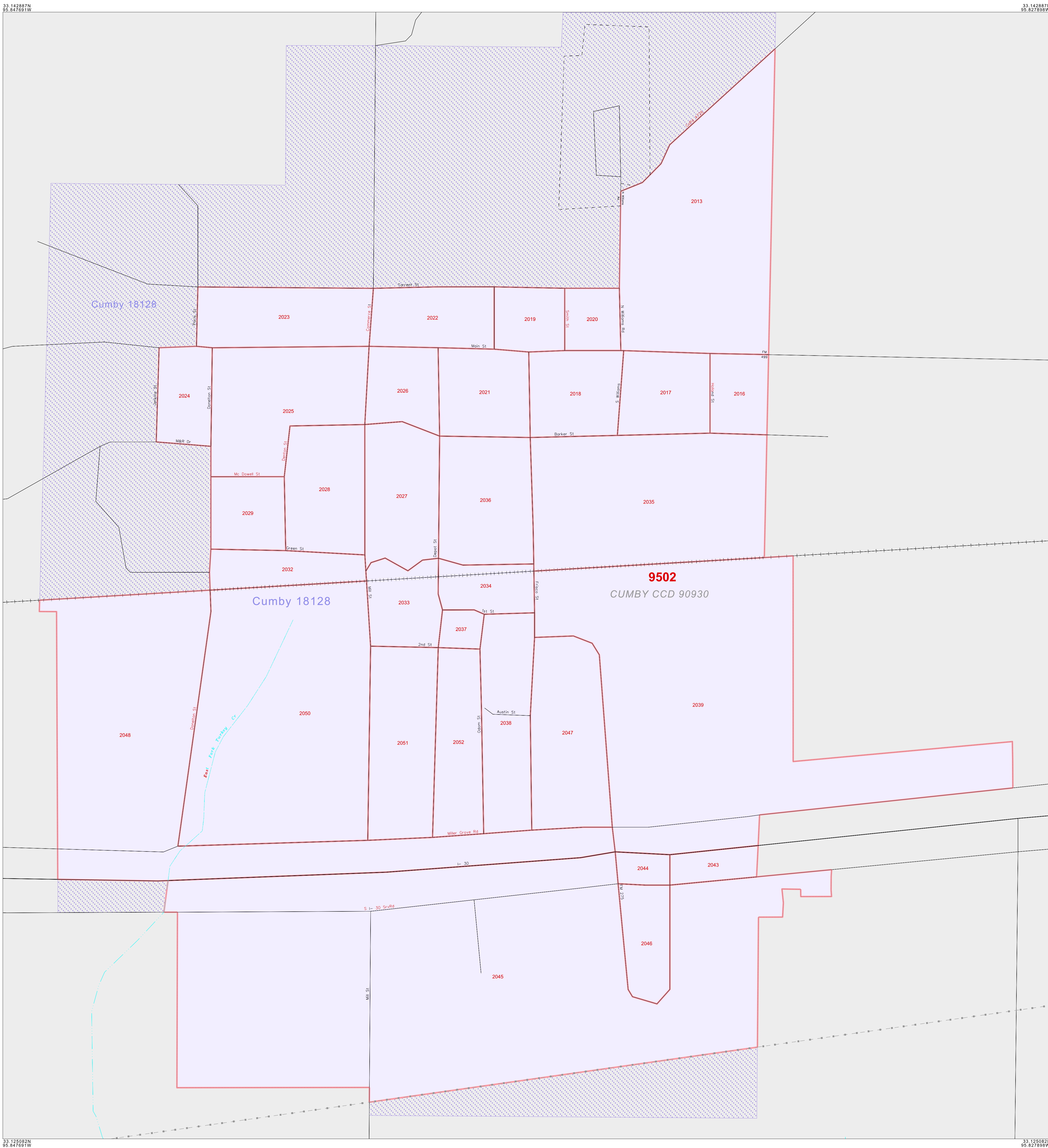

33 142887N
95 827891W

The plotted map scale is 1:3000

33 142887N
95 827891W

ENTITY TYPE: County
 NAME: Hopkins County (223)
 ST: Texas (48)

Key to Adjacent Sheets

Sheet Location within Entity

INSET SHEET A01 of A01
 TOTAL SHEETS: 20 (Index 1; Parent 15; Inset 4)

CENSUS 2000 BLOCK MAP

 (2RGUCOU) 421422365010000000

All legal boundaries and names are as of January 1, 2000. The boundaries shown on this map are for Census Bureau statistical data collection and tabulation purposes only; their depiction and designation for statistical purposes does not constitute a determination of jurisdictional authority or rights of ownership or entitlement. Source: U.S. Census Bureau's TIGER database (Census 2000). Projection: State-based Albers' Equal Area. U.S. DEPARTMENT OF COMMERCE Economics and Statistics Administration U.S. Census Bureau