

# CENSUS 2000 BLOCK MAP: BROOKS County

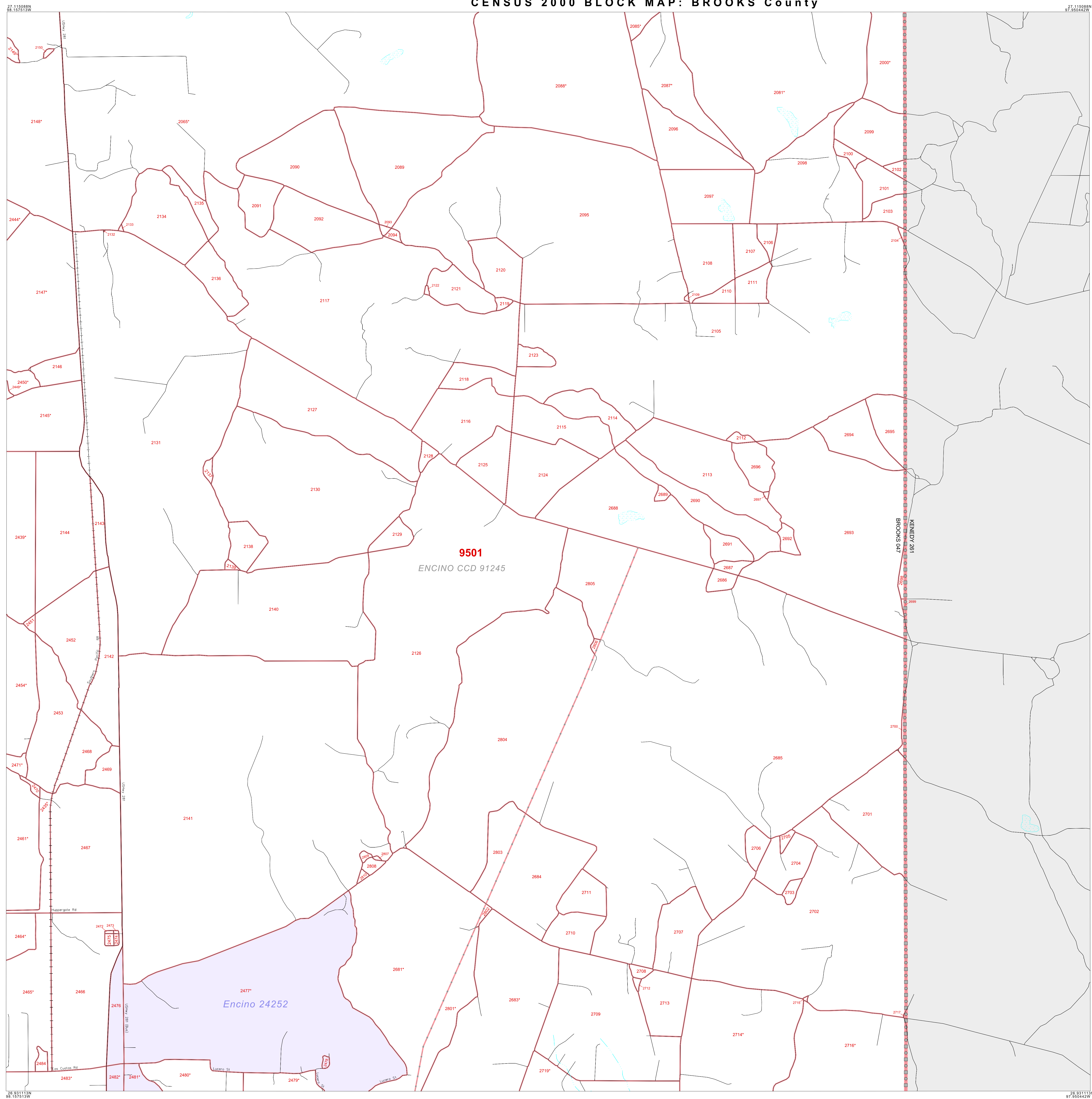

### LEGEND

SYMBOL	NAME/STYLE
*****	INTERNATIONAL
*****	AIR (FEDERAL)
*****	Trust Land / Home Land
*****	OTSA / TDSA / ANVSA
*****	AMERICAN INDIAN TRIBAL SUBDIVISION
*****	AIR (State)
*****	SDA/ISA
*****	ANRC
-----	STATE (or statistically equivalent entity)
-----	COUNTY (or statistically equivalent entity)
-----	MINOR CIVIL DIV. / CCD <sup>1</sup>
-----	Consolidated City
-----	Place within Subject Entity
-----	Incorporated Place / CDP <sup>1</sup>
-----	Place outside of Subject Entity
-----	Incorporated Place / CDP <sup>1</sup>
-----	Corporate Offset Boundary
-----	<b>Census Tract</b>
-----	<b>Block<sup>2</sup></b>

**ABBREVIATION REFERENCE:** AIR = American Indian Reservation; Trust Land = Off-Reservation Trust Land; Home Land = Hawaiian Home Land; OTSA = Oklahoma Tribal Statistical Area; TDSA = Tribal Designated Statistical Area; ANVSA = Alaska Native Village Statistical Area; SDA/ISA = State Designated American Indian Statistical Area; ANRC = Alaska Native Regional Corporation; CDP = Census Designated Place; Minor Civil Div. (MCD) = Minor Civil Division; CCD = Census County Division

### FEATURES

-----	Highway	-----	Pipe/Power Line	-----	Stream/Shoreline
-----	Secondary Road	-----	Ridge/Physical Feature	-----	Intermittent Stream
-----	Deep Trail/Highway/Ferry	-----	Property/Fence Line	-----	River/Lake
-----	Railroad	-----	Nonvisible Boundary	-----	Glacier

Where international, state, and/or county boundaries coincide, the map shows the boundary symbol for only the highest-ranking of these boundaries.  
<sup>1</sup> A " " following a place name indicates that the place is coextensive with a MCD. A " " indicates that the place is also a false MCD; the false MCD name is not shown.  
<sup>2</sup> A " " following a block number indicates that the block number is repeated elsewhere in the block.

Key to Adjacent Sheets

2	3
5	6
8	9

Sheet Location within Entity

SHEET 6 OF 9 PARENT SHEETS  
 TOTAL SHEETS: 14 (Index 1; Parent 9; Inset 4)