

CENSUS 2000 BLOCK MAP: STERLING County

31 730132N
101 371840W

31 730132N
101 153424W

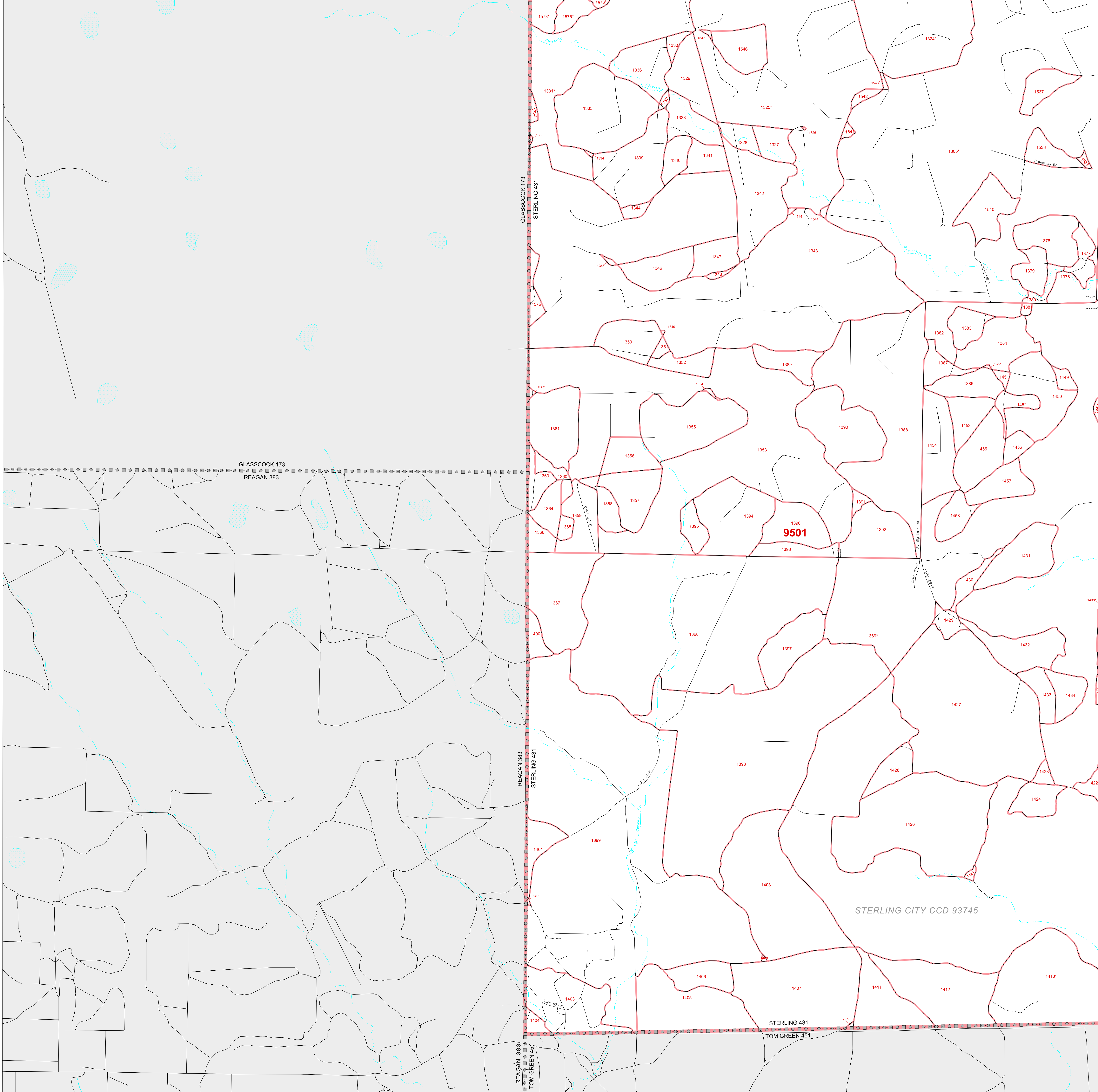

LEGEND

SYMBOL	NAME	STYLE
*****	INTERNATIONAL	
*****	AIR (FEDERAL)	
*****	Trust Land / Home Land	
*****	OTSA / TDSA / ANVSA	
*****	AMERICAN INDIAN TRIBAL SUBDIVISION	
*****	AIR (State)	
*****	SDA/ISA	
*****	ANRC	
-----	STATE (or statistically equivalent entity)	
-----	COUNTY (or statistically equivalent entity)	
-----	MINOR CIVIL DIV. / CCD ¹	
-----	Consolidated City	
-----	Place within Subject Entity	
-----	Incorporated Place / CDP ¹	
-----	Place outside of Subject Entity	
-----	Incorporated Place / CDP ¹	
-----	Corporate Offset Boundary	
-----	Census Tract	
-----	BLOCK²	

ABBREVIATION REFERENCE: AIR = American Indian Reservation; Trust Land = Off-Reservation Trust Land; Home Land = Hawaiian Home Land; OTSA = Oklahoma Tribal Statistical Area; TDSA = Tribal Designated Statistical Area; ANVSA = Alaska Native Village Statistical Area; SDA/ISA = State Designated American Indian Statistical Area; ANRC = Alaska Native Regional Corporation; CDP = Census Designated Place; Minor Civil Div. (MCD) = Minor Civil Division; CCD = Census County Division

FEATURES

Highway	Pipe/Power Line	Stream/Shoreline
Secondary Road	Ridge/Physical Feature	Intermittent Stream
Deep Trail/Highway/Ferry	Property/Fence Line	River/Lake
Roadroad	Nonvisible Boundary	Glacier

Where international, state, and/or county boundaries coincide, the map shows the boundary symbol for only the highest-ranking of these boundaries.
¹ A " " following a place name indicates that the place is coterminous with a MCD. A " " indicates that the place is also a false MCD; the false MCD name is not shown.
² A " " following a block number indicates that the block number is repeated elsewhere in the block.

31 546229N
101 371840W

31 546229N
101 153424W

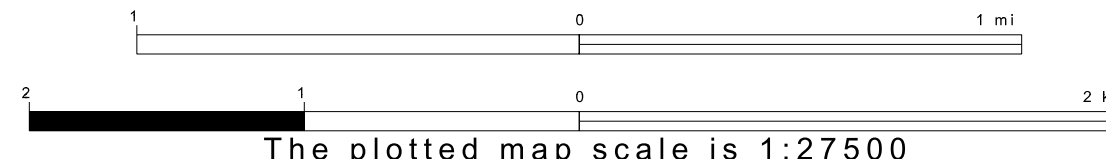

ENTITY TYPE: County
 NAME: Sterling County (431)
 ST: Texas (48)

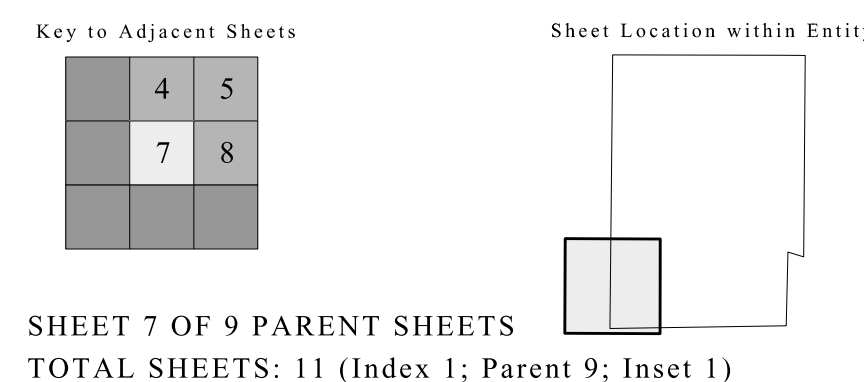

SHEET 7 OF 9 PARENT SHEETS
 TOTAL SHEETS: 11 (Index 1; Parent 9; Inset 1)

