

# CENSUS 2000 BLOCK MAP: LLANO County

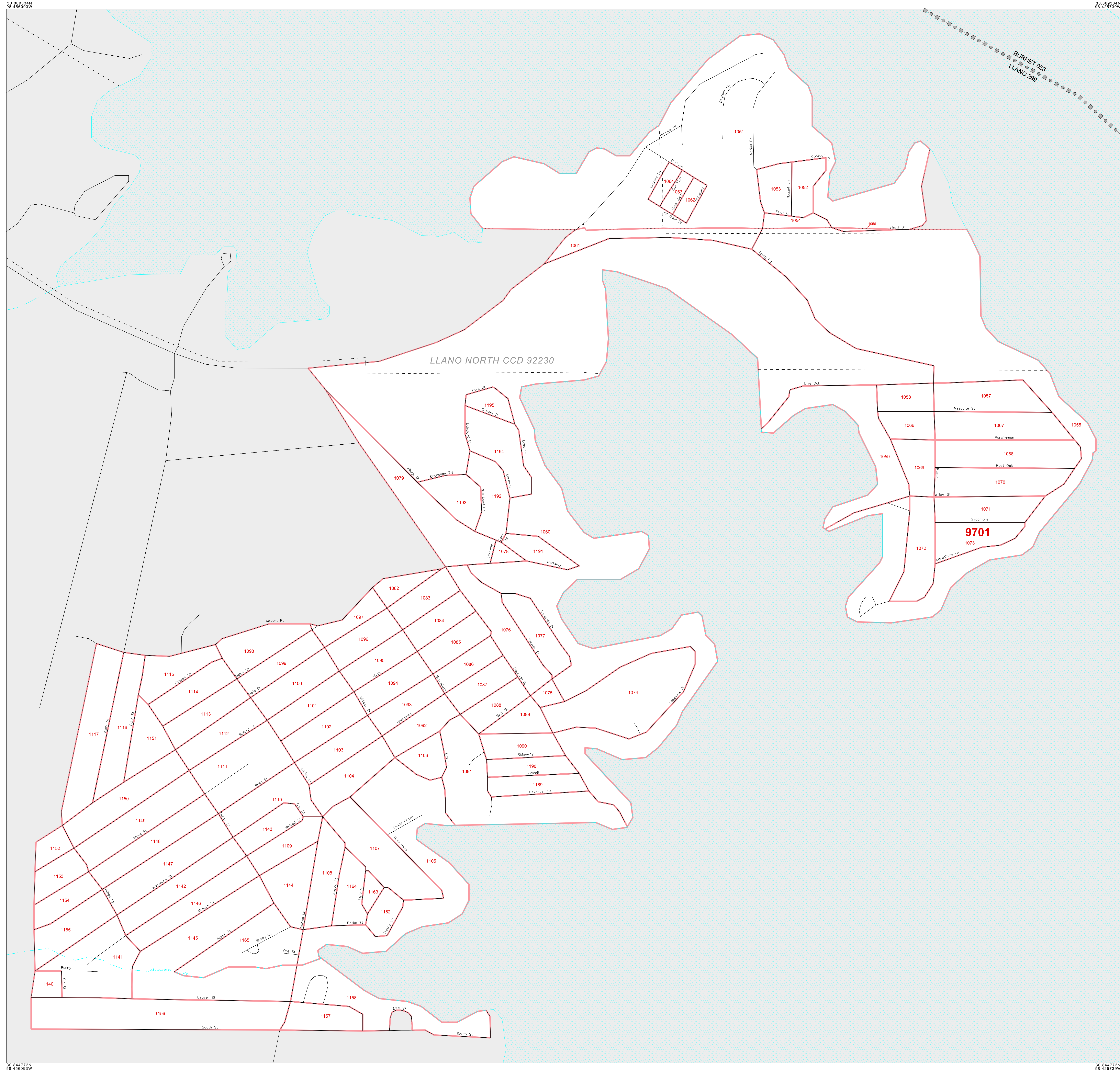

### LEGEND

SYMBOL	NAME/STYLE
*****	INTERNATIONAL
*****	AIR (FEDERAL)
*****	Trust Land / Home Land
*****	OTSA / TDSA / ANVSA
*****	AMERICAN INDIAN TRIBAL SUBDIVISION
//////	AIR (State)
◇◇◇◇◇	SDA/ISA
▽▽▽▽▽	ANRC
	STATE (or statistically equivalent entity)
	COUNTY (or statistically equivalent entity)
	MINOR CIVIL DIV. / CCD <sup>1</sup>
○	Consolidated City
○	Place within Subject Entity
○	Incorporated Place / CDP <sup>1</sup>
○	Place outside of Subject Entity
○	Incorporated Place / CDP <sup>1</sup>
---	Corporate Offset Boundary
---	<b>Census Tract</b>
---	<b>Block<sup>2</sup></b>

ABBREVIATION REFERENCE: AIR = American Indian Reservation; Trust Land = Off-Reservation Trust Land; Home Land = Hawaiian Home Land; OTSA = Oklahoma Tribal Statistical Area; TDSA = Tribal Designated Statistical Area; ANVSA = Alaska Native Village Statistical Area; SDA/ISA = State Designated American Indian Statistical Area; ANRC = Alaska Native Regional Corporation; CDP = Census Designated Place; Minor Civil Div. (MCD) = Minor Civil Division; CCD = Census County Division

FEATURES	
Highway	Pipe/Power Line
Secondary Road	Ridge/Physical Feature
Deep Trail/Pathway/Ferry	Property/Fence Line
Railroad	Nonvisible Boundary
	Stream/Shoreline
	Intermittent Stream
	River/Lake
	Glacier

Where international, state, and/or county boundaries coincide, the map shows the boundary symbol for only the highest-ranking of these boundaries.  
<sup>1</sup> A " " following a place name indicates that the place is coterminous with a MCD. A " " indicates that the place is also a false MCD; the false MCD name is not shown.  
<sup>2</sup> A " " following a block number indicates that the block number is repeated elsewhere in the block.

30 869334N  
98 425733W

30 844772N  
98 426693W

The plotted map scale is 1:4000

30 869334N  
98 425733W

30 844772N  
98 426693W

ENTITY TYPE: County  
 NAME: Llano County (299)  
 ST: Texas (48)

CENSUS 2000 BLOCK MAP  
 (2KGUCOU)214829965010000000

Key to Adjacent Sheets

A01
-----

Sheet Location within Entity

INSET SHEET A01 of A01  
 TOTAL SHEETS: 30 (Index 1; Parent 16; Inset 13)

All legal boundaries and names are as of January 1, 2000. The boundaries shown on this map are for Census Bureau statistical data collection and tabulation purposes only; their depiction and designation for statistical purposes does not constitute a determination of jurisdictional authority or rights of ownership or entitlement. Source: U.S. Census Bureau's TIGER database (Census 2000). Projection: State-based Albers' Equal Area. U.S. DEPARTMENT OF COMMERCE Economics and Statistics Administration U.S. Census Bureau