

2010 CENSUS - CENSUS BLOCK MAP: Howard County TX

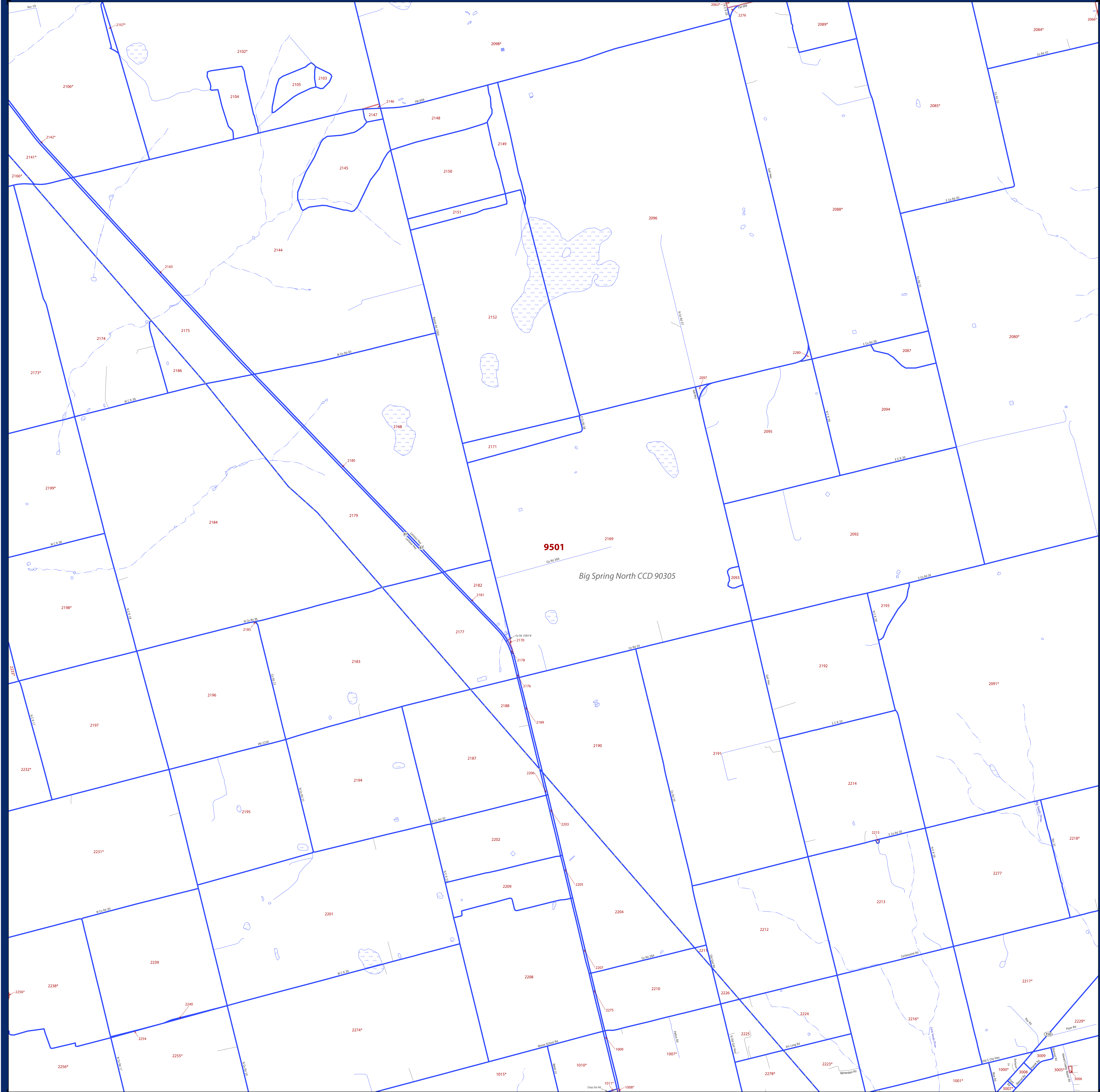

LEGEND

SYMBOL DESCRIPTION	SYMBOL	LABEL STYLE
International	☆☆☆☆☆☆	CANADA
Federal American Indian Reservation	★ ★ ★ ★ ★ ★	L'ANSE RESV N 1880
Off Reservation Trust Land, Hawaiian Home Land	+ + + + + +	T1880
State Designated Tribal Statistical Area	◆ ◆ ◆ ◆ ◆ ◆	KAW OTSA 5690
Alaska Native Village Statistical Area, Tribal Designated Statistical Area	● ● ● ● ● ●	EAGLE NEST DIST 200
American Indian Tribal Subdivision	//// ////	Tama Resv n 9400
State American Indian Reservation	◆ ◆ ◆ ◆ ◆ ◆	Lumbee SDTSA 9815
State Designated Tribal Statistical Area	▼ ▼ ▼ ▼ ▼ ▼	NANA ANRC 52120
Alaska Native Regional Corporation	//// ////	NEW YORK 36
State (or statistically equivalent entity)	□ □ □ □ □ □	MONTGOMERY 031
County (or statistically equivalent entity)	□ □ □ □ □ □	Bristol town 07485
Minor Civil Division (MCD)	○ ○ ○ ○ ○ ○	Hanna CCD 91650
Consolidated City	○ ○ ○ ○ ○ ○	MILFORD 47500
Incorporated Place ^{1,2}	Colorful box	Davis 18100
Census Designated Place (CDP) ²	Colorful box	Incline Village 35100
Census Tract	Colorful box	33.07
Census Block ³	Colorful box	3012

DESCRIPTION	SYMBOL	DESCRIPTION	SYMBOL
Interstate	Thick blue line	Geographic Offset or Corridor	Thin blue line
U.S. Highway	Double line	Water Body	Blue wavy line
State Highway	Single line	Swamp, Marsh, or Gravel Pit/Quarry	Blue hatched area
Other Road	Thin line	Glacier	Blue dashed line
Cul-de-sac	Thin line with arrow	Military	Blue dashed line with 'F' symbol
Circle	Thin line with circle	National or State Park, Forest, or Recreation Area	Blue dashed line with 'Y' symbol
4WD Trail, Stairway, Alley, Walkway, or Ferry	Thin line with 'S' symbol	Airport	Blue dashed line with 'A' symbol
Railroad	Thin line with cross-ticks	Selected Mountain Peaks	Blue dashed line with 'M' symbol
Pipeline or Power Line	Thin line with cross-ticks	Island Name	Blue dashed line with 'I' symbol
Ridge or Fence	Thin line with cross-ticks	Inset Area	Blue dashed line with 'A' symbol
Property Line	Thin line with cross-ticks	Outside Subject Area	Blue dashed line with 'A' symbol
Perennial Stream	Blue line with 'F' symbol		
Intermittent Stream or Feature Not Elsewhere Classified	Blue line with 'P' symbol		

Where state, county, and/or MCD/CCD boundaries coincide, the map shows the boundary symbol for only the highest-ranking of these boundaries. Where American Indian reservation and American Indian tribal subdivision boundaries coincide, the map shows only the American Indian reservation boundaries. Where Oklahoma tribal statistical area boundaries and American Indian tribal subdivision boundaries coincide, the map shows only the Oklahoma tribal statistical area boundaries.

1 A "*" following an MCD name denotes a false MCD. A "*" following a place name indicates that a false MCD exists with the same name and FIPS code as the place; the false MCD label is not shown.

2 Place label color correlates to the place fill color.

3 A "*" following a block number indicates that the block number is repeated elsewhere in the block.

All legal boundaries and names are as of January 1, 2010. The boundaries shown on this map are for Census Bureau statistical data collection and tabulation purposes only; their depiction and designation for statistical purposes does not constitute a determination of jurisdictional authority or rights of ownership or entitlement.

Geographic Vintage: 2010 Census (reference date: January 1, 2010)
 Data Source: U.S. Census Bureau's MAINTIGER database (TAB100148)
 Map Created by Geography Division: April 15, 2011

U.S. DEPARTMENT OF COMMERCE Economics and Statistics Administration U.S. Census Bureau

Projection: Albers Equal Area Conic
 Datum: NAD 83
 Spheroid: GRS 80
 1st Standard Parallel: 27 36 51
 2nd Standard Parallel: 34 43 24
 Central Meridian: -100 04 35
 Latitude of Projection's Origin: 25 50 13
 False Easting: 0
 False Northing: 0

The plotted map scale is 1:200000

Key to Sheets

1	2	3
5	6	7
9	10	11

PARENT SHEET 6
 Total Sheets: 22
 Index Sheets: 1
 Parent Sheets: 16
 Inset Sheets: 5

NAME: Howard County (227)
 ENTITY TYPE: County or statistically equivalent entity
 ST: Texas (48)

Location of County within State

Sheet Location within Entity

Geographic: UMI (IGI) Block Map Series
 2010 CENSUS BLOCK MAP (PARENT) - County
 210048227006