

This sheet must not be taken from the files without an order from the Chief Topographic Engineer.

U. S. G. S. FILE COPY Inspection and Editing.

NOV 19 1924

488-S-IV-W/2-NW/4

STATE OF TEXAS BOARD OF WATER ENGINEERS JOHN A. NORRIS, CHAIRMAN C. S. CLARK, A. H. DUNLAP (Temple 2-c)

Advance sheet Subject to correction

TEXAS (BELL COUNTY)

TEMPLE 3-b QUADRANGLE

DEPARTMENT OF THE INTERIOR U. S. GEOLOGICAL SURVEY



Topography by B.A. Jenkins, J.L. Lewis, Olinus Smith, R.G. Stevenson and H.A. Bean Surveyed in 1923-1924

Polyconic projection. North American datum. 5000 yard grid based upon U. S. zone system. D

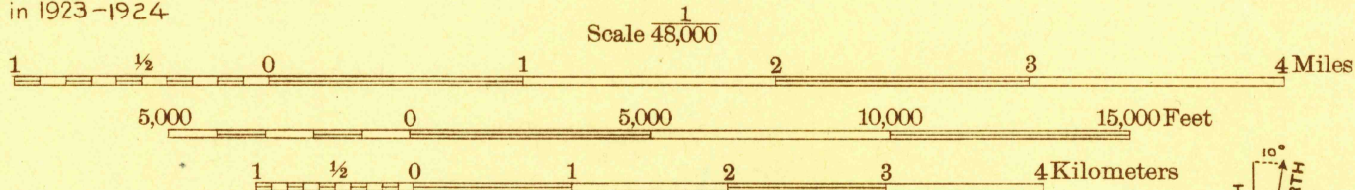

Contour interval 20 feet Datum is mean sea level

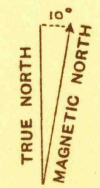
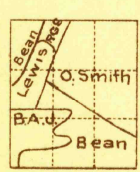

APPROXIMATE MEAN DECLINATION, 1924

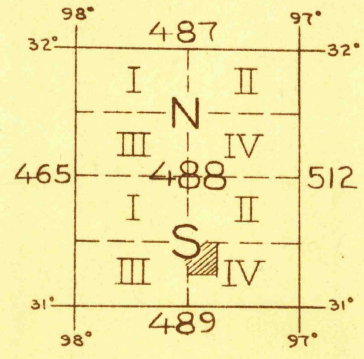

TEMPLE 3-b, TEXAS

RETURN TO: 4665 MAD HISTORICAL MAP ARCHIVES

U. S. G. S. FILE COPY Inspection and Editing.