

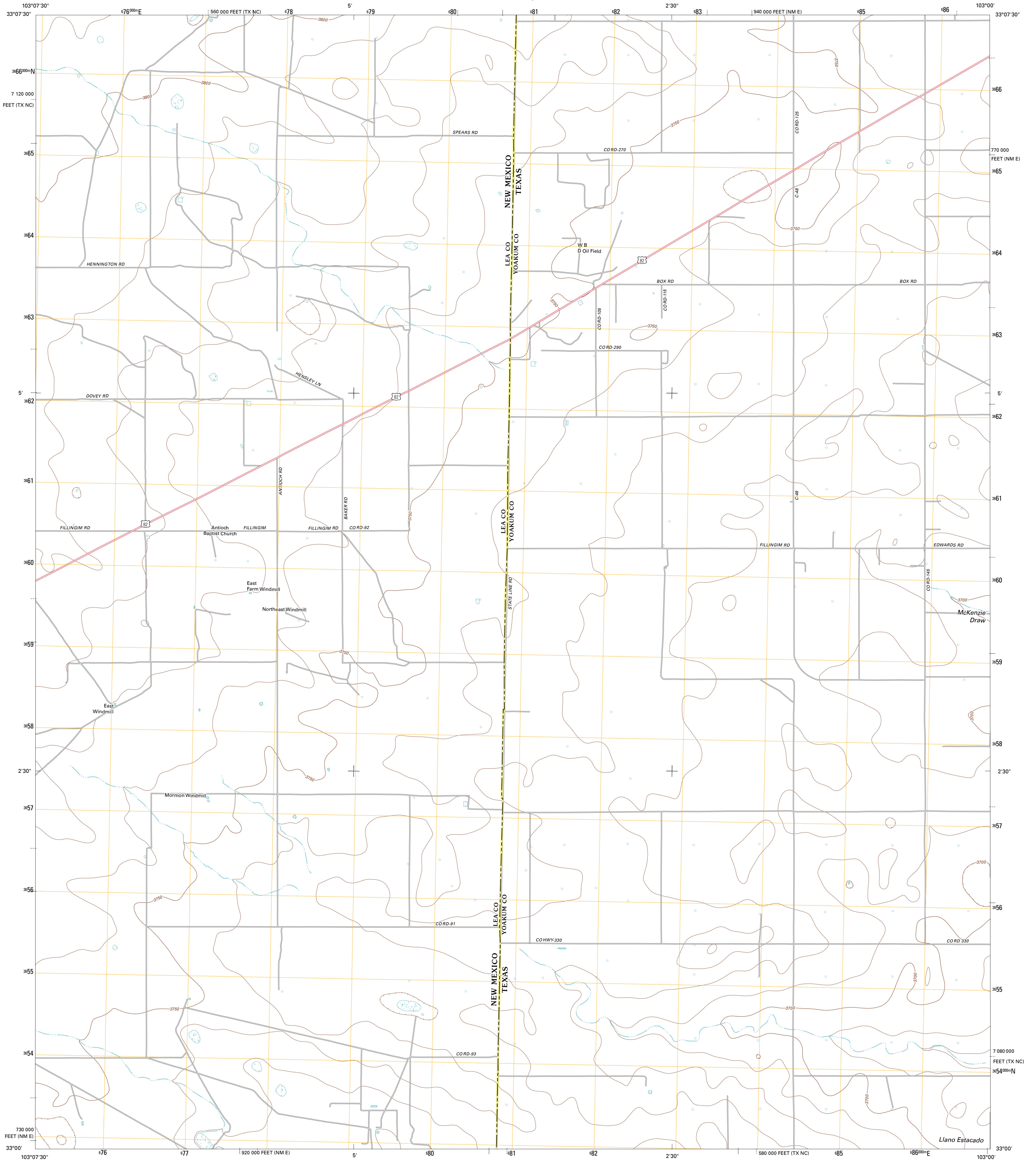

U.S. DEPARTMENT OF THE INTERIOR
U. S. GEOLOGICAL SURVEY



PRAIRIEVIEW SE QUADRANGLE
TEXAS-NEW MEXICO
7.5-MINUTE SERIES



Produced by the United States Geological Survey
North American Datum of 1983 (NAD83)
World Geodetic System of 1984 (WGS84). Projection and
1 000-meter grid: Universal Transverse Mercator, Zone 13S
10 000-foot ticks: Texas Coordinate System of 1983 (north
central zone), New Mexico Coordinate System of 1983 (east
zone)

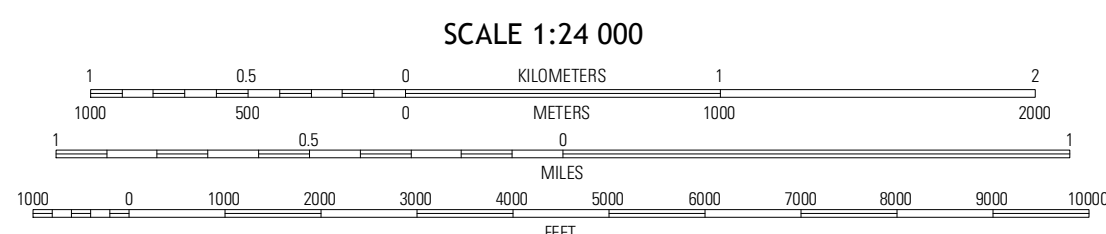
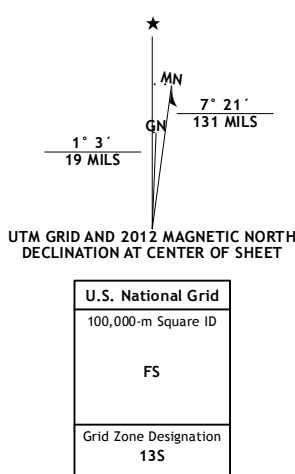

CONTOUR INTERVAL 10 FEET
NORTH AMERICAN VERTICAL DATUM OF 1988
This map was produced to conform with the
National Geospatial Program US Topo Product Standard, 2011.
A metadata file associated with this product is draft version 0.6.7



QUADRANGLE LOCATION

Prairieview NW	Prairieview NE	Plains NW
Prairieview	Prairieview SE	Ink Basin
Humble City NW	Humble City NE	Magalloway

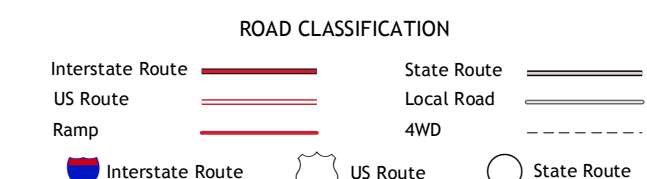

PRAIRIEVIEW SE, TX-NM
2012