

U. S. G. S.  
**FILE COPY**  
Inspection and Editing.

DEPARTMENT OF THE INTERIOR  
U. S. GEOLOGICAL SURVEY

466-N-IV-W/2-5W/4  
STATE OF TEXAS  
BOARD OF WATER ENGINEERS  
JOHN A. NORRIS, CHAIRMAN  
C. S. CLARK, A. H. DUNLAP  
*Marble Falls 1:62500*

Advance sheet  
Subject to correction

TEXAS  
**MARBLE FALLS QUADRANGLE**

98°30' 30"37'30" 25' 98°22'30" 30'37'30"



(Marble Falls 1:62500)

790 000  
YARDS

TRUE NORTH  
MAGNETIC NORTH  
10°

Glenn S Smith Division Engineer 845 000 YARDS  
Topography by A.W.Plushnick  
Culture and drainage in part compiled from aerial photographs  
taken by Air Corps, U. S. Army  
Control by U. S. Geological Survey  
Surveyed in 1930 and 1931

APPROXIMATE MEAN  
DECLINATION, 1931

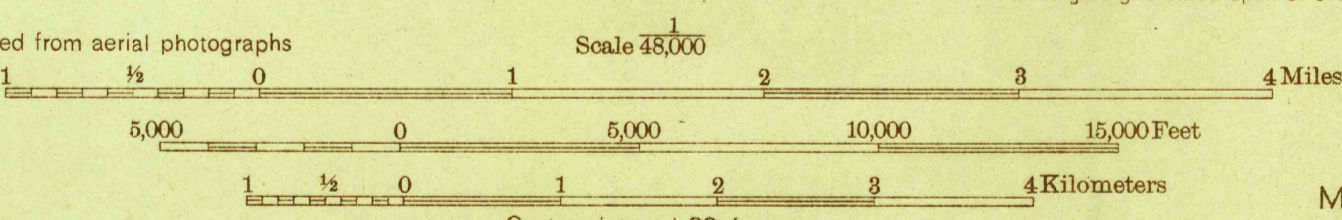

Contour interval 20 feet  
10 foot contours added in dashed lines  
Datum is mean sea level

Polyconic projection. North American datum  
5000 yard grid based upon U. S. zone system. D

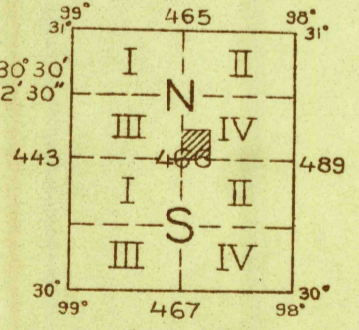

MARBLE FALLS, TEXAS

RETURN TO:  
USGS MAP HISTORICAL MAP ARCHIVES

**FILE COPY**  
1936  
MAP INFORMATION OFFICE  
GEOLOGICAL SURVEY

U. S. G. S.  
**FILE COPY**  
Inspection and Editing.