

Mapped, edited, and published by the Geological Survey
Control by USGS and NOS/NOAA
Topography from aerial photographs by photogrammetric methods
Aerial photographs taken 1958 Field check 1960
Polyconic projection, 1927 North American Datum
10,000-foot grid based on Texas coordinate system,
central and north central zones
1000-meter Universal Transverse Mercator grid ticks,
zone 14, shown in blue
Fine red dashed lines indicate selected fence and field lines
where generally visible on aerial photographs
This information is unchecked
To place on the predicted North American Datum 1983
move the projection lines 13 meters south and
24 meters east as shown by dashed corner ticks

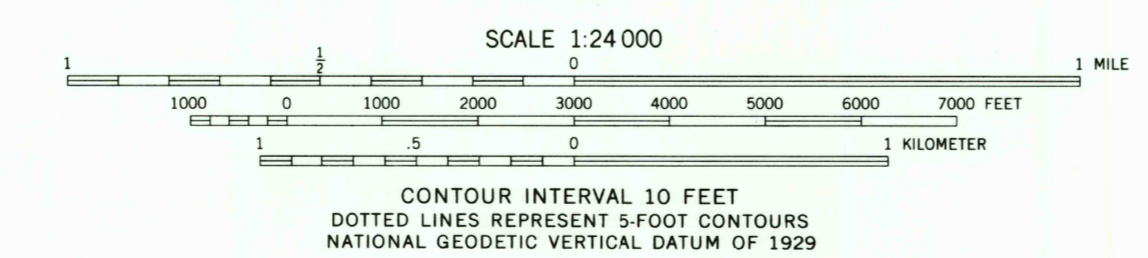
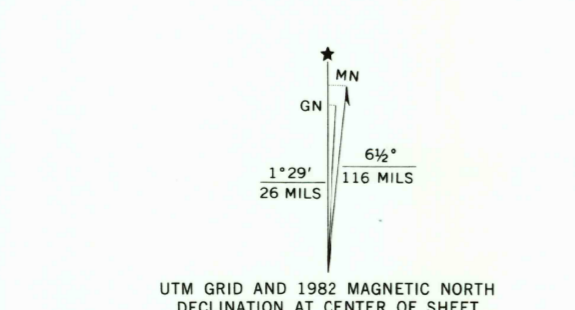

THIS MAP COMPLIES WITH NATIONAL MAP ACCURACY STANDARDS
FOR SALE BY U. S. GEOLOGICAL SURVEY, DENVER, COLORADO 80225, OR RESTON, VIRGINIA 22092
A FOLDER DESCRIBING TOPOGRAPHIC MAPS AND SYMBOLS IS AVAILABLE ON REQUEST

3196-443

WINKLER, TEX.
N3152 5-W9607 5/7.5
1960
PHOTOREVISED 1982
DMA 6747 1 NW-SERIES V882

RETURN TO:
USGS AND HISTORICAL MAP ARCHIVES

JAN 11 1984