

5752 IV SW
ROSS CANYON

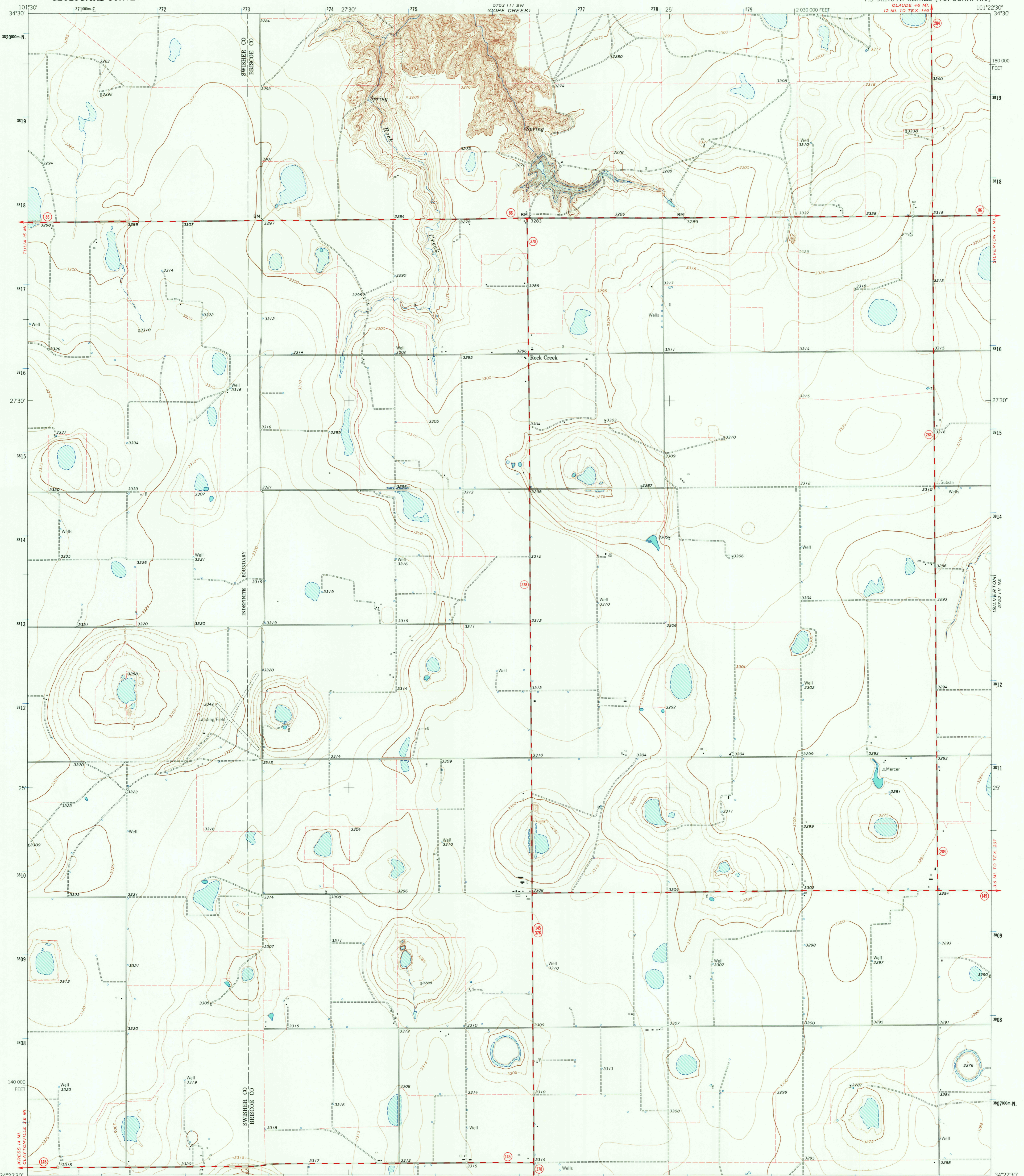

Mapped, edited, and published by the Geological Survey

Control by USGS and USC&GS

Topography by photogrammetric methods from aerial photographs taken 1964. Field checked 1965

Polyconic projection, 1927 North American datum, 10,000-foot grid based on Texas coordinate system, north zone 1000-meter Universal Transverse Mercator grid ticks, zone 14, shown in blue

Fine red dashed lines indicate selected fence lines

Areas covered by dashed light blue pattern are subject to controlled inundation

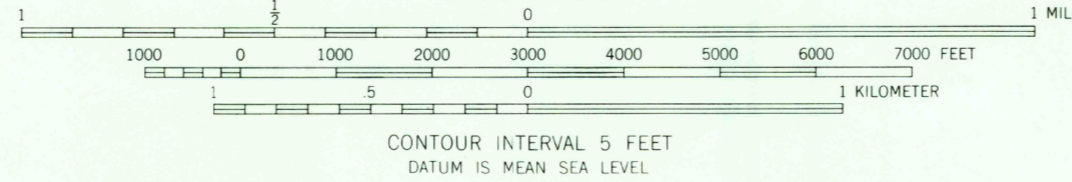
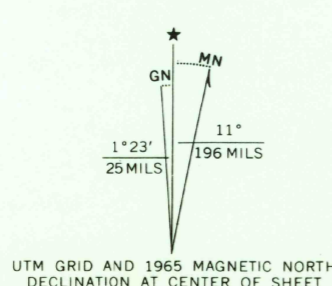

U.S.G.S.
FILE COPY
TOPOGRAPHIC DIVISION

ROCK CREEK, TEX.
N3422 5-W10122 5/7 5

3105
MAY 1 1967

THIS MAP COMPLIES WITH NATIONAL MAP ACCURACY STANDARDS
FOR SALE BY U.S. GEOLOGICAL SURVEY, DENVER, COLORADO 80225, OR WASHINGTON, D.C. 20242
A FOLDER DESCRIBING TOPOGRAPHIC MAPS AND SYMBOLS IS AVAILABLE ON REQUEST

1965
AMS 5752 IV NW - SERIES V882