

Mapped, edited, and published by the Geological Survey
Control by USGS and NOS/NOAA
Topography by photogrammetric methods from aerial photographs taken 1966. Field checked 1967
Polyconic projection. 10,000-foot grid ticks based on Texas coordinate system, central zone. 1000-meter Universal Transverse Mercator grid ticks, zone 14, shown in blue 1927 North American Datum. To place on the predicted North American Datum 1983 move the projection lines 16 meters south and 35 meters east as shown by dashed corner ticks
Fine red dashed lines indicate selected fence lines
Revisions shown in purple and woodland compiled from aerial photographs taken 1979 and other sources. This information not field checked. Map edited 1982

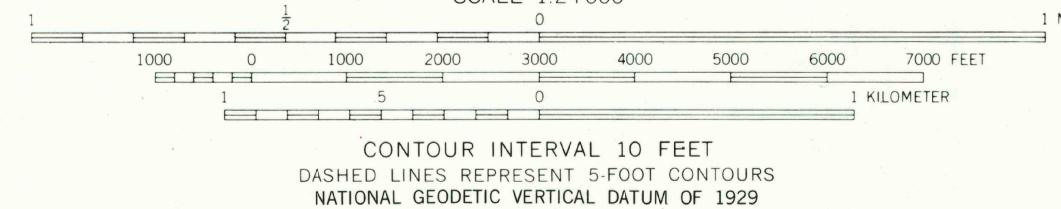
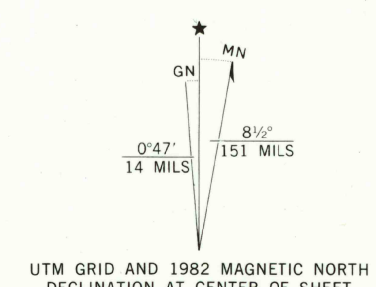

ROAD CLASSIFICATION

Medium-duty	Light-duty
Unimproved dirt	State Route

THIS MAP COMPLIES WITH NATIONAL MAP ACCURACY STANDARDS
FOR SALE BY U. S. GEOLOGICAL SURVEY, DENVER, COLORADO 80225, OR RESTON, VIRGINIA 22092
A FOLDER DESCRIBING TOPOGRAPHIC MAPS AND SYMBOLS IS AVAILABLE ON REQUEST

QUADRANGLE LOCATION
3000-244

DUNBAR DRAW NE, TEX.
N3022.5—W10030/7.5
1967
PHOTOREVISED 1982
DMA 5844 1 NE—SERIES V882

RETURN TO:
USGS AND HISTORICAL MAP ARCHIVES

JAN 1 1983

550