

DEPARTMENT OF THE INTERIOR
FRANKLIN K. LANE, SECRETARY
U. S. GEOLOGICAL SURVEY
GEORGE OTIS SMITH, DIRECTOR

TOPOGRAPHY

HARRIS COUNTY, TEXAS

W. H. WARD, COUNTY JUDGE

W. H. LLOYD, J. A. SMITH, W. H. KISER, D. BARKER
COUNTY COMMISSIONERS

INSPECTION FILE
TOPOGRAPHY
Advance sheet.
Subject to correction.

INSPECTION FILE
TOPOGRAPHY

TEXAS
HARRIS COUNTY
KATY QUADRANGLE

95° 52' 30"

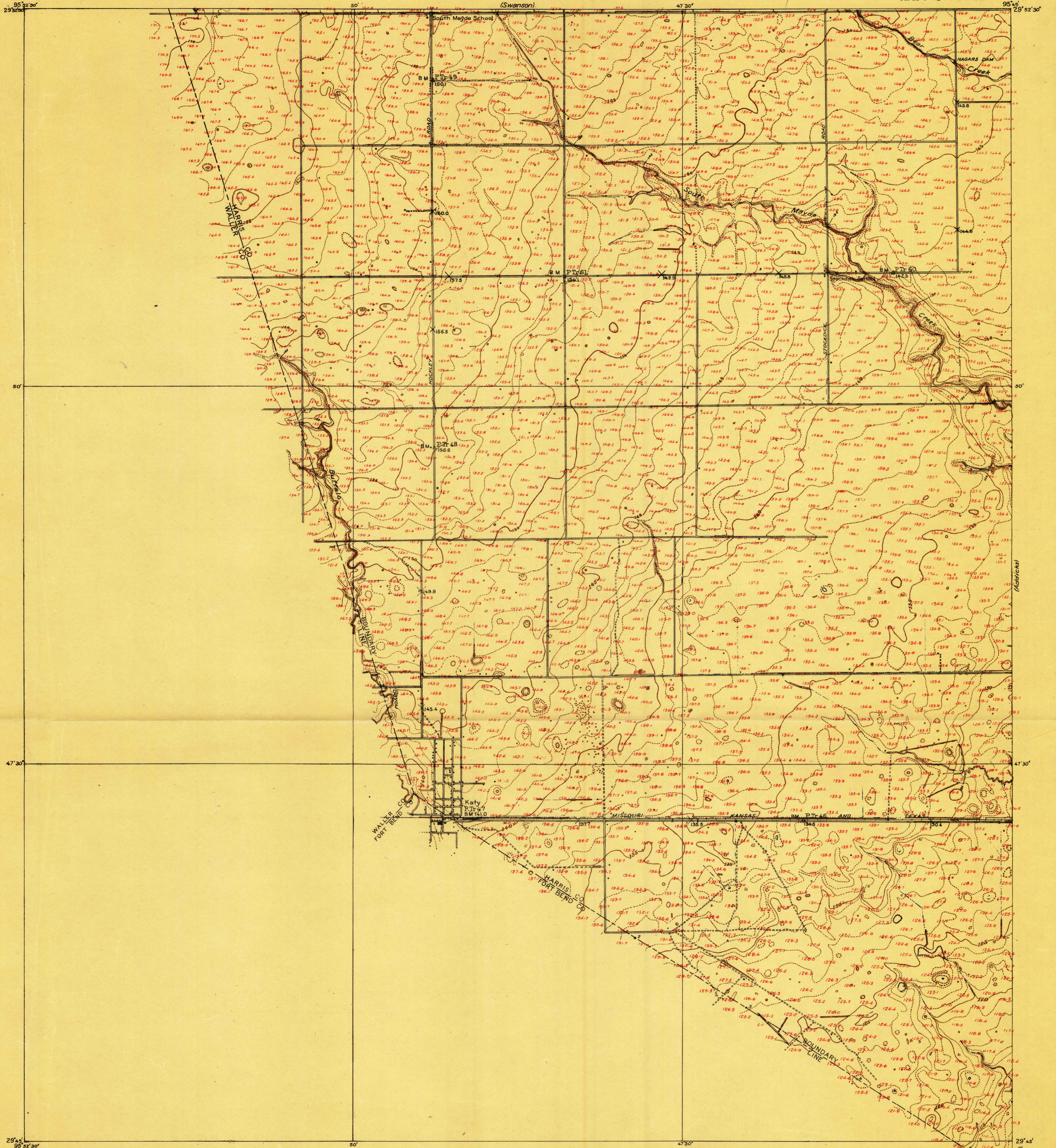

R. B. Marshall, Chief Geographer
Sledge Tatum, Geographer in charge
Topography by J. H. Wilke and T. P. Pendleton
Control by U. S. Coast and Geodetic Survey
E. L. McNair and R. R. Monbeck
Surveyed in 1915
SURVEYED IN COOPERATION WITH HARRIS COUNTY, TEXAS

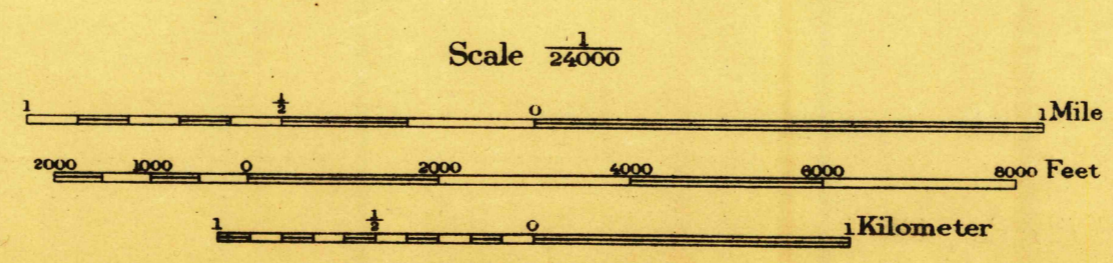
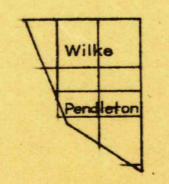

Contour interval 1 foot
Datum is mean sea level

TRUE NORTH
MAGNETIC NORTH
APPROXIMATE MEAN
DECLINATION 1915

Katy, Tex

USGS
Historical File
Topographic Division

95° 45'