

UNITED STATES  
DEPARTMENT OF THE INTERIOR  
GEOLOGICAL SURVEY

PRAIRIEVIEW SE QUADRANGLE  
TEXAS-NEW MEXICO  
7.5 MINUTE SERIES (TOPOGRAPHIC)

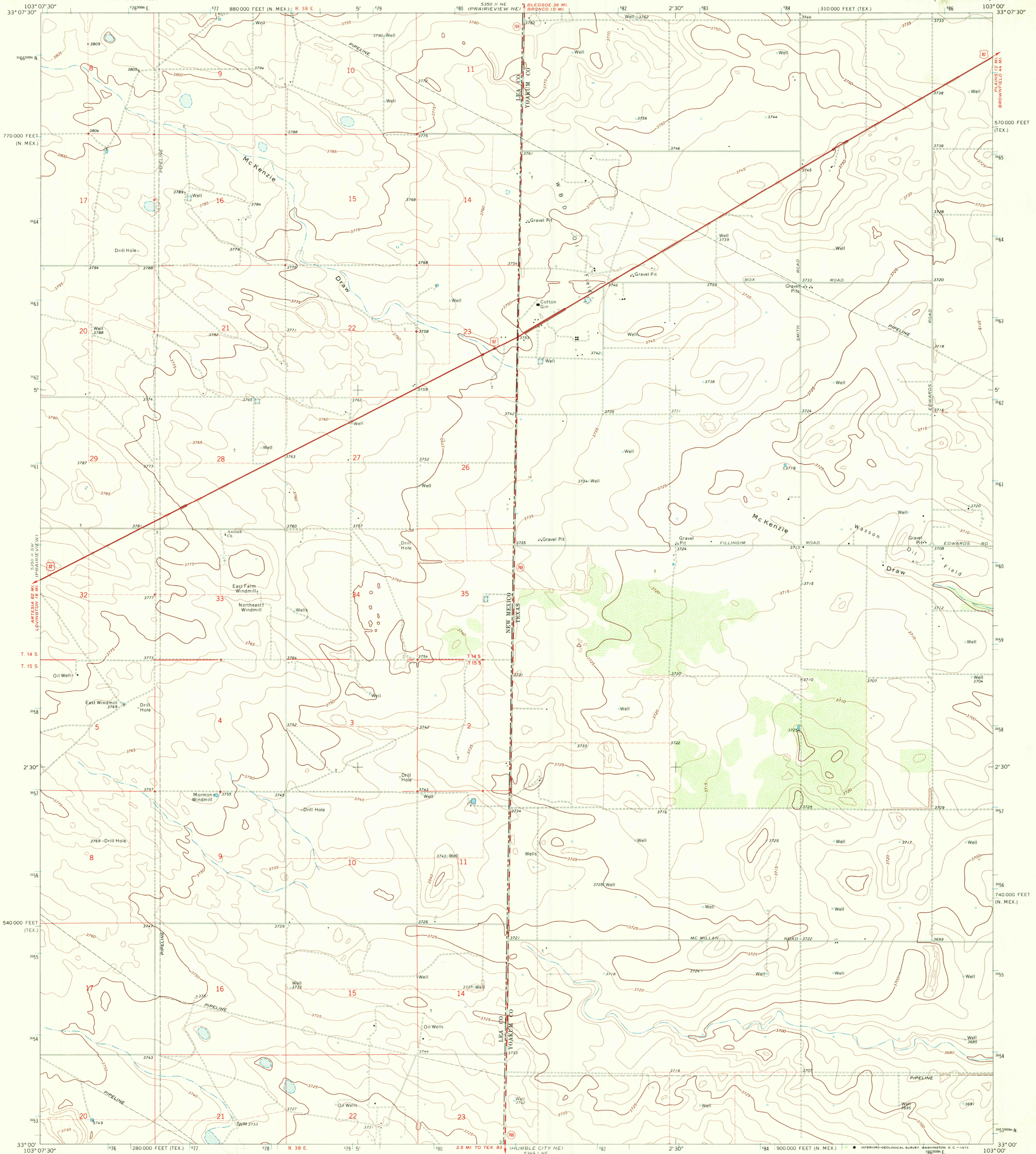

Mapped, edited, and published by the Geological Survey  
Control by USGS and USC&GS  
Planimetry by photogrammetric methods from aerial photographs taken 1968. Topography by planetable surveys 1970.  
Polyconic projection. 1927 North American datum  
10,000-foot grids based on Texas coordinate system,  
north central zone, and New Mexico coordinate system, east zone  
1000-meter Universal Transverse Mercator grid ticks,  
zone 13, shown in blue  
Fine red dashed lines indicate selected fence lines

UTM GRID AND 1970 MAGNETIC NORTH  
DECLINATION AT CENTER OF SHEET

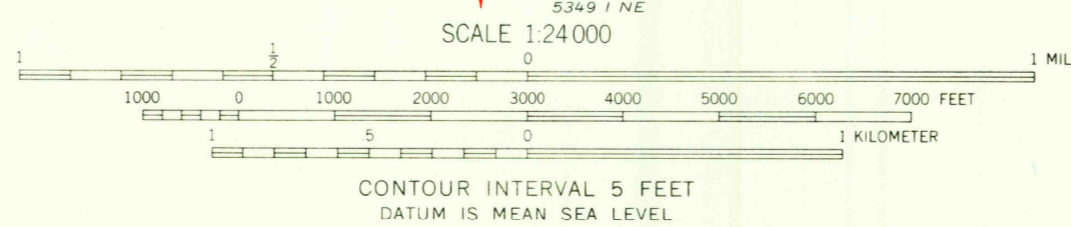

ROAD CLASSIFICATION  
Primary highway, all weather, hard surface  
Secondary highway, all weather, hard surface  
Light-duty road, all weather, improved surface  
Unimproved road, fair or dry weather  
U. S. Route  
State Route

THIS MAP COMPLIES WITH NATIONAL MAP ACCURACY STANDARDS  
FOR SALE BY U. S. GEOLOGICAL SURVEY, DENVER, COLORADO 80225, OR WASHINGTON, D. C. 20242  
A FOLDER DESCRIBING TOPOGRAPHIC MAPS AND SYMBOLS IS AVAILABLE ON REQUEST

USGS  
HISTORICAL FILE  
TOPOGRAPHIC DIVISION

PRAIRIEVIEW SE, TEX.-N. MEX.  
N3300-W10300/7.5

1970  
AMS 5350 II SE-SERIES V881

2795