

Advance sheet
Subject to correction

510-S-IV-W/2-SW/4
STATE OF TEXAS
BOARD OF WATER ENGINEERS
JOHN A. NORRIS, CHAIRMAN
C. S. CLARK, A. H. DUNLAP

TEXAS
(COLLIN COUNTY)
FARMERSVILLE 3-c QUADRANGLE

DEPARTMENT OF THE INTERIOR
U. S. GEOLOGICAL SURVEY

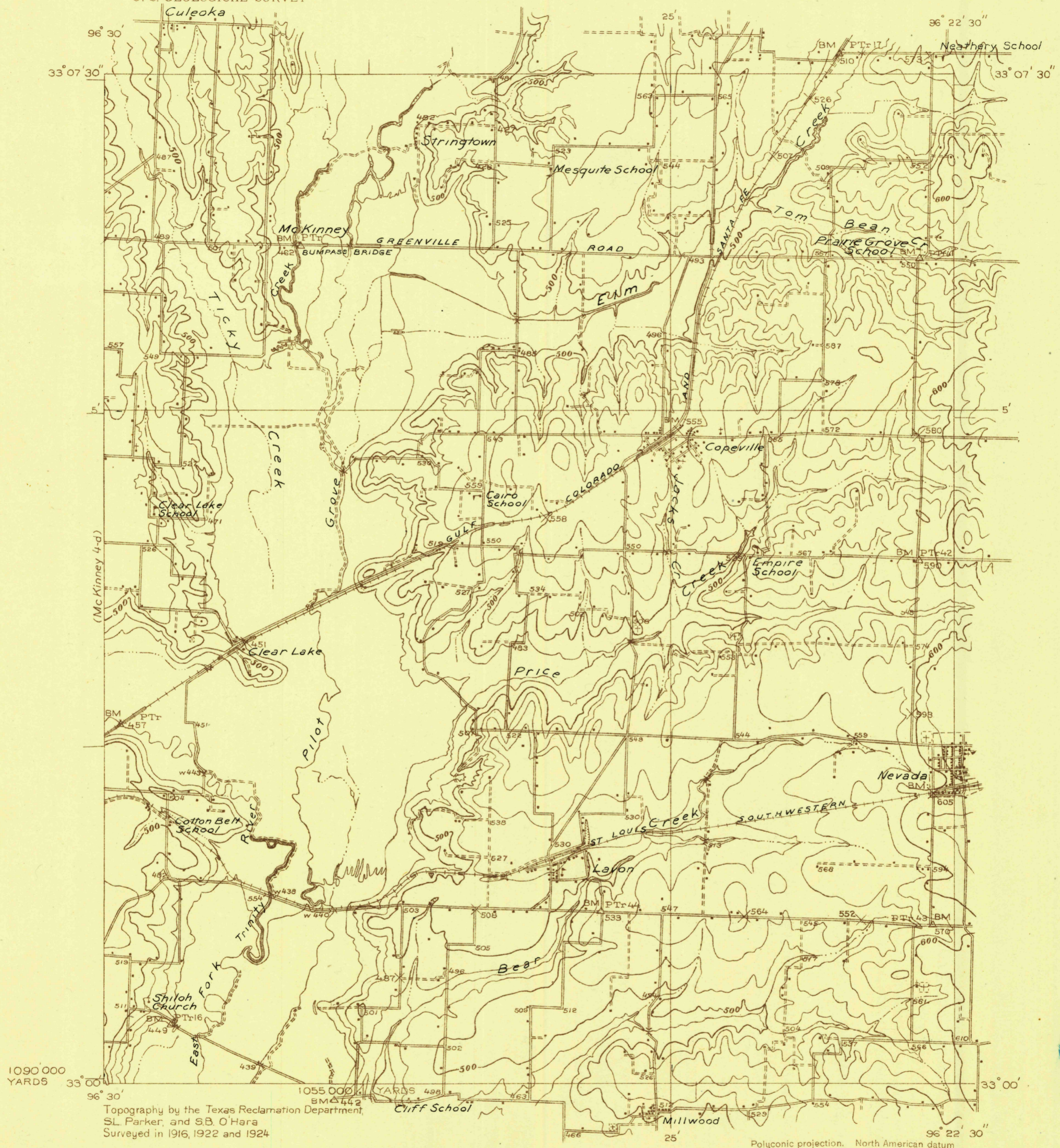

1090 000 YARDS
33° 00'

Topography by the Texas Reclamation Department,
S.L. Parker, and S.B. O'Hara
Surveyed in 1916, 1922 and 1924

Polyconic projection. North American datum
5000 yard grid based upon U. S. zone system, D

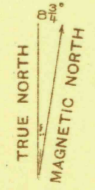
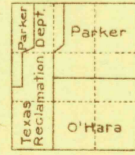

APPROXIMATE MEAN DECLINATION, 1924

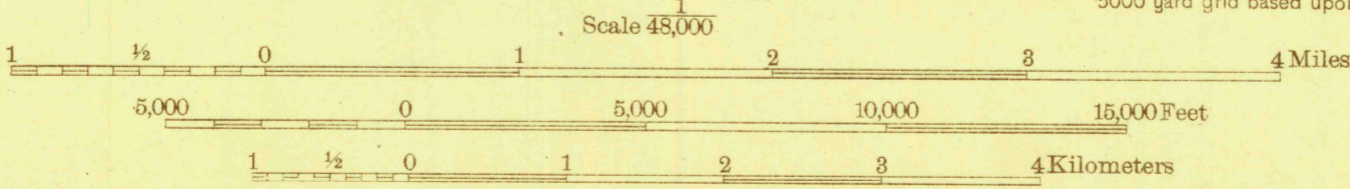

Contour interval 20 feet
Datum is mean sea level

FARMERSVILLE, 3-c, TEX

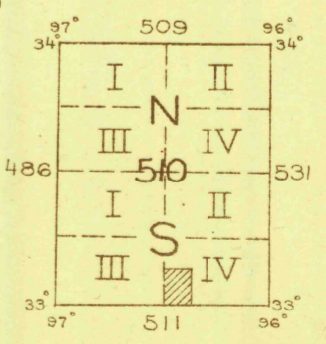

FILE COPY
MAP INFORMATION OFFICE

RETURN TO:
USGS NMD HISTORICAL MAP ARCHIVES

ENGR (with same interval)
but KEEP for extra deus

Aud