

DEPARTMENT OF THE INTERIOR  
U. S. GEOLOGICAL SURVEY

512-S-IV-W/2-NE/4

STATE OF TEXAS  
BOARD OF WATER ENGINEERS  
JOHN A. NORRIS, CHAIRMAN  
C. S. CLARK, A. H. DUNLAP

Advance sheet  
Subject to correction

TEXAS

MARQUEZ NO. 1 QUADRANGLE

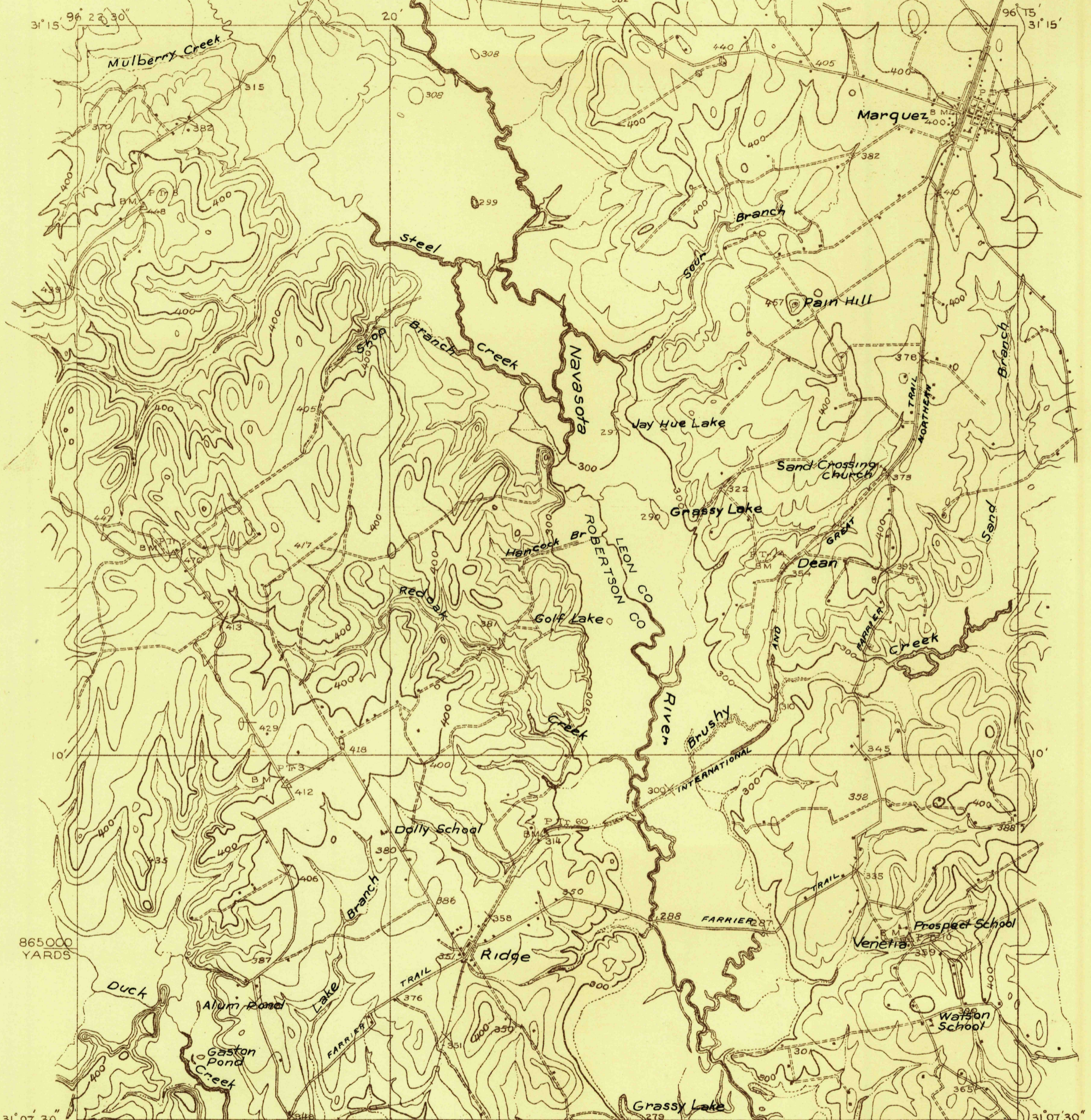

865 000  
YARDS

(Marquez No 4)  
1 070 000 YARDS

Topography by Lee Morrison  
Surveyed in 1924-1925



Contour interval 20 feet  
10 foot contours in dashed lines  
Datum is mean sea level

Polyconic projection. North American datum  
5000 yard grid based upon U. S. zone system, D

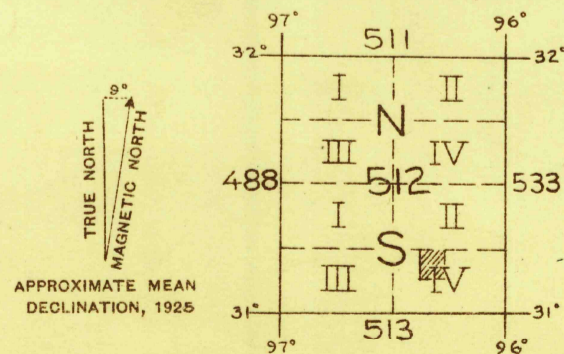

MARQUEZ NO. 1, TEXAS

RETURN TO:  
USGS NMD HISTORICAL MAP ARCHIVES

