

DEPARTMENT OF THE INTERIOR  
U. S. GEOLOGICAL SURVEY

GALVESTON COUNTY, TEXAS  
COUNTY COMMISSIONERS COURT  
E. B. HOLMAN, COUNTY JUDGE  
JAMES A. BODDEKER (PRECINCT 1), HUMPHREY D. BOYD (PRECINCT 2)  
GUS. A. BUTTEROWE, JR. (PRECINCT 3), AND W. T. SMITH (PRECINCT 4)  
C. C. WASHINGTON, COUNTY ENGINEER

TEXAS  
(GALVESTON COUNTY)  
WHITES LAKE QUADRANGLE  
(SOUTH HALF)

Advance sheet  
Subject to correction

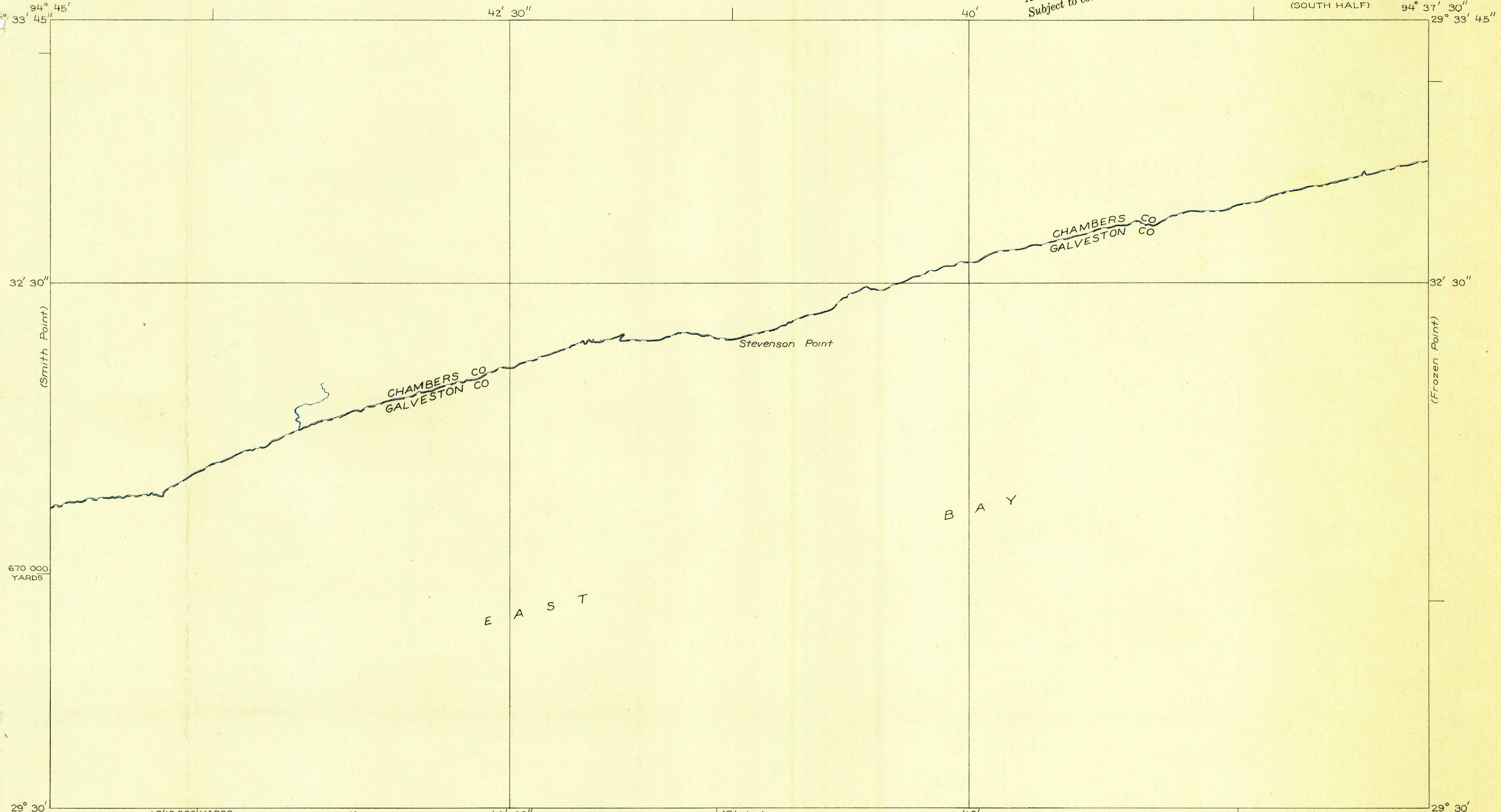

Glenn S. Smith, Division Engineer  
Shore line from U. S. Coast and Geodetic Survey charts  
Compiled in 1932

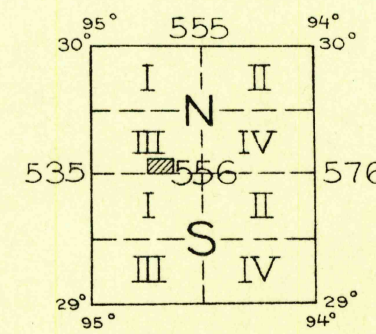
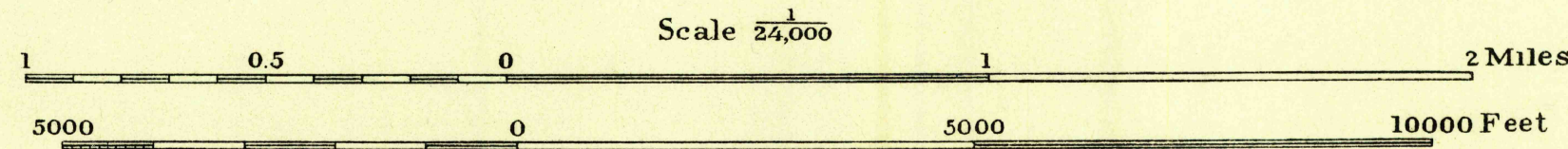
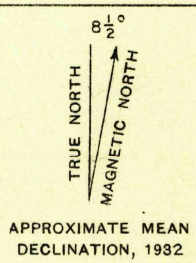

Polyconic projection. North American datum  
5000 yard grid based upon U. S. zone system, D

WHITES LAKE, TEX.