

GALVESTON COUNTY, TEXAS
COUNTY COMMISSIONERS COURT
E. B. HOLMAN, COUNTY JUDGE
JAMES A. BODDEKER (PRECINCT 1), HUMPHREY D. BOYD (PRECINCT 2)
GUS. A. BUTTEROWE, JR. (PRECINCT 3), AND W. T. SMITH (PRECINCT 4)
C. C. WASHINGTON, COUNTY ENGINEER
(Frozen Point)

DEPARTMENT OF THE INTERIOR
U. S. GEOLOGICAL SURVEY

TEXAS
(GALVESTON COUNTY)
~~PATTON~~ QUADRANGLE
CAPLEN (NORTH HALF)

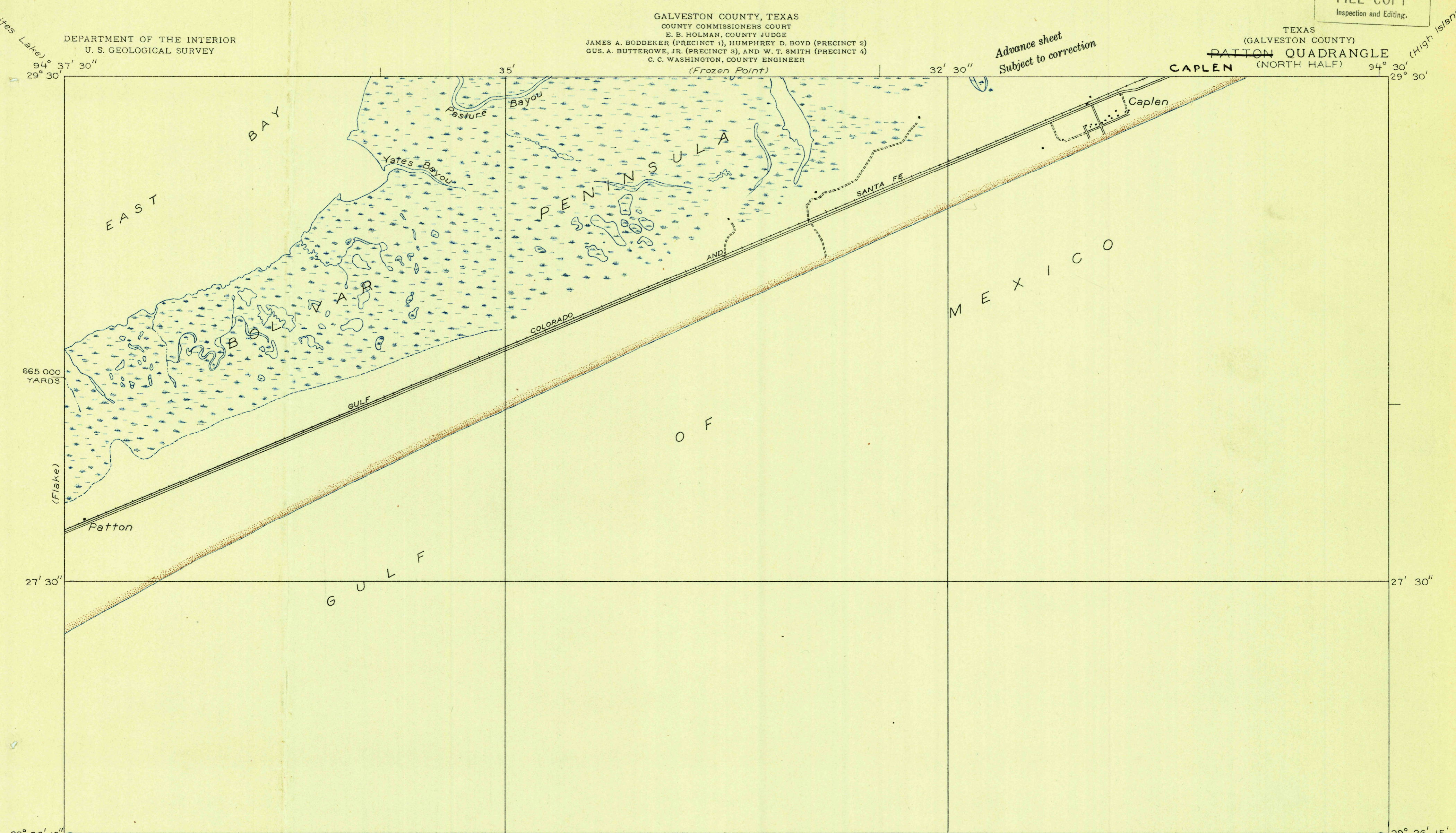

Advance sheet
Subject to correction

Whites Lake)
94° 37' 30"
29° 30'

(High Island)
94° 30'
29° 30'

(The Jetties)
94° 37' 30"
29° 26' 15"

94° 30'
29° 26' 15"

Glenn S. Smith Division Engineer
Culture and drainage compiled from aerial photographs
taken by Air Corps, U. S. Army (Contours not mapped)
Control by U. S. Coast and Geodetic Survey and
Corps of Engineers, U. S. Army
Compiled in 1931

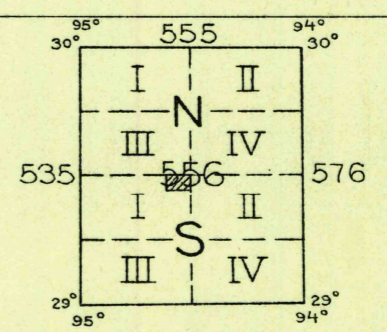
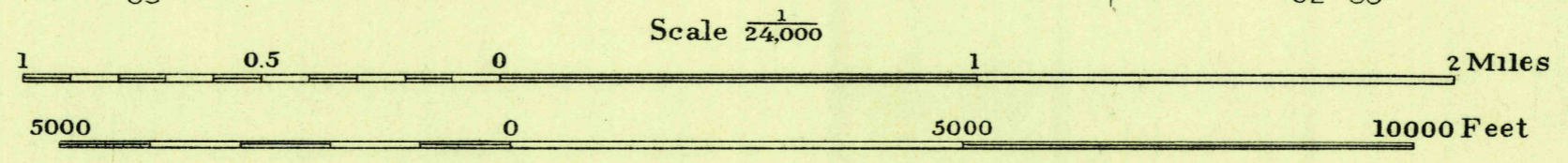
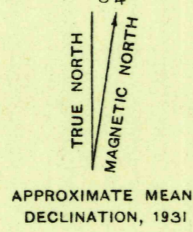

Polyconic projection. North American datum
5000 yard grid based upon U. S. zone system, D

PATTON, TEX.
CAPLEN