

5856 11 NE  
124UJZ

UNITED STATES  
DEPARTMENT OF THE INTERIOR  
GEOLOGICAL SURVEY

STATE OF TEXAS  
TEXAS WATER DEVELOPMENT BOARD

CACTUS EAST QUADRANGLE  
TEXAS  
7.5 MINUTE SERIES (TOPOGRAPHIC)

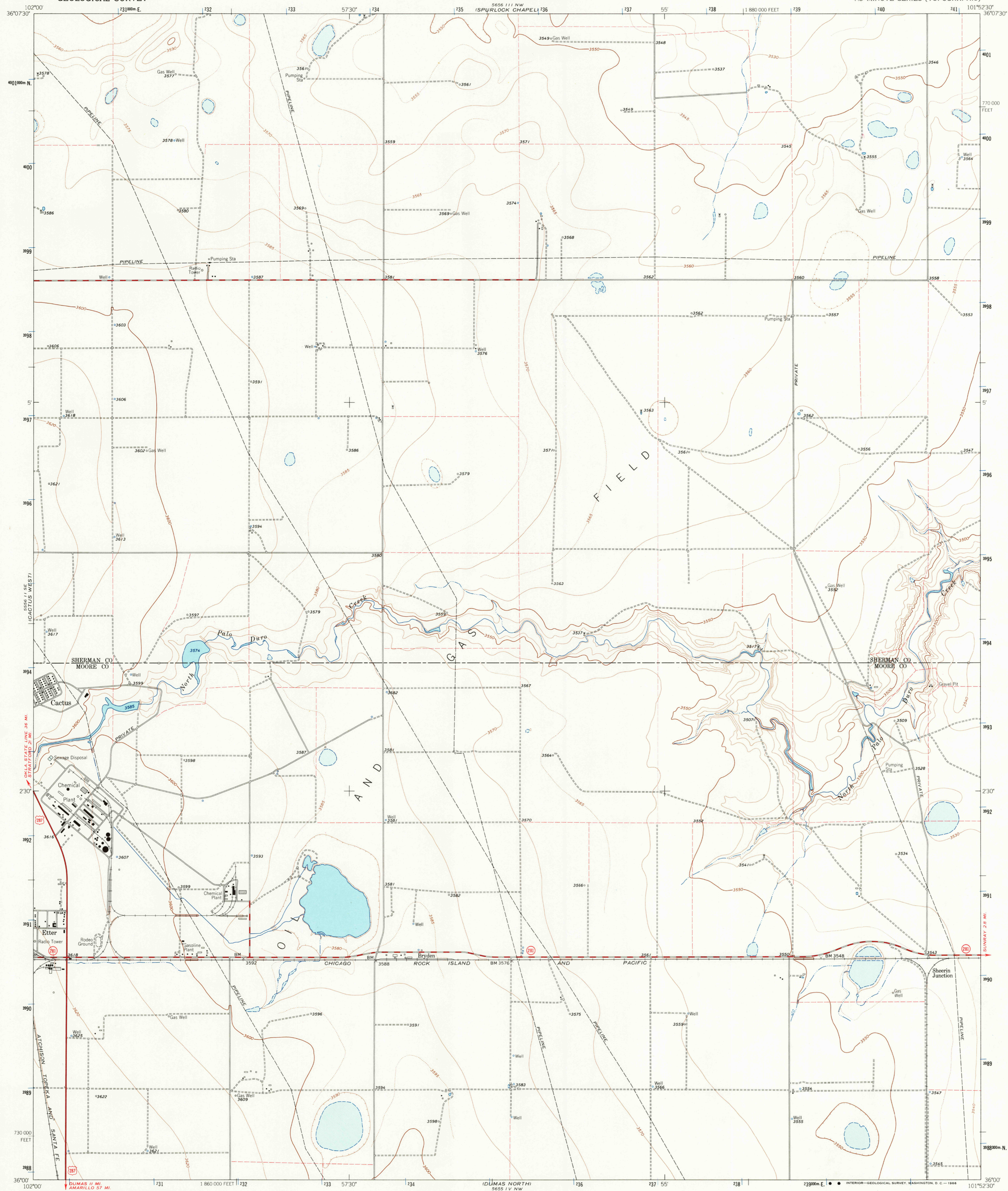

Mapped, edited, and published by the Geological Survey  
Control by USGS and USC&GS  
Topography by photogrammetric methods from aerial photographs taken 1962 and planetable surveys 1963  
Polyconic projection. 1927 North American datum 10,000-foot grid based on Texas coordinate system, north zone 1000-meter Universal-Transverse Mercator grid ticks zone 14, shown in blue  
Fine red dashed lines indicate selected fence lines

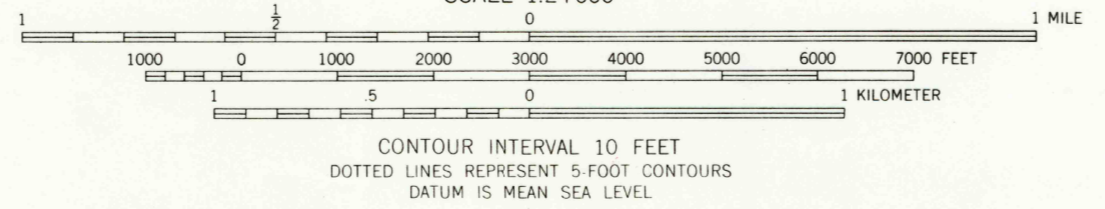
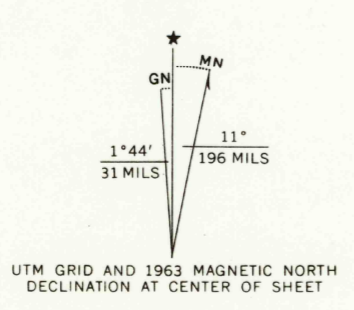

ROAD CLASSIFICATION

|             |                 |
|-------------|-----------------|
| Heavy-duty  | Light-duty      |
| Medium-duty | Unimproved dirt |
| U.S. Route  | State Route     |



QUADRANGLE LOCATION

U.S.G.S.  
FINE COPY  
TOPOGRAPHIC DIVISION

CACTUS EAST, TEX.  
N3600-W10152.5/7.5  
1963  
AMS 5656 111 SW-SERIES V882

THIS MAP COMPLIES WITH NATIONAL MAP ACCURACY STANDARDS  
FOR SALE BY U.S. GEOLOGICAL SURVEY, DENVER, COLORADO 80225, OR WASHINGTON, D. C. 20242  
A FOLDER DESCRIBING TOPOGRAPHIC MAPS AND SYMBOLS IS AVAILABLE ON REQUEST

2250  
NOV 21 1963