

ADVANCE SHEET
467-N-II-W/2
(Blanco 1:125,000)

CORPS OF ENGINEERS, U. S. ARMY
PROGRESSIVE MILITARY MAP

TEXAS
SMITHSONS VALLEY QUADRANGLE

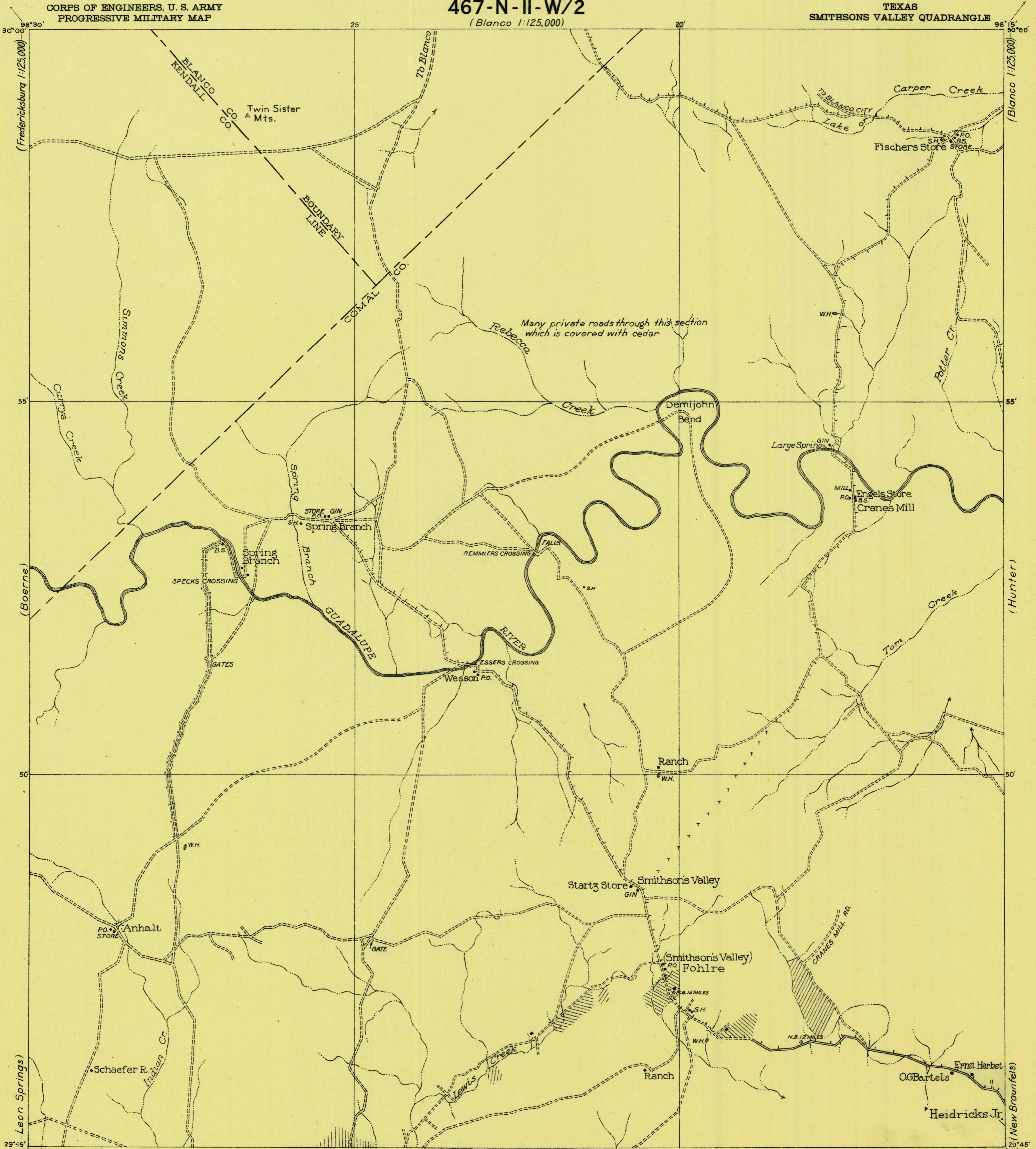

Field work and compilation under the direction of Major R. C. Kuldell, Corps of Engineers, U. S. A., Department Engineer, Southern Department.
Field work under the immediate supervision of 1st. Lieut. F. L. Weeks, Engineer Reserve Corps, in charge of military mapping.
Control; U. S. Geological Survey geographic position "Twin Sisters;" road sketch by Capt. W. K. Naylor, 9th Inf., 1908; maps of Kendall & Comal Counties, General Land Office, Austin, Texas; Sheet 467/43 of the Military Map, Department Texas; Dr. R. A. Goeth's Road Map of Fort Sam Houston & Vicinity and Road Map of Comal County by Alfred R. Rothe.

Legend
W.H. Waterhole

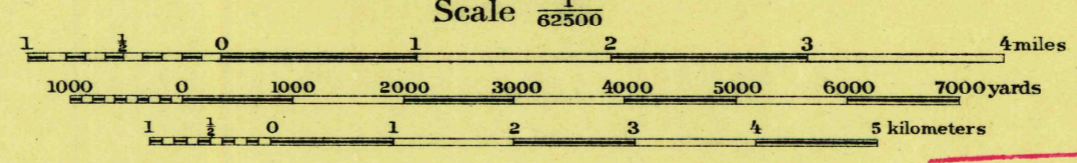

NOTE: OFFICERS USING THIS MAP WILL MARK HEREON CORRECTIONS AND ADDITIONS WHICH COME TO THEIR ATTENTION AND MAIL DIRECT TO "THE CHIEF OF ENGINEERS, WASHINGTON, D.C."

U. S. Dept. of Interior
Div. of Geography
630 CE 1920

Engineer Reproduction Plant, U. S. Army, Washington Barracks, D.C. 1920

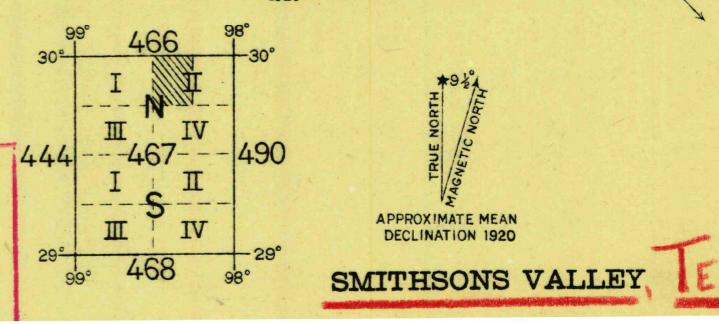

SMITHSONS VALLEY, TEX.