

Dallas County, Texas Probate Cases 1846 – Early 1900's

Case Number 471

Dallas Genealogical Society
Founded 1955

www.dallasgenealogy.org



FILMED BY THE DALLAS GENEALOGICAL SOCIETY - 1977

471

FILMED BY THE DALLAS GENEALOGICAL SOCIETY - 1977

Tax Receipt
 No 1146. \$1.75⁰⁰
 Recd of Ben Merrell for Sarah
 Merrell & xx County Tax &
 200 dollars in full payment
 of his State & County Tax for 1863.
 Dated 21st May 1864.
 John H. Cochran A & C. D. S.

Tax Receipt
 No 1147. \$0.75⁰⁰
 Recd of the Bess & Co Merrell
 for Sarah Merrell 75 cents
 in full payment of their State
 & County Tax rendered for 1863
 Dated 21st May 1864.
 John H. Cochran A & C. D. S.

Tax Receipt
 No 1148. \$0.75⁰⁰
 Recd of Elizabeth Martin for
 Sarah Merrell, 75 cent in
 full payment of her State
 & County Tax rendered
 for 1863. Dated 21st May 1864.
 John H. Cochran A & C. D. S.

July 15th 1867

Receipt of J. G. Williams Esq. of Ben Merrell
 Five Six dollars for hunting up Estray Mare
 & Colt belonging to said Estate
 J. G. Williams

TAX RECEIPT.

No. 129. \$1.14³¹/₁₀₀

Received of Ben Merrell by J. G. Williams Esq
 Fifteen ³¹/₁₀₀ Dollars, in ~~payment~~ in full payment of
 his State and County Tax tendered for the year 1866.
 Dated March 1st 1866.
 John H. Cochran
 Assessor and Collector of Dallas County, Texas.
 HERALD PRINT, DALLAS, TEXAS.

TAX RECEIPT.

No. 130. \$1.79²⁵/₁₀₀

Received of Ben Merrell by J. G. Williams Esq
 Seventeen ²⁵/₁₀₀ Dollars, in ~~payment~~ in full payment of
 his State and County Tax tendered for the year 1866.
 Dated July 2nd 1866.
 John H. Cochran
 Assessor and Collector of Dallas County, Texas.
 HERALD PRINT, DALLAS, TEXAS.

Tax Receipt—Property in the County.

No. 1653. \$1.18

Received Oct 31st 1867
 dollars and 18 cents from
 J. G. Williams Esq Ben Merrell State and County Taxes for 1867, on
 property in this County, as per Assessment ~~Rolls~~ of that year.
 Ad Valorem, \$1.12. Salary, \$...
 Income, \$... Poll, \$... A & C. Dallas Co.
 County Tax, \$1.09

Tax Receipt—Property in the County.

No. 131. \$2.014

Received Twenty dollars and ~~four~~ cents from
 J. G. Williams Esq Ben Merrell State and County Taxes for 1867, as
 per Assessment Rolls of that year.
 Ad Valorem, \$1.07. Salary, \$...
 Income, \$... Poll, \$... A & C. Dallas Co.
 County Tax \$1.17

July 1st 1867

The Estate of Ben Merrill to E. Lanckford Dr \$
• 14 Season of three Haws Eight Dollars each \$24.00

I do solemnly swear that the above account
against the Estate of Ben Merrill Deed is
Just due and owing & that all legal
efforts & credits known to affiant have been
made to help me God

Witness my hand & seal
this 27th day of March 1868

Saml. H. Gilbert

Justice of the Peace

Received, Dallas, Texas, February 26th,
1868, from J. C. Williams, Administra-
tor of the estate of Ben Merrill, dec'd,
Five \$5,000 Dollars, Specie, in full for
advertising in Dallas Herald, original
notice of administration, Dec. 27 1865
\$500
Jno. W. Swinself

The Heirs of Ben Merrill Deed
To
John H. Cochran Dr
For buying sale 20th Feb 1866. \$37.00

Received payment in full on the above of
this 16th day of July 1866.
John H. Cochran

THE STATE OF TEXAS,
County of Dallas.

TO THE SHERIFF OF DALLAS COUNTY---GREETING:

YOU ARE HEREBY COMMANDED TO CITE

Samuel S. Marshall
deceased one of the heirs at law of *Ben Marshall*
deceased

to be and appear at the next term of the County Court, to be holden at the Court-house in the town of Dallas, on the last Monday in *February* A. D. 1867, then and there to show cause, if any, why

the Petition of Sarah S. Marshall and Robert S. Marshall ~~as~~ *in his* ~~own~~ *name* as *officer* for *partition and distribution of the Estate of Ben Marshall deceased* should not be granted.

And have you then and there this writ. Herein fail not, but due return make as required by law.

Given under my hand, and the Seal of the County Court, this, the *1st* day of *February* A. D. 1867.

Wm. B. Thomas
Clerk of the County Court of Dallas County, Texas.

Ellis I want to see you personally before you pass on those papers that I may explain to you some things
J. C. Williams

7851.00
7771.50
7844
50
21.50

7851.00
7821.00
29

7821.50

Received on the within account of \$ 95-
27 Nov 15th 1867 *G. X. Lankford*

Received of J. C. Williams Executor of Ben Marshall Estate
Twenty dollars & five cents being the amt in full of the within account G. X. Lankford
Attch

7851.00

7800

copy 28 to 1867
I accept service of writ
with
Sam & Merrill
by his agent
R B Merrill

County Court
In & Citation
Samuel S. Merrill
Issued Feby 5th / 67
Jas P. Thomas Clerk
original returned
caught to him Feb 6 / 67
Returned Feb 22nd on
Feb 1867. Samuel S
& Merrill not found
in Dallas County
Feb 1867
I herby

Filed Feby 22 1867
Jas. P. Thomas Clk

THE STATE OF TEXAS,
County of Dallas.

TO THE SHERIFF OF DALLAS COUNTY---GREETING:
YOU ARE HEREBY COMMANDED TO CITE Nancy E
Merrill one of the heirs at Law of Ben Merrill
deceased

to be and appear at the next term of the County Court, to be holden at the Court-house
in the town of Dallas, on the last Monday in February A. D. 1867,
then and there to show cause, if any, why the Petition of Sarah A
Merrill and Sarah B Merrill now on file in my
office for Partition and distribution of the Estate of
Ben Merrill deceased should not be granted
And have you then and there this writ. Herein fail not, but due return make as required
by law.

Given under my hand, and the Seal of the County
Court, this, the 5th day of February
A. D. 1867.

Jas. P. Thomas
Clerk of the County Court of Dallas County, Texas.

~~Feb 2 1867~~
~~I accept~~
~~to writ~~
S J Merrill
R B Merrill
his agent

THE STATE OF TEXAS,
County of Dallas.

TO THE SHERIFF OF DALLAS COUNTY---GREETING:

YOU ARE HEREBY COMMANDED TO CITE Lucy Lee

Measell one of the heirs at Law of Ben Measell
deceased

to be and appear at the next term of the County Court, to be holden at the Court-house
in the town of Dallas, on the last Monday in February A. D. 1867,
then and there to show cause, if any, why the Petition of Sarah A
Measell and Robert B Measell now on file in my
office for Partition and distribution of the Estate
of Ben Measell deceased should not be granted
And have you then and there this writ. *Hecum fail not, but due return make as required*
by law.

Given under my hand, and the Seal of the County
Court, this, the 15th day of February
A. D. 1867.

Jas P Thomas
Clerk of the County Court of Dallas County, Texas.

Ben merrill Dr to P. H. Lively
fourteen dollars for breeding
two mares to Jack Sprille
10th 1863

The State of Texas } Personally appeared before
Dallas County } me J. P. Bryan a Justice
of the Peace in and for said
County of Dallas P. H. Lively who being duly
sworn deposes and says that the above
and foregoing claim or account is justly
due him and that all debts and credits
or payments have been allowed

P. H. Lively

sworn and subscribed
to this 15th day of February
1866 J. P. Bryan J. P.

County Court
28th Session
February 8th 1867

Ben Measell
Jas P Thomas Clerk

Original

Cause to stand Feb 4th 1867

Decree entered by J. P. Bryan

to J. P. Bryan

a true copy of this

writ shall be given to

16th day of Feb 1867

J. P. Bryan

J. P. Bryan

Filed Feb 22 1867

Jas P Thomas Clerk

Feb 190

THE STATE OF TEXAS.)
County of Dallas.

TO THE SHERIFF OF DALLAS COUNTY---GREETING:

YOU ARE HEREBY COMMANDED TO CITE Alba

Messell one of the heirs at Law of Ben Messell
deceased.

to be and appear at the next term of the County Court, to be held at the Court-house
in the town of Dallas, on the last Monday in February A. D. 1867,
then and there to show cause, if any, why the Petition of Sarah C.
Messell and Robert B. Messell now on file in
my office for partition and distribution of the Estate
of Ben Messell deceased should not be granted
And have you then and there this writ. Writ fail not, but due action make us required
by law.

Given under my hand, and the Seal of the County
Court, this, the 5th day of February
A. D. 1867.

Jas. G. Thomas

Clerk of the County Court of Dallas County, Texas.

Accepted Feb 9th 1867

J. G. Williams

Executor

Approved this 15th
of Sept 1867

Ellis Corum,

County Judge

D. C. J.

April 19th 1867.

Received of J. G.

Williams Exr of the Estate of
Ben Messell Fourteen dollars

in full of the within account

P. H. Sively

County Court
23 Feb 1867
+ Lucy See Messell
Sec'd by S-1867
also 8 months as all

Original
Came to hand Feb 6 '67
VCL entered by leaving
a true copy of this
in Court at 11
residence of Lucy
See Messell on the
16th day of Feb 1867
J. H. Brown
Sho

Filed Feb 23 1867
Jas. G. Thomas

Apr 19

THE STATE OF TEXAS,)
County of Dallas.)

TO THE SHERIFF OF DALLAS COUNTY---GREETING:

YOU ARE HEREBY COMMANDED TO CITE Eli F. Merrill
one of the heirs at Law of Ben Merrill deceased

to be and appear at the next term of the County Court, to be holden at the Court-house
in the town of Dallas, on the last Monday in February A. D. 1867,
then and there to show cause, if any, why the Petition of Sarah M.
Merrill and Robert B. Merrill now on file in my
office for Partition and distribution of the Estate of
Ben Merrill deceased should not be granted
And have you then and there this writ. Herein fail not, but due return make as required

Given under my hand, and the Seal of the County
Court, this, the 5th day of February
A. D. 1867.

Das. P. Thomas
Clerk of the County Court of Dallas County, Texas.

THE STATE OF TEXAS,)
County of Dallas.)

TO THE SHERIFF OF DALLAS COUNTY---GREETING:

YOU ARE HEREBY COMMANDED TO CITE Sarah M.
Merrill one of the heirs at Law of Ben
Merrill deceased

to be and appear at the next term of the County Court, to be holden at the Court-house
in the town of Dallas, on the last Monday in February A. D. 1867,
then and there to show cause, if any, why the Petition of Sarah M.
Merrill and Robert B. Merrill now on file in my
office for Partition & distribution of the Estate of
Ben Merrill deceased should not be granted
And have you then and there this writ. Herein fail not, but due return make as required
by law.

Given under my hand, and the Seal of the County
Court, this, the 5th day of February
A. D. 1867.

Das. P. Thomas
Clerk of the County Court of Dallas County, Texas.

County Court
vs. S. M. Merrill
+ Ella Merrill
Served copy 5-10-1867
Das. P. Thomas clerk
original
Came to hand - Feb 6 / 67
Presented by returning
to Ella Merrill a true
copy of this citation
on the 16th day of Feb
1867
J. B. Bryson
Sheriff

Filed Feb 23 1867
Das. P. Thomas Clerk

Feb 1867

Ben Merrill, decd.

1863. In ops with A. J. Neary
 To amt of Balance due on settlement to be
 paid in wheat at \$4.25 per bushel \$72.00.

I John B. Bachman do solemnly swear that the above
 account against the Estate of Ben Merrill deceased
 and its favor of \$72.00 is just due and owing
 on a settlement made by myself for the said may
 with the said Ben Merrill and that I was duly
 authorized to make the settlement, and that all
 legal effects payments, and credits known to exist
 was allowed,

sworn to & subscribed J. B. Bachman

before me this 22nd day of Feb 1867

Jas. B. Thomas Clerk

County Court
 2^d & citation
 Josephine E. Merrill
 Issued Feb 5th 1867
 Jas & Thomas CLK
 Original
 Given to hand Feb 6th 1867
 & executed by delivering
 to Josephine E. Merrill
 a true copy of this
 citation on the 16th
 Day of Feb 1867
 J. B. Brown
 Sheriff

Filed Feb 22/67
 Jas & Thomas CLK

fee 750

County Court
 2^d & citation
 Cali F. Merrill
 Issued Feb 5th 1867
 Jas & Thomas CLK
 Original
 Given to hand Feb 6th 1867
 & executed by delivering
 to Cali F. Merrill a true
 copy of this citation
 on the 16th Day of Feb 1867
 J. B. Brown
 Sheriff

Filed Feb 22 1867
 Jas & Thomas CLK

fee 150

Ben Mcerrall

Sept 19 1863	To C L Bailey	100
" "	" Repairs on Sillyards	100
Oct 10	" Repairs on gun	5.00
Dec 24	" 2 knives \$3.00 each	6.00
" "	" upsetting ax	1.50
" "	" Straps for saddle	3.00
		\$16.50

State of Texas } This day appears C. L. Bailey,
 Dallas County, } and makes oath in due
 form of law that the above account of
 sixteen $\$16.50$ dollars is just and unpaid
 and that all just credits and offsets
 have been allowed.

Sworn to before me this
 May 16th 1864

C. L. Bailey

J. H. Gilbert - J.P.
 Received in full the above account Nov 26th 1864

C. L. Bailey

20 is drawn by remittance at the amount

Ben Mcerrall
 In cop with
 C. L. Bailey

Accepted April 16th 1867
 J. C. Williams

Approved May 6th 1867
 Captain Dallas

J. Allen
 County Clerk
 D. C. T.

Received payment in
 full June 14th 1867
 M. A. May

No. 8

THE STATE OF TEXAS.

To all persons interested in the Estate of Ben Merrill dec'd
W. Williams Ex of the Estate of Ben Merrill
deceased has filed in the District Court of Dallas County
~~application for~~ an account of the Estate of Ben
Merrill dec'd which will be heard at the next Term of said Court,
 commencing on the first Monday in February, A. D. 1872, at the Court House thereof,
 in the Town of Dallas, at which time all persons interested in the Estate
 of said Ben Merrill dec'd
 may appear and contest said application, if they see proper.

WITNESS: JOHN M. LAWS, Clerk of the District Court of Dallas County.

Given under my hand and the Seal of said Court, at office
 in Dallas, this 8th day of January
 A. D. 1872

Clerk of the District Court of Dallas County, Texas.

By J. C. Couches Deputy.

Ben Merrill
W. Williams
No-19

(19.)

Collector's Office,

4th District, State of Texas

Div. No. 5

January 17th 1869.

Mr. S. K. Williams Adm^r To The United States, Dr.
Dallas

(FOR INTERNAL REVENUE.)

	RATE	AMOUNT TAX.
Tax on Income for the year 1867. Amount, \$ <i>Legacy amount \$94.64</i>	5 PER CENT.	94 64
Tax on the following articles, for the year ending March 1, 1868:		
Billiard Tables, kept for private use		
Carriages		
Plate, or		
Sold Watches		

Amount of Tax \$ 94.64

Penalty 5 per cent. 4.73

Total \$ 99.37

Received Payment,
Saml. Finney
Dep^y Collector.

The undersigned hereby certifies that the above is a true and correct copy of the original as filed in the office of the County Clerk of Dallas County, Texas.

The Williams
 Notice of
 2nd filing of final
 Account
 Ben Merrill recd

Issued Jan 18th 1873
 W. H. Law, Atty
 By J. E. Coombes, Deputy

Came to hand Jan 18th 1872
 By ordering this notice published
 in the Dallas Herald a news paper
 published in the City of Dallas Dallas
 County Tex for four successive
 weeks & by having a true copy
 of this article and the Court House
 door one on the post office door
 at home & one on the post office
 door in the town of Los Capitan
 the same being three of the
 most public places in Dallas
 County Jan the 10th 1872
 J. W. Brown
 Sheriff - Herald
 Fee 13.00

May 1st 1866

The Estate of Ben Merrill to J. Lankford Dr
 1/2 Season of four Mares \$5. Each \$20.00

I do solemnly swear that the above account
 against the Estate of Ben Merrill Dried is just
 due and owing and that all legal effects
 & credits known to affiant have been made
 So help me God

Sworn to & subscribed before me

this 25th March 1866

J. W. Gilbert
 Justice of the Peace

By his
 J. Lankford

[A large, dark, heavily stained and illegible piece of paper with faint handwriting, possibly a ledger or account book page.]

Benjamin Merrill
vs
Geo. W. Davis
 May 25th 1866 According and from W. Carter Esq. \$3.50
 The State of Texas Personally appeared before the
 County of Dallas, sundry persons, Geo. W.
 Davis, and being duly sworn according to
 law, say that the above bill for \$3.50
 & 1/2 cts. Dollars, against the Estate of Ben Merrill
 is just and unpaid, and that all legal rights,
 credits and demands have been allowed
 known to affiant.
 Geo. W. Davis
 Subscribed before
 me this 1st day of January 1866.
 John C. Thomas J. C.

Received of J. C. Williams Esq of
 the Estate of Ben Merrill Dec Twenty
 Six dollars in us currency in full payment
 of the within account
 March 28th 1868
 J. X. Lankford
 made

No-10

The Estate of Ben Merrill deceased,
to M. M. Thompson for
March 14th - 1864 for 6 yds domestic Dr \$4.1500

The State of Texas Personally appeared before the
Court of Dallas, undersigned authority, M. M.
Thompson, being duly sworn, says upon
his oath, that the above acct. for \$60
against the Estate of Ben Merrill dec'd is
just & unpaid & that all legal credits
& demands have been allowed known
to defendant, this 6th day of May 1864.
Sworn to & Subscribed }
before me, this 6th May 1864 } M. M. Thompson
Geo. W. Laws Clerk

150-15-

A. Bellars
Chap. Just
Dallas

Jan 9th - 1866

Approvers:
Geo. W. Laws

Filed May 30th 1866

1566 of Williams
Codic

Accepted for
1566 of Williams
Codic

Ben Merrill
M. M. Thompson
Geo. W. Laws

Recd. of J. C. Williams Adm^r of the Estate of Ben
Merrill dec'd. Three dollars & 90 cts in full
of the within acct. this 24th day of June 1867.
Geo. W. Laws

1	Plain Beaded	div	\$ 2-00
1	Lunch "	div	2-00
4	Feather Beds 10 Pillows & cases	div	60-00
4	White "Hijuna" Counterpane	div	32-00
2	Plain	div	1-00
6	quills	div	12-00
4	Comforts	div	6-00
6	Blankets	div	6-00
6	Shirts	div	3-00
2	Tunics	div	2-00
1	clock	div	1-00
1	Looking glass Broken	div	4-50
9	Chairs	div	7-50
2	Loom Spinning Wheels	div	25-00
1	Living Machine	lost	1-00
2	Par Sheaf Shears	lost	6-00
1	Rifle Gun	div	2-00
1	Bills	div	2-00
1	The World Geographical	div	8-00
1	Rolling history 4 vol	div	1-00
1	Plutarchs history	div	1-00
2	vol history of the French Revolution	div	1-50
1	Josephus	div	1-00
1	Christian Babbler	div	1-00
1	American Geography	div	1-50
1	Greek Revolution	div	1-50
1	Common wealth Rome	div	1-00
1	Patent office Report 6 vol	div	2-00
1	Comstocks Philosophy	div	1-00
1	Masons Hair	div	1-00

107-75
 75-00
 162-00
 149-75
 495-6
 8715-50

The State of Texas, to J. W. Patterson Chief Justice and
 County of Dallas, Judge of the County Court,

Your petitioners that H. Williams & David
 Merrill residing in the County and State of said
 would respectfully represent that heretofore (to wit)

the 15th day of March 1864, the said H. Williams &
 David Merrill of the County and State of Texas departed
 this life leaving a Will, which said David Merrill
 executed on the 15th day of March 1864, which said Will
 is herewith delivered to the Clerk of the County Court
 County of Dallas and State of Texas.

Your petitioners would further represent that said
 Executors appointed under his Will, by said Will,
 whom your petitioners pray that said Will be
 admitted to Probate and that Appraisers be appointed

to appraise the property belonging to said estate and
 receive said Inventory & appraisement and said
 other and further relief as may be right & proper
 and as aforesaid, and will ever pray &c.

This March 29th 1864.

Harsh A. Merrill
 John C. Williams

The State of Texas }
 County of Dallas } March 13th 1864

Be it known that
 I, Ben Merrell being of lawful age
 and sound mind Make ~~the following~~
 constituted and declare the following
 to be my last will and testament
 to wit

- 1st That all my just debts be paid
- 2nd I give to my present wife ^{her} one half
 of all my property both real and personal
 of my children
- 3rd I give and bequeath to my children
 Robert B. Merrell Josephine Merrell Samuel
 G. Merrell Eli F. Merrell the other half
 of all my property both Real & personal
- 4th That all of my property remain together
 untill after the close of the war and
 that none of it be sold or sold to pay
 my debts and to defray ~~the~~ ^{the} funeral expen-
 ces.

After which it may be divided on applic-
 ation of two or more of the heirs legally
 authorized so to complain for a division
 of the same.

In case of the death of one or more of the
 heirs or loss of property that the others
 bear the property equally or sustain a loss
 equally.

That my boy George is not to be sold
 untill the youngest child becomes of
 age but that my wife pay half of his
 hire to the heirs after a division of
 the property

That I appoint my wife Sarah A
 Merrill & John C Williams Executors of
 this Will
 Ben Merrell
 Attest Edwin R. Mansbrough
 John C. Williams

Sarah A. Merrill
 Thomas C. Williams
 Executors
 Probate Court - Dallas, Texas
 Ben Merrell dec'd
 Filed March 29th 1864
 J. H. Williams
 the northern and middle
 & settlement of
 B. Merrell dec'd
 Probate Court
 on record this
 24th day of April
 1864
 J. H. Williams
 Chief Justice

In State of Texas, Before me the undersigned authority, personally
County of Dallas, appeared in Open Court, Edwin K. Harsbrough
whose genuine signature appears as one of the subscribing
witnesses, to the within foregoing Last Will & Testament, of Ben
Merrell deceased, and being by me duly sworn, says upon his
oath that he heard Ben Merrell acknowledge the signing of
said Last Will & Testament to be his own true act for the
purpose & considerations therein specified and that he
signed the same as one of the witnesses at the request of
said Ben Merrell, and that he was of sound mind and
disposing memory at the time of making said acknowledgment.

Edwin K. Harsbrough

Sworn to & subscribed before me this 26th day of
April 1865.
Geo. P. Lewis, Not. Pub. for
Dist. of Texas
By J. G. Thomas, Deputy

The within last will & Testament
of Ben Merrell deceased, is a true
and correct copy of the original
copy of April 1864
J. G. Thomas
Not. Pub. for
Dist. of Texas

Ben Merrell
Last Will & Testament
Filed March 27th 1865
for the purpose of the
The within last
will & Testament
is a true and
correct copy
of the original
copy of April
1864
J. G. Thomas
Not. Pub. for
Dist. of Texas

The State of Texas, County Court, containing the Estates
of Dallas County, October Term 1865.

To all to whom these presents may come, Greeting:
Know ye, that Sarah A. Maxwell and F. C. Williams, as
principals, and J. B. Bachman, J. B. Webb & J. W. Smith

as executors of the last will and
testament of the said deceased, do hereby
acknowledge the receipt of the sum of Twelve Thousand Dollars for
the payment of which well and truly to be made
unto the said Sarah A. Maxwell and F. C. Williams, as
executors and administrators, jointly and severally,
given by these presents, signed with our hands,
and sealed with our seals, the seals being as follows
the 27th day of November A. D. 1865.

The Condition of the above obligation is such that whereas
the above named Sarah A. Maxwell and F. C. Williams
has been appointed executors of the Estate of Ben
Maxwell deceased, now if the said Sarah A. Maxwell
and F. C. Williams shall well and truly perform
all the duties required of them under said appointment
then this obligation shall be null and void otherwise
to remain in full force and effect.

J. A. Meritt
F. C. Williams
J. B. Bachman
J. B. Webb
J. W. Smith

The State of Texas, Sarah A. Maxwell & F. C. Williams do
Dallas County, solemnly swear that we will well and
truly perform all the duties devolving upon us as executors
of the Estate of Ben Maxwell deceased.

S. A. Maxwell
F. C. Williams

Witness my hand and seal this
the 27th day of November 1865
W. K. Mastin

The State of Texas } Indictment Court
Dallas County } February Term 1872

I, the Hon Hardin Root Judge of
the 14th Judicial District of Texas
And now Comes J E Coombes ~~thereupon~~
was referred. The final account of J C
Williams Executor of the Last
Will of Ben McNeill deceased
and submits the following Report.
That he has examined the same
and finds it correct. That said
estate has been fully administered
that said Executor has accounted
for all the estate that has come
into his hands. & Recommends
the approval of the same.

Respectfully Submitted
J E Coombes
Auditor

Ben McNeill
J E Bond
C. J. Coombes

Filed Nov 27th 1865
W. K. Maston clk
approved
Nov 27th 1865
A. H. Cascoe
Chief Justice
D Co

Recorded Dec 1st 1865
W. K. Maston clk.

George Mc Douglas
 In apt with
 Ben Merrill
 To Making 3200 rails 1.25 ---- \$ 40.00
 .. Harvesting & Threshing
 twelve days ... 1.00 ... 12.00
 .. 1 Saddle ... 25 00 ... 25 00
 77 10

August 3rd 1866

The State of Texas } Personally appeared
 County of Parker } before me the under-
 signed authority this day came Mrs. Susan C. Lewis
 is who after being duly sworn, says on oath that
 the above and foregoing account amounting to
 \$77.00, against Ben Merrill is just and
 unpaid, and that all legal payments, and effects
 known to affiant have been allowed.

Susan C. Lewis
 her mark
 Sworn to and subscribed before me, in testimony
 whereof, with my hand and official seal, at Office
 in Weatherford, this the 3rd September
 A. D. 1866. W. W. Duke, Clerk
 Co. Court P. Co.

To Williams
 Esq Auditors
 of Report

Ben Merrill recd

Filed by 7th 3

J. M. Laws Clk

By J. E. Corbier deputy

55 Ben McNeill
 In acc with
 Geo Mc Douglass
 Filed Jan'y 12/67
 Jas. P. Thomas clerk
 Approved
 Nov 26th 1867
 A. Blewett
 County Judge
 No 9

Nov 22^d 1867
 Received of S. C. Williams Exr. of Ben McNeill Dec
 sixty dollars in full of an account I hold
 against said Estate ^{his} Susanto Louis
 mark

Attest

The State of Texas } County Court of Saine County
 County of Dallas } Selling for probate and
 } other legal purposes.

Thomas C Williams and S A Merrill
 Executors of the last will and testament of
 Ben Merrill deceased late of Dallas, Texas
 Shews that, at the late residence of said
 decedent in Saine County, on the 20th day
 of February 1866, by virtue of an order of
 Saine Court passed at the Term thereof
 held in January last, they the said
 Executors after due and legal notice given
 sold on a credit of six months, to the highest
 bidder at public Auction, certain property
 belonging to the estate of said decedent, a full
 and correct abstract is respectfully submitted
 to the consideration of the Court, as follows
 to wit:

One harness To Wm J Smith	\$6.25-
One Calculator to J M Wade	3.00
One Bay horse and Bull to Jm H Blackburn	40.00
One Bay horse and Pony, to Mr Buckman	85.00
One Bay horse now Assasin to W H Hughes	66.00
One Bay horse now Selina, to J M Wade	60.50
One Raan horse, To P G Merrill	25.00
One Saddle horse To Wm J Smith	70.00
One Saddle 3 year old horse to H W Ball	40.50
One Mule to J M Wade	57.00
One Mule to W H Hughes	101.00
Total	\$548.25-

The State of Texas } Before the undersigned Clerk
 Dallas County } of the County Court of Dallas County
 } personally appeared Thomas C Williams
 One of the Executors of the estate of Ben Merrill

who being duly sworn deposes and says
 that the foregoing report is a true
 and correct account of the sale
 made by him of certain property
 belonging to said estate at the time and
 place aforesaid, by virtue of the Order
 aforesaid. J. C. Williams
 Juror to & Subscribed before me
 This 26th Feb 1866

W. K. Masten clk

And the said deponents of the writ of the same Ben
 Morel deems would further represent that under
 an order of the County Court at the time and place of
 the aforesaid sale, they also offered at public sale
 a certain Sewing machine and repeating, and that no
 person would bid any thing for either of said articles
 by whom they were ordered to be sold at private
 sale, if they can get the offered price -

S Messill &
 J. C. Williams Executors

J. Messill & J. C.
 Williams, Exors
 by Sara Bell

Filed Feb 26th 1866
 W. K. Masten clk

Approved
 Feb 24th 1866
 A. B. Bland
 Chief Justice
 Dallas Co

Received Mar 1st 1866
 W. K. Masten clk

The State of Texas }
County of Dallas }

To The Honorable A. Blodson
Chief Justice of said County presiding
J. G. Williams Executor of the estate of Ben
Merrell late of said County deceased respectfully
shows that under an order made at the June
Term then of 1867 directing the sale of five
shares Houston Texas Central Railroad stock
at private sale Respectfully shows that he
has sold the same for the sum of Fifty
dollars to W. A. Canabstyne \$ 50.

The State of Texas }
County of Dallas } Before me J. S. Jones Clerk of
the County Court for said County Came J. G. Williams
Executor of the estate of Ben Merrell deceased who
being duly sworn deposes and says that the foregoing
report is a true and correct account of said sale
made in pursuance of said order

J. G. Williams Exr
Sworn to & subscribed in open court
July 25th day of Novr A.D. 1867.

J. S. Jones Clerk of the County Court
J. S. Jones

The State of Texas In Probate Courts
County of Tarrant April 30th 1867

To the Hon^{ble} the Court Jury of the
County of Tarrant

Thos^{as} C. Williams Executor
of the last will and Testament of Ben
Merrell deceased comes most respectfully
represent that same Estate has been partitioned
between the several heirs, by Commissioners appointed
for that purpose, that the report of the said
Commissioners has been in all things confirmed.

Butler comes further represent that
the said Commissioners ordered to partition
and distribute the following property in the
same was not deemed by them susceptible
of a fair division; to wit, ~~the same~~

Mare & Hens, supposed to be lost or dead
75 Head of Sheep, plain Thatchers
Iron of Old Reaper, 1 Sewing machine
Hut 400, 4 or 5 Seters
Log Chain, 3 Shares in Tex. Central Rail Road.

Butler comes respectfully ask for
an order to sell on a credit of 3 months
all of the above named property, except the
3 Shares in the Tex. Central Rail Road, which
he comes ask for an order to sell at
private sale satisfied that the same under
being much more at private than public
sale.

All of which is
submitted by
J. C. Williams by
Burgess & McLeary
His atty.

J. C. Williams
Executor Estate of
Ben Merrell dead
To Report of sale

Filed Nov 25th 1867
Sams. S. Jones
Clerk

Approved
Nov 26th 1867
H. Bledsoe
County Judge

Recorded

The State of Texas
 County of Dallas }
 To the Honorable J. C. Combs Chief Justice of said County
 presiding

J. C. Williams Executor of the estate of Ben Merrell late of said County Decedent, respectfully shows that at the late residence of said decedent in said County on the thirteenth day of July instant by virtue of an order of said Court passed at the term thereof held in June last he the said Executor after due and legal notice given sold upon a credit of three months to the highest bidder at public auction certain property belonging to the estate of said decedent a full and correct account whereof is respectfully submitted to the consideration of the Court as follows to wit

one four year old Steer	Wash	\$ 10 - 00
two two " "	" " " R. B. Merrell	9 - 00
five one " "	" " " J. R. Ball	10 - 50
Twenty eight head Sheep	" " "	60 - 70
one Mare & Colt	" " "	55 - 00
old Reaper	O. I. Bailey	10 - 00
one Log chain	W. P. Cochran	1 - 50
one Foot Axe	P. A. Winn	1 - 50
one Sewing Machine	V. A. Mathis	11 - 25
		<u>\$169 - 45</u>

The State of Texas (Before me J. P. Thomas Clerk of the County
 County of Dallas (Court for said County came J. C. Williams
 Executor of the estate of Ben Merrell decedent who being duly
 sworn deposes and says that the foregoing report is a true and
 correct account of the sale made by him of certain property
 belonging to said estate at the time and place aforesaid by
 virtue of the order aforesaid
 J. C. Williams Exr.

Sworn to and subscribed before me this July 22nd 1867
 Jas. P. Thomas Clerk

J. C. Williams
 Executor of
 Ben Merrell
 Decedent

Applicator to sell
 Certain property

Filed April 30th 1867
 Jas. P. Thomas Clerk

Approved & Sale
 ordered April 30th 1867

J. Ellis Combes
 County Judge

State of Texas } In the County Court
Dallas Cash } Jan'y Term 1866
To the Hon A. Pleasor Chief Justice

He of Dallas County Texas.

The undersigned ^{one of the} Executors of the Last Will & Testament
of Ben Merrill dec'd, respectfully represents that
there are debts due from said Estate to the
probable amount of five hundred dollars

And that there is personal property belonging
to said Estate, which is liable to waste.

And that it is the Will of decedent that
after the War, property should be sold to
pay debts, and family expenses -

He would represent that the war is now
over and there are taxes and other
expenses necessary to be paid which
will require money - And that there is
no money in the hands of the Executors
wherewith to pay the same

He therefore asks for an order authorizing
the Executors aforesaid to sell, of the personal
property of said Estate, sufficient, to pay the
Taxes, Debts, Expenses of Admⁿ. ~~which to~~
~~such terms as may seem right &c~~

J. C. Williams
Executor

Shas C Williams
Executor of
Ben Merrill dec'd
508 Report of Sale

Filed July 22/67
Jas. P. Thomas etc

Sale Bill Approved
July 30th 1867

Ellis Combes
County Judge
J. C. Williams

Recorded Page 139

Community Property of Fred & Wife
as follows to-wit

Board Man's Potts	Mary	divided	\$ 20-00
"	"	Sons' share	20-00
Isaac	Lilly	divided	50-00
Nammy	Flores	divided	55-00
Eli	Kell	divided	75-00
"	Han-Dead		75-00
Lucy	Val	divided	80-00
Widow	Kagar	stock	75-00
Sam	Col.	Boy	35-00
Eli	Poll		75-00
"	Pats	Dead	90-00
Eli	Boy	filly 4 year old	35-00
Isaac	"	" " " " " "	50-00
Pats	"	girl " " " "	65-00
Sam	"	" " " " " "	55-00
Lucy	"	" " " " " "	55-00
Nammy	Thom	cut Man's head	75-00 and
Lucy	"	" " " " " "	65-00 and
Widow	"	" " " " " "	65-00 and
Eli	April	filly 3 year old	70-00
Isaac	Boy	rank 2 year old	40-00
"	22	yellow Bay filly	40-00 Ball
Pats	23	sea Bay filly 2 year old	45-00
Nammy	24	yellow Bay filly 1 year old	25-00
"	25	Bay filly 1 year old	25-00 and
Eli	26	Bay Man's cut	and 150-00
"	27	Bay horse vesicles	and 65-00
"	28	" " Sealum	and 65-00
"	29	" " Pompey	and 45-00
"	30	" " Madook	and 50-00
"	31	" " Bull	and 25-00
			1695-00

Fred & Wife
Community Property

J.C. Williams
Ex. M^{re}
Petitioner to
sell property
Estate of Ben Merrill

Filed Jan'y 30th 1866
Jas. O. Thomas Atty. at L.

Approved and
Sale ordered
Jan'y 30th 1866

A. Bledsoe
Chief Just
Ball

R. H. Mc

	No				
	32	Small. horn 3 year old			67-00
Sam	33	Bay " " " "			50-00
"	34	" " " " "			75-00
	35	Roan " " " "			30-00
Lucy	36	Bay " " " "			70-00
Ellen	37	Small. blaze face			35-00
William	38	Bay horn 2 years old			50-00
David	39	Bay " yearling horn set			25-00
Nancy	40	" " " "			25-00
Ellen	41	Roan horn set			12-00
+ Eli	42	Bay " " "			25-00
Sam	43	Small. Colt			30-00
	44	Brown yearling Mule			50-00
	45	" " "			45-00
Scott	7	Cows & Calves			56-00
	1	Red Cow spot			9-00
	5	2 year old heifer			20-00
	5	yearling heifer			12-00
	2	two year old Steers			12-00
	15	head of Hops used for lamp purposes			25-00
	35	head of Sheep sold			70-00
	1	Wagon			30-00
		Iron of old jif			4-00
		" of old Reaper sold			5-00
	2	Turning Plows			14-00
	2	Shovel			3-00
	1	Cultivator sold			3-00
	1	Iron Tooth Hammer sold			7-00
	2	Grubbing Hoes			4-00
	2	Weeding Hoes			1-00
	3	axes			3-00
	1	Iron Wedge			50
	1	foot adz			1-30
					795-00

1	Log Chain	Wood	#	2-00
1	par old gear	wood	cut	2-00
2	half Barls	divided		4-00
one	10 Gallon Keaf	divided		2-00
1	par Shutehrs	Brokage		2-50
7	iron nails			6-00
2	lung tubes & 2. Clenses	divided		4-00
3	Keypans	divided		6-00
1	Cook. Stove & usels	divided		30-00
1	Kettle	divided		3-00
2	Skillets & Lids	Brokage		5-00
1	large oven & Lid	divided		3-00
2	Lir Buckets & one par	divided		3-00
4	Wooden Buckets 3	gallon	to use	2-00
2	Meal Barls & 1 Tray	divided		1-50
1	Churn	divided		1-50
1	Fin Shovel	divided		.50
1	Griffe Mill	divided		.50
1	Sausage "	divided		3-00
6	Jars & two crocks	to Brokage	2 sh	4-00
1	Table	divided		2-00
1	Pup.	divided		10-00
1	Par Candle Mols	divided		1-25
2	Smoothing Irons	divided		1-00
2	Pitchers	Brokage		1-00
1	Large Dish	divided		1-00
3	Plates & Glas Jar	divided		.50
1	Set of Knives & forks	divided		1-00
1	Small Table	divided		.50
1	Warrohe	divided		15-00
1	Pup. & Caer	divided		10-00
1	Elm Beadstow	divided		6-00
1	Walnut Beadstow	divided		8-00
				142-75

Inventory and appraisement of the Estate of Benjamin Merrill late of Dallas County deceased.

The individual property of decedent is as follows. To-wit:

620	acres	Land	Heardright of A. A. Mosseyham	in Dallas County, appraised at	1920-00
3	acres	Land	Heardright of Ben Merrill	" " " "	" " " "
330	"	"	"	"	960-00
160	"	"	Ali Merrill	"	641-00
160	"	"	J ^r	"	232-00
152	"	"	Hebb Heins Sr	"	152-00
25	"	"	J ^r	"	50-00
34	"	"	Bennett Heins Mrs	"	34-00
					4956-11

4956-00
 1625-00
 758-00
 152-75
 201-75
 7713-50

Inventory and appraisement of the Estate of
 Ben Merrill late of Dallas County deceased.
 The individual property of decedent is as follows
 to-wit

640 acres of Land	Headright of J. S. Mooneyham	
	in Dallas County	appraised at \$15200.00
320 acres	Headright of Ben Merrill	960 00
320 "	" " " " "	960 00
160 "	" " " " Eli Merrill	440 00
160 "	" " " " Do	240 00
152 "	" " " " Webb (Heir) 1/2	152 00
25 "	" " " " Do	50 00
34 "	" " " " Bennett (Heir) 1/2	34 00
Broad Mares	Mary	20 00
" "	Sous	20 00

The Community property of decedent
 and Wife is as follows to-wit

Broad Mares	Letty	50 00
" "	Flora	85 00
" "	Nel	75 00
" "	Fan	75 00
" "	Sal	50 00
" "	Kajar	75 00
" "	Dol	35 00
" "	Pol	75 00
" "	Pats	90 00
"	Boy Hilary 4 years old	55 00
"	" " " " "	50 00
Dup "	" " " " "	65 00
" "	" " " " "	55 00

2

Ant Part from

" " " "	55 00
Honeycut Man 5 years old	75 00
Bay " " " "	65 00
" " " " "	65 00
Sorel " " " "	70 00
Dark Bay 2 years old	40 00
Yellow Bay filly 2 years old	40 00
Red " " " " "	45 00
Yellow Bay filly 1 year old	25 00
" " " " "	25 00
Bay Man Colt	15 00
" Horse Quaker	65 00
" " Salum	65 00
" " Pompey	45 00
" " Murdock	50 00
" " Bull	25 00
Sorel Horse 3 years old	50 00
Bay " " " "	50 00
" " " " "	45 00
Roan " " " "	30 00
Bay " " " "	40 00
Sorel Blaze face " " "	35 00
Bay Horse 2 years old	50 00
Yearling horse Colt Bay	25 00
" " " " "	25 00
Roan " " " "	12 00
Bay " " " "	25 00
Sorel Colt	30 00
Brown yearling Mule	50 00
" " " " "	45 00

3

Cattle Iron Cows & Calves	54	00
1 Pidea " Spot	8	00
Five 2 year old Heifers	20	00
Three yearling "	12	00
2 two year old Steers	12	00
15 Head of Hogs	25	00
35 head of Sheep	70	00
1 Wagon	30	00
Iron of old reaper	5	00
2 Turning Ploughs	15	00
2 Shovel "	3	00
1 Cultivator	3	00
1 Iron tooth Harrow	7	00
2 Gripping Hoos	4	00
2 Weeding "	1	00
3 Axes	3	00
1 Iron Wedge	50	
1 Foot Adz	1	50
1 Logchain	2	00
1 Par old Beer	2	00
2 Half Barrels	4	00
one 10 Gallon Keaf	2	00
1 Par Shetters	2	50
4 Horse Bells	4	00
2 Singletrus & 2 Clews	4	00
3 Bee Gums	6	00
1 Cookstove & virels	50	00
1 Kettle	3	00
2 Skillets & Lids	5	00
1 Large Oven & Lid	3	00
2 Tin Buckets & 1 Pan	3	00
4 Wooden Buckets	2	00

2	Meal Barrels & 1 Tray	1	50
1	Churn	1	50
1	Fire Shovel		60
1	Coffee Mill		50
1	Sausage "	3	00
4	Pans & 2 Crocks	4	00
1	Table	2	00
1	Trup	10	00
1	Par Candle Mole	1	15
2	Smoothing Irons	1	00
2	Pitchers	1	00
1	Large Dish		50
3	Plates & Glap Pan	1	00
1	Set of knives & Forks		50
1	Small Table	15	00
1	Wardrobe	10	00
1	Trup & Case	6	00
1	Alm Bedstead	8	00
1	Walnut " "	2	00
1	Plain	2	00
1	Lumel " "		
4	Leather Beds 10 Pillows & 5 Cases	60	00
4	White figured Counterpane	32	00
2	Plain	1	00
4	Quilts	12	00
4	Comforts	6	00
4	Blankets	9	00
4	Shirts	6	00
2	Trunks	5	00
1	Clock	2	50
1	Looking Glap	1	00
9	Chairs	4	50

2	Spinning Wheels	7	50
1	Sewing Machine	25	00
2	Par Sheep Shears	1	00
1	Rifle Gun	6	00
Books 2	Bibles	2	00
	The World Geographical	3	00
	Polins History 4 vol	8	00
	Plutarchs History	1	00
	History of French Revs 2 vol	1	00
	Josephus	1	50
	Christian Babbet	1	00
	American Biography		50
	Greek Revolution		50
	Common wealth of Rome		50
	Patent office Reports 6 vols	1	00
	Comstocks Philosophy		25-
	Masons Ariar	1	00
	Total Amt		

5
 The State of Texas Personally appeared in open Court
 Dallas County 3 Thomas C. Williams & S. Q. Merrill
 Executors of the Last will & testament of Ben Merritt dec'd
 and made oath that the above & foregoing 5 pages contains a
 full true & correct inventory of all the property belonging to
 the estate of said testator, so far as the same has come to
 their hands or knowledge - J. L. Harrell {Executors
 T. C. Williams

Sworn to & Subscribed in open Court this 28th Nov^r 1865
 W. H. Masten clk C. H. Co. Ct. & Clk

State of Texas }
Dallas County } Personally appears in open Court
P. H. Sively & John W. Smith, two of the persons, heretofore
appointed to appraise the property belonging to the
estate of Ben Merrill Dew, and make oath that the
within and foregoing inventory and appraisement is just
and true & the appraisement of said property as shown
therein, is just and fair to the best of their belief

P. H. Sively }
J. W. Smith } appraisers

Sworn to and subscribed in open Court this 27th Nov
A.D. 1865.

W. H. Masten

CLK CC. S. Co.

~~W. H. Masten~~

J. C. Matthews &
J. D. Merrill Exors

of } Inventory &
} Appraisement

Estate of Ben Merrill
Dew dec'd

Filed Nov 27th 1865

W. H. Masten CLK

Appraised
Nov 27th 1865

W. H. Masten

Chief Justice

J. Co.

Record Nov 29th
1865 W. H. Masten CLK

W. H. Masten

The State of Texas
County of Dallas
In the County Court
July Term 1867

In the Hon^{ble} C. Leavelle Judge of
the County Court of Dallas County Texas
The Petition of Sarah
A married woman of Ben Marshall late
deceased of Dallas County, and Robert B
Marshall son of the said deceased both
of whom are heirs and distributees of
the Estate of the said Benjamin Marshall
Would most respectfully represent
that deceased departed this life some
time in the year 1864. / Heav^{er} of a large
amount of real and personal property
valued at near eight thousand dollars;
that deceased left a will by the
terms of which the property was to be
divided equally between all his heirs,
namely Sarah A Marshall widow and
surviving next of the said deceased, and
Robert B, Josephin E, Gaud J, Eli F,
Nancy E and Lucy de ^{Marshall} ~~Marshall~~ Children
of deceased the least six of whom are
minors under twenty one year of
age, and reside in Dallas County;
Petitioner would further state that
their trustee arranged other things provided
and authorized for distribution of same
whenever two of the distributees of competent
age should desire such distribution;
Petitioner further represent that John
C Williams is the Executor of the will
of said deceased and has been duly

qualified as such, and is now administering
said estate in the County Court of
Dallas County

The premises concerned Pittman
prays for distribution of said estate
equally between the several above mentioned
heirs, that summons issue & that
on a final hearing it be adjudged that
all the property, (except sufficient to
pay the debts due from decedent and all
the costs of administration) belonging
to the estate of Ben Murrell
decedent be equally partitioned between
all the heirs of decedent in conformity
with his will = and for all such
orders & decrees or stipulations be made in
the premises

Revised & Moleyns
attys for Pittman

S A Merrell &
R B Merrell

Joseph E Merrell
et al

Petition to partition
and distribute the
Estate of Perry
Merrell dec'd

Filed February 5th 1867
Sas & Thomas clerk

Petition Granted
Feb 27 1867

J. Hill (Clerk)
County Judge

Citations issued -

P. H. Sively
W. H. Thomas
J. H. Cole
Geo. Nash
Instrumentary

In County Court Dallas County
 December Term A.D. 1866
 and Geo. C. Williams Executor of the Last
 Will of Benj. Merrill dead and presents the following as
 the condition of the Estate of Said Decedent
 Said Executor to Said Estate Or

By Amount actually on hand	\$ 1,956 00
By Amount reasonably on hand	2143 50
By one Mare Stan dead	75 00
By one Mare Pats dead	90 00
By one Bay filly four year old dead	35 00
By one Bay Mare Colt dead	15 00
By one Hine Murdock dead	50 00
By amount State & Co Tax paid Act No 128 1865	14 31
By amount State & Co Tax paid Act No 130 1866	17 95
By amount paid for buying Sale	2 00
By amount paid W th Street aty Act No 290	23 50
By amount claim on hand not collected	412 12
Total Amount Credit	\$ 7,841 75

Geo. C. Williams Ex of the Last Will of Ben Merrill
 do solemnly swear that the above Exhibit contains
 full and complete statement of the condition of the
 estate of Benj. Merrill dead so far as the same
 has come to my knowledge except the increase of
 said stock which will be reported in due time
 when the same can be appraised.

Sworn to and Subscribed

G. C. Williams

Before me this the 20th day
 of December A.D. 1866

J. Ellis Cromber

Chief Justice Dallas County Texas

State of Texas }
 County of Dallas }

Now comes S A McNeill
 Will & Testament of Benj
 third Annual Exhibit of
 Said Executor to Said Estate Dr

" Amount Realty on hand as per Inventory	\$ 956 00
" Amount Personally on hand as per Dr	2757 50
" Amount Arrear of Sale Bill above Appraisalment	128 25

Total amount set-ter \$ 7,841 75

Claims Accepted

Claim W. Laws for \$ 3.00
 Claim W. Laws for \$ 62.00
 Claim of Susan Douglas for \$ 77.

Claims rejected

None
 Claims in Suit None

S. A. Mcemell and
Thos. C. Williams
Executors
Ben Mcemell adid.
Annual Exhibit
1866

Filed Dec 20th 1866
Geo. B. Thomas *clerk*

Approved this the
~~21st~~ Dec 1866
Jedediah Leonard
Chief Justice
D. C. T.

6238

The State of Texas
County of Dallas

Now comes V. C. Williams Executor of the last Will and Testament of Ben Merrill Deed and assigns the following as a final account with said Estate & prays to be discharged from any further liabilities of said Estate

Said Executor to said Estate Dr		Said Executor to said Estate Cr	
To Amt of Realty on Land as per Inventory	\$ 4956 00	By Amount Realty Estimated by the Heirs by order of Court	4956 00
" Amt Personally on hand as per Inv & app	2757 50	By Amt Personal Property distrib among the Heirs by ord Probate Court	1813 00
" Amt Excess of Sale above app	128 25	By Amt Personal property dead & dead	
" Realized on sale of Coll to R. Merrill above app	50 00	" one Mare Stan Dead	75 00
" Amt of Railcar & Equip on hand Invented sold by order of Court for	50 00	" " " Pat " "	20 00
" Interest collected on claims belongs to the Estate	23 50	" " " Bay Talley "	35 00
		" " " Mare Coll "	15 00
Total amount Debit	7965 25	" " " Horse Murdock	50 00
		" " " Strayes	50 00
		" " " Mare Dead	20 00
		" " " Bay Coll	25 00
		" " " 18 head of Hogs consumed by Family of Dead	25 00
		" " " one Beef Steer consumed by Family of Dead	5 00
		By Amt of House Furniture destroyed	25 50
		" " " Paid for Hunters Stock	11 00
		" " " by Tax Receipts for 1865 & 66 No 182	32 26
		" " " U S Tax on Land No 183	23 50
		" " " Amt paid for buying Sells No 4	2 00
		" " " Amt as per auctioneer " 5	24 10
		" " " " " 6	9 76
		Cash paid Lewis for Season of Mares	14 00
		Mrs M. A. May " 8	18 00
		Cash paid Susan Lewis as per auctioneer No 60	60 00

	25 00
one Best Deer consumed by July 1st	5 00
by Amt of House Furniture destroyed	25 50
" " Paid for Hunters Stock	17 00
" by Tax Receipts for 1865 & 66 No 100	32 96
" " U S Tax on Lands No 100	23 50
" Amt paid for Crying Sale 107	2 00
" Amt as per voucher " 5	24 00
" " " " " 6	9 67
Cash paid Lewis for Season of Mares	14 00
for M. A. Mair " 8	18 00
Cash paid Susan Lewis as per voucher No 60	60 00
" " Sarah Lambford for season Mares No 10	24 00
" Printers fees per voucher " "	5 25
Cash paid Court Cost voucher 12	197 55
" " " " " 13	51 75
" " " " " 15	3 50
" " " " " 16	62 50
" " Taxes for 1867 " 17	18
" " " " 1867- " 18	20 14
" Court fees now due	1 69
" Printers fee on Final settlement	6 00
" Printers fee on Final settlement	6 00
Amount paid \$ 16 by bill for saddle	
" O. L. Bailey for buying Reaper (18)	16 00
" " " " " 19	1 50
" Taxes paid 1867 voucher 21	15 75
" Repairs on Wagon for use of gamble	2 00
" Deficiency in 2nd Sale bill	28 15
" Attorneys fees Request Wills	50 00
" Commissions for Collecting & paying out	87 26
for persons service in collecting Camp	
and management of the local affairs	
also the charge of Camp firing	150 00
	8112 72

Thompson Shroud	100
Same paid 1867	25
Repairs on Wagon for use of gamel	20
Deficiency in 2 ^d Sale bill	28 1/2
Attorney's fee Report Notes	50 00
Commissions for Collecting & paying out	87 26
100 per cent. Service in taking care	
and management of this estate	
where the Champ per Commission =	150 10
	<hr/>
	811 2 72

All of which is most respectfully
 submitted unto the District Court
 with a pray that the same may be in all
 things confirmed and affirmed; and that the
 undersigned may be fully discharged of her
 trust as executor of the estate of Ben
 Marshall deceased

J. C. Williams

Given and subscribed before me this
 the 14th day of Oct 1871

J. M. Daws
 Clerk Dist. Ct. Dallas Co. Texas
 By J. D. Coombs depy

Thomas Williams
Esquire of the
County of
in apt and said
state and

application for
license

Filed Oct 14th 1877

J. M. Sawwell

By J. J. Combs

The State of Texas
County of Dallas

To the Honorable J. Ellis Coombes
County Judge of Dallas County Texas

The undersigned Commissioners appointed at the February Term of the Probate Court of Dallas County A.D. 1867, to Partition the Real and Personal Estate of Benjamin Merrill deceased, respectfully report that they met at the late residence of of Deedent, on the 22nd inst and from day to day thereafter, and made the divisions in accordance with said order, in the manner and form follow to wit,

First They divided the Land belonging to the Estate into Twenty Lots or tracts, as represented in the foregoing Plot, and numbered from one to twenty inclusive,

Second, They arranged said twenty Lots into eight shares, having in consideration the value thereof with the improvements thereon, & giving to each share its proportion of Timber & Prairie, in the following order, To wit

Share No 1

Lot No 1 Prairie 192 Acres Ben Merrill Headright
Lot No 15 Timber 80 Acres Ben Merrill Headright

Share No 2

Lot No 2 Prairie 74 Acres Ben Merrill Headright
Lot No 6 Prairie 111 Acres J J McCreigham Headright
Lot No 10 Timber 80 Acres Eli Merrill Headright
Lot No 19 Timber 12 1/2 Acres Heirs of Harrison Webb Headright

Share No 3

Lot No 3 Prairie 60 Acres Ben Merrill Headright
Lot No 11 Timber 80 Acres Eli Merrill Headright
Lot No 20 Timber 12 1/2 Acres Heirs of H Webb Headright

Share No. 4

Lot No. 4 Prairie 80 Acre J. J. Mooneyhans Headright
Lot No. 12 Timber 80 Acre Eli Merrill Headright
Lot No. 14 Timber 42 Acre Heirs of W. Bennett.

Share No. 5

Lot No. 5 Prairie 80 Acre J. J. Mooneyhans Headright
Lot No. 13 Timber 80 Acre Eli Merrill Headright

Share No. 6

Lot No. 7 Prairie 170 Acre J. J. Mooneyhans Headright
Lot No. 16 Timber 80 Acre Benj. Merrells Headright

Share No. 7

* Lot No. 8 Prairie 170 Acre J. J. Mooneyhans Headright
* Lot No. 17 Timber 80 Acre Benj. Merrells Headright

Share No. 8

Lot No. 9 Prairie 186 Acre, of which 152 acre H. Holt & 34 Acre W. Bennett's Headright
Lot No. 15 Timber 80 Acre Benj. Merrells Headright.

The Commissioners then proceeded to divide the Personal Property consisting of Horses, Cattle, Farming Tools, and House Hold goods into eight equal shares, which resulted as follows, after being attached to the Shares of Land, as above made

Share No 1

Share No 1 of Land valued at	\$12000.00	
The Flora Mare	50.00	
" Kate Mare	100.00	
" Boll Mare 2yr old	50.00	
" Hagar Stud Colt	35.00	235.00
" Lucy cow & calf	12.00	
" Bicks 2yr old Heifer	5.00	17.00
" 1/2 of Feather Bed	4.50	
" Cook Stove	7.00	
" Barrell 50¢ Tray 50¢	1.00	
" Churn 1.50 Coffin mill 50	2.00	
" Sausage Mill 1.00 Wht Counterpin 500	9.00	
" 2 Quilts 4.00, 2 Blankets, 500	7.00	
" 2 Shirts 1.50, 1 Trunk 50	2.00	
" 1 Clock 2.50 4 Chairs 2.50	5.00	
" 1 Spring wheel	2.50	43.00

\$11195

Share No 2.

The Share No 2 of Land valued at	1200.00	1200.00
" Lety Mare 50¢ The Suez Mare 80	130.00	
" The Patsy Mare 75¢ Young Marys Stud 300	105.00	235.00
" Star Cow & calf 12¢ Star, 2yr old Heifer 57	17.00	
" Turning Plow 7¢ Farming Hoe 2.00 Axe 50	7.50	17.00
" Walnut Bedstead 8¢ Horn Bell 1.00 1/2 Barrell 2.00	11.00	
" Pitcher 50. 2 Comforts 37 1 Quilt 2.00	5.50	
" 1 Blanket 1.50 1/2 of Feather Bed 7.50	9.00	
" 2 Shirts 1.50 1 setl Kains of 1.00	2.50	
" Christian Baplist 1.00, Candle Moulds 1.00	2.00	
" 1 Bible 1.00	1.00	
" French Revolution 1.00 1 Bible 1.00	2.00	43.00

\$11495.00

Share No 3

The Share No 3 of Land valued at	1200.00	1200.00	
" Hays Mare \$70, Dury 5yr Old Mare 75.	145.00		
" Lillys 2yr Old Horse \$50, Bolls Yearling Stud 40	90.00	235.00	
" Spot Cow + calf 15\$ Potts Heifer 5\$	20.00	20.00	
" 1/2 of Feather Bed 7.50 1 Press 10\$ Columbia Stand 6\$	23.50		
" Horse Bell 1.00, Winding Hoe 50 100 Gal Keg 2\$	3.50		
" Dish 1.00, Counterpin 8\$ 1 Comfort 1.50	10.50		
" Josephus 1.50 American Geography 50	2.00		
" History of Conn 50	50	46.00	\$149.50

Share No 4

The Share No 4 of Land valued at \$	1200.00	1200.00	
" Old Hill Mare 80\$ 5yr old Sorrell Mare 75	155.00		
" Nells 2yr Old Lilly \$40.00, Flora's Stud Colt \$40	80.00	235.00	
" Beck Cow + calf \$12.00 Lillys 2yr old Heifer 5\$	17.00	17.00	
" 1/2 of Feather Bed 7.50 1 Short Plan 1.50 Gouting Hoe 2.00	11.00		
" Winding Hoe 50, Iron Wrege 50, Axe 50, 1 Tunny Plow 7.00	2.50		
" 1 molasses Barrel 2.00 Plutanes, Linn's of Lewis 50	3.50		
" Rollins History 3.00 Horses Panier 1.00 Patent Office R.F. 1.00	10.00		
" Cornucopia's Phylology 25, 3 Plates + Glass Jar 50	75		
" Volcs Geography 3.00 40 chains 2.50	5.50		
" 1 Spinning Wheel 2.75 1 Comfort 1.25	2.75	43.00	\$149.50

Share No 5

The Share No 5 of Land valued at	1200.00	1200.00	
" Bolls Mare \$60, John Horse 60\$	120.00		
" Young Marys Mare 70\$ Lillys Stud Colt 45	115.00	235.00	
" Pleasant Cow + calf \$12.00 Patey Cow + calf 10\$	22.00	22.00	
" 1/2 of Feather Bed 7.50 1 Gun 6\$ 1 New Gun \$2\$	15.50		
" 1 Kettle 3\$ 2 Tin Buckets, 1 Pan 1.50 1 Barrel 50	10.00		
" 1 Small Sath 50, 1 Wht Counterpin 8\$ 2 Smiths 4\$	11.50		
" 2 Blankets, 3.00 2 Shuts, 1.50 1 Trunk 50	5.00	38.00	\$149.50

Share No 6

The Share No 6 of Land valued at	1200.00	1200.00	
" Poll Mare \$75, The Spanish Bay Mare 60\$	135.00		
" Below Horse \$70, The Gray Stud Colt 30\$	102.00	235.00	
" Lilly Cow + calf 12\$ Strawberry Cow + calf 10\$	22.00	22.00	
" 1/2 of Feather Bed 7.50 1 Wagon 50.50	32.00	38.00	\$149.50

Share No 7

The Share No 7 of Land valued at	1200.00	1200.00	
----------------------------------	---------	---------	--

" Rollins Shovel 75
 " Cornstoks Hylocity 25, 3 Plates + Glass 70
 " Wools Geography 1.00 4 chains 2.50
 " 1 Spinning Wheel 2.50 1 Comfort 1.25

Share No 5

The Share No 5 of Land valued at 1200.00 1200.00
 " Bull Mare 66. John Horse 60 120.00
 " Young Marys Man 70 7 Litty Stud Colt 45 115.00 235.00
 " Black Cow + calf 7 12.00 Fat Cow + calf 10 20.00
 " 1/2 of Feather Bed 7.00 1 Gun 1/2 1 Bar Gun 2 2 15.00
 " 1 Kettle 1/2 2 Tin Buckets + Pan 1.50 1 Barrell 50
 " 1 Small Bath 50, 1 Wht Counterpin 1/2 2 Smiths 4 15.00
 " 2 Blankets 500. 2 Shuts 1.50 1 Trunk 50 5.00 38.00 1495

Share No 6

The Share No 6 of Land valued at 1200.00 1200.00
 " Bull Mare 75. The Spanish Bay Mare 60 120.00
 " Silaw Horse 70. The Gray Stud Colt 30 100.00 215.00
 " Litty Cow + calf 12 1/2 Strawberry Cow + calf 10 22.00 22.00
 " 1/2 of Feather Bed 7.50 1 Staggon 50.00 38.00 1495

Share No 7

The Share No 7 of Land valued at 1200.00 1200.00
 " Bally Mare 80 1/2 Nilly Mare 70 155.00
 " Pompey Horse 70, Suezs Yearling Stud Colt 30 80.00 235.00
 " Pitt Cow + calf 12 1/2 White face + calf 10 22.00 22.00
 " 1/2 of Feather Bed 7.00 1 Wardrobe 15 1 Plain Bed Stead 2 24.00
 " 1 Horned Bell 1 2 Singletons + Clevis 2.50 4.00
 " 1 Bar Gun 2 2 Jars 10 1 Bath 2.00 5.00
 " 2 plain Counterpins 1 1 Bith 1 1 Shovel plow 1.50 5.00 38 1495

Share No 8

The Share No 8 of Land valued at 1200.00 1200.00
 " Buck Mare + Colt 110, Suezs top Old Bay Mare 55 165.00
 " Marys Yearling Filly 30 1/2 Salls Yearling Stud 70, Old Mare 10 70.00 235.00
 " Ruddy Cow + calf 12 1/2 Pink Cow 12 22.00 22.00
 " 1/2 of Feather Bed 7.50 7.50
 " Priest + Case 10 2 Jars 10 11.50
 " Foundle Bed 7.2, 2 Irons 50 2.00
 " Horned Bell 7.1 1 Wht Counterpin 1/2 2.00
 " 1 Bar Gun 7.2 5.00
 " 1 Oven + Lid 7.3 5.00
 " 1 Shovel 50 cty 5.00 36.00 1495

The Allotments into Shares being completed in the manner before described, Eight Tickets, representing the eight Shares, and numbered from one to eight inclusive were prepared, and it being suggested & agreed to by the Heirs or representatives present, that the Commissioners should draw from the Tickets, the one representing the House & improvements the late residence of Decedent, for the widow Mrs S. A. Merrill, it was accordingly so done, and the remaining seven Tickets, were placed in a Hat and each Heir or representative drew therefrom one Ticket, representing each one particular share of said estate, as follows.

Share No.	Drawn by	valued at	¢
Share No 1	Mrs Nancy C. Merrill	1495	00
Share No 2	Josephine Merrill	1495	
Share No 3	Mrs S. A. Merrill	1495	
Share No 4	Eli Merrill	1495	
Share No 5	Saml. Merrill	1495	
Share No 6	Ella Merrill	1495	
Share No 7	Lucy Lee Merrill	1495	
Share No 8	Robt. Merrill	11960	
Total valuation in currency			

These Commissioners beg leave to say that in the performance of their duties in this case, they have passed through tribulations both seen & unseen, by Land and water, through mud and briars, and now they respectfully submit their report, under Oath.

Sworn to before me this
29 day of April A.D. 1867
Geo. P. Thomas Clerk

W. H. Thomas
J. P. Meadors } Commissioners
G. W. Nash

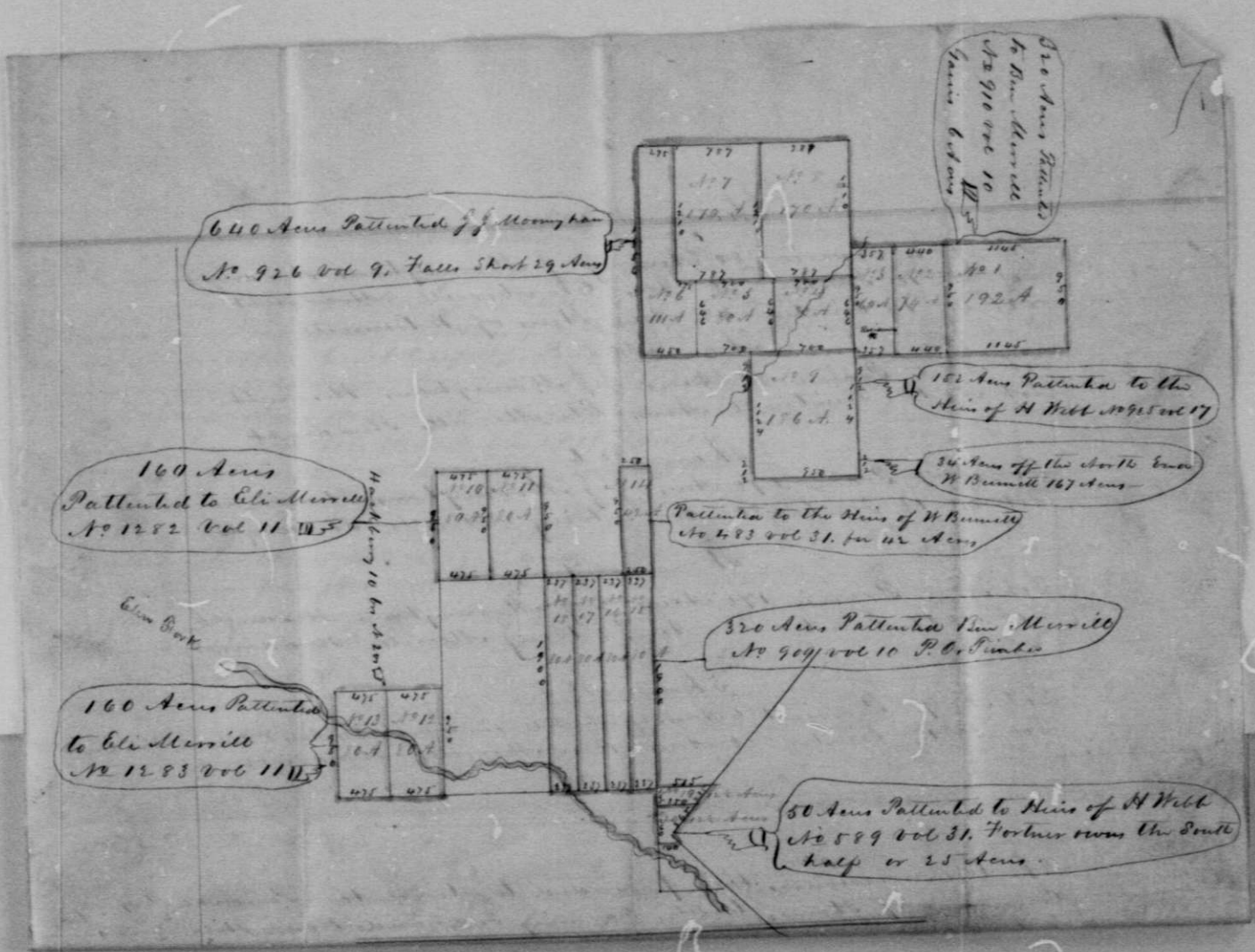

640 Acres Patented J. J. Mooneyham
No. 926 vol 9. Falls Shot 29 Acres

160 Acres
Patented to Eli Merrill
No. 1282 vol 11

160 Acres Patented
to Eli Merrill
No. 1283 vol 11

Patented to the heirs of W. Burnett
No. 483 vol 31. for 122 Acres

320 Acres Patented New Merrill
No. 909 vol 10 P. O. Pimble

50 Acres Patented to heirs of H. Webb
No. 589 vol 31. Forbear owns the South
half or 25 Acres

150 Acres Patented to the
heirs of H. Webb No. 925 vol 17

34 Acres off the north corner
W. Burnett 167 Acres

320 Acres Patented
to the heirs of H. Webb
No. 910 vol 10

J. C. Williams
& Executor

Ben Merrills Estate

Report of Comrs to
Benids Estate

How Court	
Less with advmt 7 mo	\$14.00
Geo Mack 7 mo	14.00
W. H. Thomas 7 mo	14.00
Specie	\$42.00

Surveys Fee	
18 miles Surveying	45.00

Filed April 29 1867
Geo. P. Thomas clk

Approved
April 29 1867

J. Ellis Coombs
County Judge
D. C. T.

237

5640
2820
3045
24275
711
1357
2185
1725

1900
117
1828