

**The History  
Of  
Wheelock Afro-American Cemetery  
Wheelock, Robertson County, Texas**

**Cemetery Established July 8, 1872  
Deed Recorded August 23, 1875**

Compiled and written by Estelle Mitchell Adams  
May 1, 2009  
*Revised September 2015*

## ***Statement***

The Wheelock Afro-American Organization is a unique group of Christ-like people. The cemetery is recognized as a sacred ground for the deceased.

This history is written for generations to come. In writing this history, I made contact with older members to have the material as accurate as possible. The contact persons were: Elmira Chambers Ray, Carrie Jane Brown Walker, J. D. Ray, and Hattie Mae Latson.

I was born and raised in the town of Wheelock, Texas. I have always loved and supported the community. How grateful I am for my parents, Elijah and Amanda Dunn Mitchell, for giving the strong feeling of roots, their conviction that well taught me that you could make the most of life, no matter what it brings. I enjoy writing history and giving back to the community I love, Wheelock, Texas.

It is our responsibility to see that the graves of our loved ones are always beautified. In my capacity as current President of the cemetery organization, I maintain a mailing list of more than 130 relatives of those buried in Wheelock Cemetery. An annual mailing is sent to each about upcoming cemetery support activities including funding and maintaining the burial grounds.

How grateful I am to my daughter Deri Y. Adams Hooper and my grandchildren, Miya Yvonne Hooper and Sherard Ormond Hooper, for their assistance and support, creativity and doing the work to put together what will be this first written history of the Wheelock Afro-American Cemetery.

*Estelle Mitchell Adams*

***Celebration of the History of  
Wheelock Afro-American Cemetery  
Wheelock, Robertson County, Texas  
Originally presented  
August 23, 1975, at 10:00 a.m. - Franklin, Texas  
and revised September 2015***

The history of black Americans may not be abundant in the libraries across America, but it is readily available in every Afro-American cemetery. Buried in the cemeteries are hundreds of years of hidden information, waiting to be rediscovered and preserved. These cemeteries are places that reveal much of what is great, courageous, tragic, pompous, and absurd about people who lived in the community.

When black churches were established, burial grounds were often established next to the churches. It is believed that the earliest black cemetery near Wheelock was the old Triumph cemetery (currently referred to as “Trump Cemetery”) near the Triumph Baptist Church in the woods on land which is now known as Jack Rabbit Lane between Old San Antonio Road and Farm Road #391. The Triumph Cemetery was lost until 2001 when historian Robert Golf located the cemetery on the property of Mr. Drew Moss. The Texas death certificate of Mr. Golf’s relative, Mary Kay Love, shows her burial in the Triumph Cemetery on July 12, 1931, possibly the last documented burial there. A historical marker was applied for by Mr. Golf, approved by the State of Texas in 2004, and installed at the front entrance of the cemetery which, although now surrounded by woods, can be entered from Jack Rabbit Lane.

Historically in the days of 1800s, cemeteries were not organized as they are today. Mrs. Mary Wheelock and other white people who helped to establish the Wheelock Cemetery did not know that someday in America there would be integration. One might have thought that segregation would always be. She and her family had wealth and unusual character and were sympathetic, economical, ambitious, generous and kind-hearted. It is believed that Mrs. Wheelock might have had in her mind a more enlightened community with a community cemetery for all the people—white, black and Hispanic—who lived in Wheelock, opening the door for integration long before it came into formal existence. Many good things of life have and will occur as a result of her giving for the good of all. Many a weary traveler along the rough country road enjoyed a relief from burdens by the news of a good outstanding community person, Mary P. Wheelock.

The most important thing in Mrs. Wheelock’s mind was to be sure to establish in deeds a burial ground for the entire Wheelock community for both the wealthy and poor families. She knew the welfare of the unfortunate and that the poor did not have money to buy burial ground so her burial ground had no need for an application. Just come as a family and select your plot.

Representing her love for the entire Wheelock community, the land for the Wheelock Cemetery, originally owned by the Wheelock family, was divided into three sections, representing the population of the white, black and Hispanic communities. Current section boundaries are

documented in this history. The Wheelock Cemetery land for blacks was donated July 8, 1872, and recorded August 23, 1875 in Franklin, Texas. Besides Mary Prickett Wheelock, other persons whose names were cited in the Wheelock Cemetery deed transfer document include George Ripley Wheelock, Samuel Blackburn Killough, David Prickett Wheelock (son of Mary P. Wheelock), and Abraham McMordie.

Although it is not known when blacks first moved into the Wheelock community, an era of local black history begins with this cemetery.

The blacks were given land. We do not know at this writing who the very early black settlers were but we know some of their names from the tombstones and big brown rocks. We believe many graves are lost because of no headstones or markers before the cemetery was cared for and organized and designated as sacred ground.

Although, in its early existence, the guidelines for those who wanted burial ground allowed families to come and pick their plot for their families to be buried for free, today (2015) burials are generally limited to those families who have established grave plots from generation to generation.

When the Wheelock Cemetery was established, the cemetery was divided between whites, who were buried in the front of the cemetery and blacks and Hispanics who were buried in the back. The gravel road that still exists on the side of the cemetery is the old Hearne Road. Years passed and the road was straightened out because the curves were so dangerous and there were many accidents. The old Hearne Rd was named Fm. Rd. #391. This road movement changed the exit of the cemetery. That is why in 2015 the black and Hispanic burials are now in the front part of the cemetery.

A survey was made by Estelle Mitchell Adams in 2001 of existing headstones in an effort to determine the age of the cemetery. (There may be other older graves with no stones, only brown rocks.) The following are the earliest names and death years found on existing headstones in 2001: They are:

Millie Elmore	1880
Carolyn Nash	1896
Mariah Nash	1896
Priscilla Ray	1899
Ira Nash	1900
Essex Payne	1900
Sam Mitchell	1912 (my grandfather)
Mollie Glenn	1915
Tom Cavitt	1917
Grace Wooley	1917
Cleveland Chambers	1918
Martha Chambers	1919
Beverly Ellis	1919

It is said that during the depression the cemetery was organized by a group of people into an

association. Lucy Stubbs Mitchell (my grandmother) organized the association with other families. They were the families of Henry Dunn, J. D. Dunn, George Cavitt, Joe Nash, Oscar Elmore, Johnnie Payne, Henry Chambers, Peter Walker, Fred Ellis, Hector Montgomery, Ben Williams, Sam Mitchell (my grandfather), Willis Perkins, Jim Petty, James Gary, William Sims, Floyd Brown, James Dunn and George Childress.

The black community always had pride for their cemetery and participated in regular cemetery cleanings. After the crops were laid, a date was designated as cemetery clean-up once a year. Every family would come either in wagons or walking or riding horses. They brought their tools for the hard work. Rakes, hoes, shovels, picks, saws, and jugs of water were brought to work on the project. Everyone stayed all day cleaning and burning trash. A meeting was held to discuss plans for another year and how to keep organized and informed. Under the big oak trees everyone ate their lunch at noon.

When there was a death in the family, friends and family dug the grave for the deceased. As years passed, the late Arthur (Dock) Mitchell volunteered to be responsible for the digging of graves. He always had help from Elijah Mitchell (my father), Norman Mitchell, Jim Petty, James Gray, Hector Montgomery, J. D. Dunn, Floyd Brown, Peter Walker, and Willis Perkins. James Bassett is doing this in 2015.

All labor was done free with love for the families. After the death of my grandmother Lucy Mitchell on June 4, 1934, Bertha Mitchell Sheppard and Nancy Walker organized the cemetery club again. Nancy Walker was President and Bertha Sheppard was the treasurer. They collected one dollar for dues. Later, dues were five dollars. The money was collected to purchase tools for cleaning and the upkeep of the cemetery.

After the two ladies passed away, Hattie M. Galloway Latson became the treasurer and Daisy Davis the President. Both served until they were ill and could no longer assume the responsibility of the organization. Betty Davis served as acting president and treasurer until Hattie Latson reorganized the club. In June, 1990, Mildred Ray Davis was elected president, Estelle Mitchell Adams, secretary, and Mary Evans, treasurer.

The organization purchased a riding lawn mower. The dues became fifteen dollars. Later, the membership voted to raise the dues to twenty dollars. Still later, due to inflation and the rising cost of keeping the cemetery up, the membership again voted to raise dues to forty dollars, where they remain today (September 2015). The cemetery is cut every month. When in 1990 Hattie Latson resigned as treasurer, the organization had three thousand dollars in the treasury. In September 2015 the balance is about ten thousand dollars.

In June, 1997, Mildred Davis moved away and the membership voted for Estelle Mitchell Adams for the President and Charlene Davis for treasurer. Later, Mary Smith was elected treasurer. The officers today (September 2015) are Estelle Mitchell Adams – President; John Latson – Treasurer; Deri Adams Hooper – Secretary; and Carolyn Basset – Membership Chairman.

For more than fifty years Elmira Chambers Ray was the Membership Chairman. She always was dutiful and gave support to see that money was collected for the beautification of the cemetery. Her brother-in-law, the late J. D. Ray, was the Chaplain and Parliamentarian for over sixty years. He served well and dutifully. Today, September 2015, Elmira Ray is in her late 90s and living in Bryan, Texas.

In 1997, under the leadership of Estelle Mitchell Adams, a cemetery burial inventory was created containing a list of names and death years, if on the tombstone. The committee members who assisted with the project were: Charlene David, Mary Smith, Gladys Smith, Patricia Hamilton, and Janice Cavitt. A list was also made of all military veterans honored in the cemetery. After the map was developed, a membership roster was established that included names, addresses, and telephone numbers. Deri Y. Adams Hooper and her daughter Miya Y. Hooper assist with all the typing, copying, and collating materials. In 2014 the mailing was sent to about one hundred thirty five member addresses.

In 1997 the Constitution and By-Laws were developed by Estelle Mitchell Adams and approved by the membership of the organization. The organization meets the last Saturday in April and November each year. The treasurer gives a report at each meeting and all money is accounted for. This Wheelock Cemetery organization has character and historical significance to the community. Things that matter to the members of this organization are love, respect, cooperation, dedication, support, maintaining the organization, and helping one another.

Both the black and the white cemeteries are well organized and established. The road in the cemetery was improved with gravel. Much care is given monthly to keep the cemetery beautified. The whites and blacks cut their section around the same time in order for it to always look the same. And of course each month poison is spread for ants and bugs.

For Mothers' Day, Fathers' Day and Christmas both cemeteries are beautiful with lovely flowers placed on the graves by family members in memory of their loved ones.

Each year members and friends of the white cemetery organization return in May to the Cemetery's Social Center for their community affair. Members who have moved away return for the fellowship observance. The centerpiece of this all-day celebration is a lavish outdoors covered-dish feast prepared by the women and men of the organization. It is a generous affair. Long running tables are draped and filled to the edge with all the favorites—platters and platters of baked hams, bar b que pork ribs, fried chicken, briskets, deer meat, all kinds of salads, beans, all kinds of desserts and sweet ice tea. A special program is given by the organization and all give their contributions for the upkeep of their part of the cemetery.

Although Mary P. Wheelock established burial ground for Hispanics, their population in Wheelock was very small. A few families had come, mostly from Mexico, to live and work picking cotton, first on a plantation in Bryan, then moving to the old Dunn plantation in Wheelock. Times were hard and most were unable to make a profit from their wages less their living expenses. When Bryan Air Force Base opened up in Bryan and provided better employment opportunities during World War II and the Korean War, many families moved to Bryan. Others moved to Dallas and to Houston.

The Wheelock community had a hand of sympathy for the Mexicans in sorrow and losses. The families were devoted people, regardless of their obstacles. Some Hispanic families began attending

the Baptist church because there were no available Catholic churches in the Wheelock area. Hispanics known to be buried in the Wheelock Cemetery are Juanita Hidrogo, Patra and Herculano Ybarra, Jose D'Briones, Ralph Gonzales, Delfina Sustaita Ybarra, Christopher Ray Juarez, Vicente P. Hernandez, Rev. Pablo E. Hernandez, and the Andy Sustaita family. Although very few descendants live near Wheelock now and there are not likely to be any more Hispanic burials in Wheelock cemetery, Mr. Andy Martinez reports that at least two families—his and the Juarez family—try to return each year to help beautify their grave plots as part of the white cemetery association's "homecoming" event.

Members and friends of the black cemetery organization have a planned program and annually money is collected for the yearly beautification upkeep. This is an affirmation of fellowship for all members and friends far and near. Chairs and tables are set for the gathering under many cedar trees, big oak trees, and beautiful blooming crape myrtle trees. Many are seated on blankets on the ground or perched on truck tailgates. All families bring their boxes and baskets of all kinds of food. Families share their food with each other. Good country cooking, simple and pure. The menu consists of fried chicken, corn pudding, butter beans, sweet glazed sweet potatoes, all kinds of salads, baked hams, briskets, corn pones, fried okra, all kind of cakes and pies, much lemonade and ice tea. As the people share their food, "those in the know" cannily seek out the dishes made by the finest cooks. Games are played by anyone that wants to participate and anyone can decorate the graves of their loved ones.

***Deed transfer for Wheelock Cemetery***

Pages 496-497

Mary P. Wheelock

To Deed

S. B. Killough et al

Know all men by these presents that for the love I bear to the community and society of Wheelock Robertson County, Texas, and for the further consideration of one dollar United States money to me in hand paid the receipt of which is hereby acknowledged do this day give donate and bequeath unto G. R. Wheelock S. B. Killough D. P. Wheelock and A. McMordie a certain tract or parcel of land including the Wheelock Grave Yard described as follows: viz. Beginning at a point on G. R. Wheelocks line between the buryel grounds of the whites and that of the blacks running Eastward or at right angles from said line 70 yards thence Northward paralel with said Wheelock line 105 yards thence Westward to said line and to the place of beginning including the buriel ground of the whites also a tract beginning at said beginning point running Southward with Wheelocks line 35 yards thence Eastward 70 yards thence Northward 35 yards thence to the beginning point including the buryel ground of the blacks. To have and to hold in trust for the white community for the exclusive purpose of a burying ground and to their preceptors as trustees to be selected by those interested as time and circumstances may require.

Given under my hand & seal this 8<sup>th</sup> day of July A. D. 1872

Attest Mary P. Wheelock ( S e a l )

W. H. Henderson

John T. Martin

The State of Texas

County of Robertson. Before the undersigned authority came and personally appear Mary P. Wheelock

(feme sole) to me known who acknowledged that she executed the Deed or instrument of writing to which this is attached for all the purposes and considerations therein contained and expressed.

In testimony whereof I hereunto sign my name with

( )  
( S e a l )  
( )

Seal of office affixed the 20<sup>th</sup> day of August, A.D. 1875

T. A. Menefee [?]

J. P. and N.P.R.C. [?]

Filed for record August 23<sup>o</sup> 1875 at 9 oclock a.m.

Recorded August 23<sup>o</sup> 1875 at 10 " a.m.

H. Haldeman

Clerk D. C. R. C.



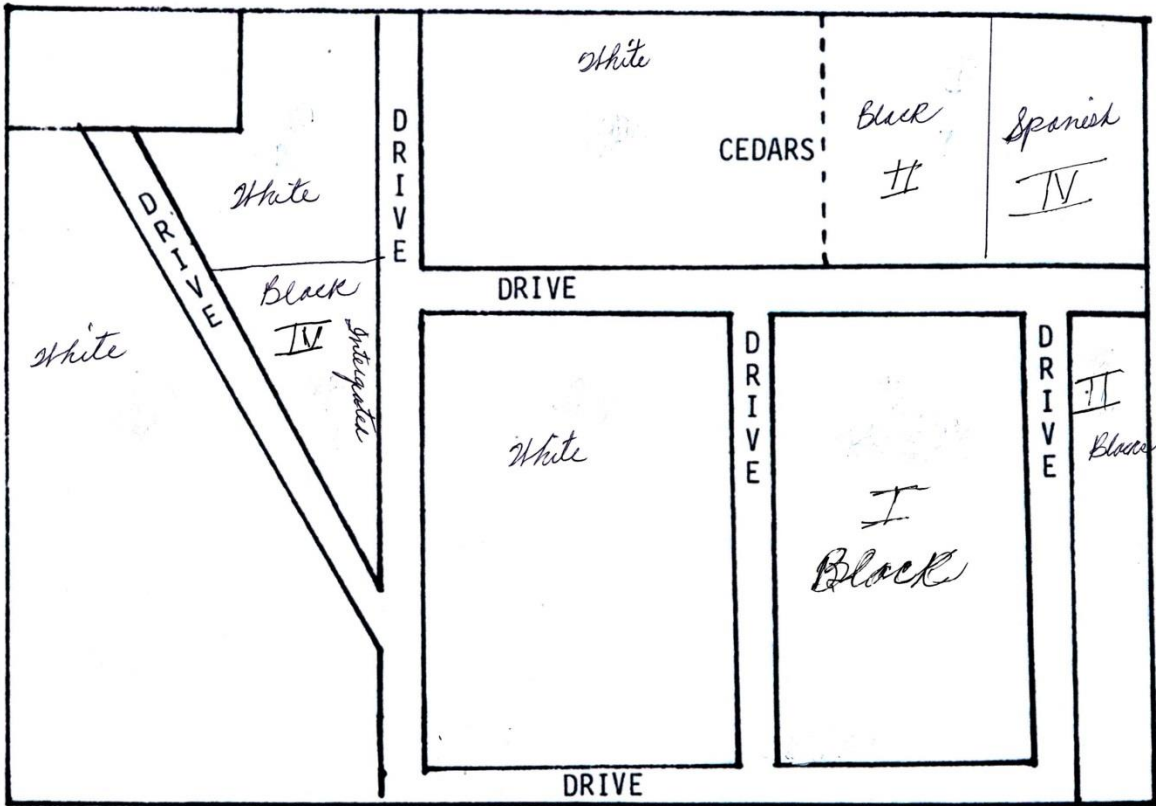

Wheelock Cemetery boundaries

Wheelock Cemetery, Robertson County, Texas

Lat: 30° 53' 22" N

Long: 96° 24' 15" W

To reach cemetery from Wheelock, take Farm to Market Road west, turn left (south) onto Road 391. Just as the road starts to bend right, take a right turn onto Wheelock Cemetery Road.

## ***Wheelock Cemetery Plots***

### **LOT I (all black)**

#### Plot. 1

Gooden, Henry  
Gooden, Ella  
Gooden, Dennis - no marker  
Gooden, Audry - died 1986  
Sellers, Pat Louis - died 1981  
Wright, James - died 1981  
Gooden, Floyd  
Gooden, Orena Daniel

#### Plot. 2

Gooden, Ruthie Mae - died 1996  
Gooden, R. L. - died 1985  
one grave unmarked  
Gooden, Robert L. Jr. - died 1999  
Gooden, Geneva A.  
Gooden, Ralph Jr.

#### Plot. 3

Wright, Minnie Lee - died 1966  
Smith, John H. - died 1990  
Smith, Ruben - died 1953  
Smith, Gladys - died 1994  
Wright, James Carl - died 1981  
Toliver Robert - died 2003

#### Plot. 4

Susenberry, Ella Gooden - died 1985  
Susenberry, Samuel B.

#### Plot. 5

Gooden, Tyree - died 1974  
Littelton, Baby - died 1959  
1 unmarked grave

#### Plot. 6

Brown, James - died 1972  
Brown, Juanita  
Anderson, Artis

Plot. 7

Petty, Arthur  
Petty, Richard  
Petty, Minerva  
Petty, Trotter - died 1950  
Nelson, Peggy

Plot. 8

Johnson, Seavilla - died 1946  
Johnson, Price - died 1939  
Johnson, Arthur - died 1990  
Johnson, Adolph Sr.

Plot. 9

Goree, Tynika Michalle - died 1991  
2 stones - unmarked graves

Plot. 10

Ray, Syvesta - died 1973  
Ray, Mitchell - died 1970  
Ray, Rosie Chambers - died 1983

Plot. 11

Walker, George - died 1964  
Walker, Betty - died 1967  
Glazier, Wilma Walker - died 2010

Plot. 12

Walker, Lee - died 1966  
Walker, Minerva - died 1994

Plot. 13

Ray, Arlelia - died 1991  
Ray, Fred Lee - (baby) Feb. 26 1945 - April. 1945  
Ray, J. D.  
Terrell, Elberta Ray  
Ray, Willis - died 2014

Plot. 14 "A"

Davis, Sam - died 1982  
Davis, Daisy - died 1986  
Davis, Cynthia - died 1993

Khrone, Marsha - died 1997  
Rice, Frank - died 1973

Plot. 14 "B"

Plot. 14 "C"  
Sheppard, M. D. - died 1989  
Sheppard, Willie F. - died 1996

Plot. 15  
The second wife of M. C. Gooden

Plot. 16  
Smith, Perry - died 1985  
Smith, Luverta - died 1985  
Smith, Willie - died 1965  
Smith, Johnnie M. - died  
Rev. Swaine (no marker)  
Smith, Mary - died 2014

Plot. 17  
Dunn, Jack - died 1985  
Dunn, Arsula - died 1951  
Dunn, Flossie - died  
Dunn, Robert - died 1986  
Dunn, Adelle - died 1992  
Dunn, Claudie - died 1974  
Thomas, Victor - died 1991  
Jackson, Ray - not related  
Conway, Ulon

Plot. 18  
Johnson, Tommie - died 1997  
Johnson, Betsie - died 2001  
Jones, Laura - died 2003

Plot. 19  
Allen, Clarence - died 1971  
Carrington, Emma - died 1979  
Baker, Lillie - died 1990  
Norwood, Alice G. - died

Plot. 20 "A"

Mitchell, Arthur - died 1980  
Mitchell, Pearlie - died 1988  
Mitchell, Herman - died 1972  
Holt, Pete - died 1984  
Rodgers, Katie Mitchell - died 1989  
Holt, Bessie Mitchell - died 1992

Plot. 20 "B"

Penson, Thomas - died 2008

Plot. 21

Mitchell, Sam Sr. - died 1912  
Mitchell, Lucy - died 1934  
Mitchell, Sam Jr. - died 1936  
Sheppard, Bertha - died 1960  
Walker, Archie - died 1966  
Latson, John Sr. - died 1979  
Latson, Hattie M. - died

Plot. 22 [Closed]

Mitchell, Will - died 1953  
Mitchell, Liza - died 1965  
Bell, Norma Ray - died 1948  
Bell, Willie - died 1940  
Campbell, Willie C. - died 1946  
Matthews, Bessie Mitchell - died

Plot. 23

Mitchell, Elvira - died  
Mitchell, Clifford (Buster) - died 1980  
Mitchell, Travis - died

Plot. 24 "A"

Mitchell, Elijah Sr. - died 1977  
Mitchell, Amanda Dunn - died 1972  
Phillips, Vera Mitchell - died 1981  
Adams, Chester Jr. - died 1983  
Baldwin, Esterline Mitchell - died 1989  
Mitchell, Beatrice Smith - died 1985  
Mitchell, Elijah Jr. - died 1997  
Mitchell, Sam - died 2000  
Adams, Chester Sr. - died 2007

Plot. 25

Robertson, Rose - died  
Banks Ethel - died 1981  
Johnson, Ella - died 1990  
Robertson, Nettie - died 1987  
Robinson, Mary - died 1996  
2 graves - no markers  
Robinson, Eddie  
Banks, Frank  
Robertson, Debra  
Robertson, (Shed) James  
Thomas, Sadie  
Robertson, Tommy  
Monroe, Johnnie M. Robertson

Plot. 26

Gary, (Jim) James Sr. - died 1991  
Gary, Eula B. - died 1950  
Gary, James Jr. - died 1997  
Robinson, Iva - died 1993  
Gary, Francis - died 1999

Plot. 27 [Closed]

Montgomery, Edward - died 1962  
2 graves unmarked

Plot. 28

Walker, Robert Jr. - no marker  
Walker, Alberta - no marker  
Walker, (Gator) Jessie  
Walker, (Buddie) Robert  
Walker, Marie (twins)  
Walker, Henry (twins)  
Walker, Rose Lee (wife)  
Walker, Cecelia (Grandmother)  
Walker, Perry  
Walker, Richard - died 2000

Plot. 29 [Closed]

Witherspoon, Harvey - died 1971  
Witherspoon, Celestine - died 1982

Plot. 30

Payne, George - died 1951  
Sates, Jessie - died 1983  
Walker, Travis Walker  
Zelma Payne

Plot. 31 [Closed]

Murphy, Charlie - died 1925  
no other markers

Plot. 32

Walker, Peter - died 1939  
Walker, Nancy  
Walker, Josephine  
Peterson. Marjorie Walker - died 2010

Plot. 33 [Closed]

Guy, Eli  
1 unmarked grave

Plot. 34

Ray, Joe Sr. - died 1941  
Ray, Harriet  
1 unmarked grave (believed to be the grandson of Dorrance Ray)

Plot. 35

Dunn, Fred Sr. - died 1974  
Dunn, Lee Ann - died 1946  
Archer, Elizabeth - died 1990

Plot. 36

vacant lot

Plot. 37

Dunn, Ollie - died 1972  
1 stone unmarked grave

Plot. 38

Dunn, Henry Sr. - no markers  
Dunn, Celia - wife  
Dunn, Minerva - daughter  
Dunn, Amanda  
Dunn, Myrtle - aunt

Dunn, Sam Jr.

Plot. 39 [Closed]

Cullous, Sadie - died 1948

Cullous, Rev.

2 stones unmarked grave

Plot. 40

Unmarked Grave

2 stones located by Crepe Myrtle Pink Tree as an indication of a plot

Plot. 41 [Closed]

Williams, Ben - no marker

Williams, Mary Mitchell

Williams, Ralph

Williams, Sam

Chambers, Bennie Williams

Plot. 42

Taylor, Bessie - died 1947

Taylor, Robert

Taylor, Mary Lee

Taylor, Mattie Williams

Taylor, John Henry (baby)

2 unmarked stones

Plot. 43 [Closed]

Walker, Ernest

Walker, Carrie

Walker, Infant baby

Plot. 44 [Closed]

Dunn, Bill

Richardson, Maggie

Bell, Emma Jones

Shaw, Ruth Cavitt

Simmons, Rebecca Dunn

Ray, Joe

Agison, Julia Tate

Agison, John

Bell, Sam

Plot. 45 [Closed]



Robinson, Henderson  
Robinson, Annie Bishop  
Robinson, Tolan  
Robinson, Sallie  
Robinson, Jewel

Plot. 46 [Closed]

Dunn, Jackie Sr. - died 1924  
Dunn, Cornelius - no marker  
Gary, Leslie

Plot. 47 [Closed]

Glenn, Mollie - died 1896  
2 stones unmarked grave

Plot. 48 [Closed]

Dunn, Carolyn - died  
Dunn, Mary Ardella/Idella - died 1980  
Dunn, Henry Jr.  
Dunn, Timpie Gillum  
2 unmarked stones

Plot. 49 [Closed]

Perkins, Willis - died 1951  
Perkins, Amanda Dunn - died 1928

Plot. 50 [Closed]

Carter, Henry - died 1951  
Carter, Evalene - died 1959  
Carter, Eli  
1 grave unmarked

Plot. 51 [Closed]

Draughan, Mary J - died 1931  
Foster, Louise - died 1988  
Foster, John  
Fair, Curt  
Person, Archie

Plot. 52 [Closed]

Ray, Fred - died 1978  
Elmira Ray - died 2015  
Chambers, George H. - died 2004

Plot. 53 [Closed]

Ray, Frances - died 1916  
Ray, E. B. - died 1926  
2 unmarked stones on the end  
Vincent, Maybelle Ray - died 1956  
Hickmon, Ida Ray - died 1983

Plot. 54 [Closed]

Lyons, Edd  
Lyons, Susie  
Lyons, Christine  
1 stone unmarked  
Lyons, Roberta  
Bishop, Andrew C. - died 1990  
Bishop, Mary Bertha - born: 1909 - died: 2002  
Drake, Diana - born: 1831 - died: 1916

Plot. 55 [Closed]

Petty, Jim - died 1937  
Petty, Johnnie - died 1945  
Petty, Harvey - died 1968  
1 unmarked grave  
Petty, Walter - died  
Petty, Georgia - died 1982  
Petty, Leatha - died 1981

Plot. 56

Petty, Felix Sr. - died 1974  
Petty, Felix Jr. - died 1984  
Petty, Melissa - died 1999  
1 unmarked grave

Plot. 57

Smith, Robert Dave - died 1997  
Smith, Sallie L. Petty - died 2004

Plot. 58

Chambers, Henry Sr. - died 1932  
Chambers, Pearl - died

Plot. 59

Payne, Essex - died 1911

Payne, George - died 1961  
1 unmarked stone  
Collard, Tennie - died 1937  
3 stones unmarked  
1 rock unmarked

Plot. 60

Hickmon, H.R. - died 1967  
Hickmon, Willie E. Jr.  
Hickmon, James - died 1922  
Hickmon, Curby  
Hickmon, Carilyn  
Hickmon, Henry J.  
Hickmon, Savannah - died 1981  
Hickmon, Virginia

Plot. 61 [Closed]

Nash, Ira - died 1990  
Nash, Mariah - died 1896  
Nash, Etta  
Nash, Lela R.  
Nash, Howard  
1 stone unmarked  
Nash, Katie

Plot. 62 [Closed]

Hearne, Mary  
Hearne, Henry

Plot. 63

Ellis, Beverly - died 1919  
Ellis, Sallie  
1 infant son - died  
2 infant daughter - died  
Ellis, William  
Ellis, Mary

Plot. 64

(empty plot)

Plot. 65

Hickman, Nathaniel - died 1994  
Hickman, Theophilus S. - died 1972

Hickman, Willie, Sr.  
Hickman, Almedia - Aug 4,1919 - Jan 1, 2008

Plot. 66

Petty, Odessa - died 1968  
Lewis, Brenda - died 1977  
Lewis, Joe L. - died 1996  
Lewis, J.W. - died 1975  
Petty, Espanalia Lewis  
Lewis, James

Plot.67 [Closed]

Sims, (Bill) William - died 1938  
Sims, Cornelius (Cavitt)  
Sims, Lula Earl  
Sims, Julius - no marker

Plot.68 [Closed]

Cavitt, George Jr. - died 1920  
Cavitt, Minerva - died 1928  
Cavitt, George Sr. - died  
Cavitt, Mamie - died 1949  
Cavitt, Norman - died 1958  
Cavitt, Maybelle Glenn - died 1960  
Walker, Lizzie - died  
Cavitt, Ray - died 1972  
Cavitt, R. L. - died 1974

Plot. 69

Drayton, Willie C. - died 1970  
Johnson, Archie - died 1969  
Ford, Ethel - died 1989  
Edditon, Katie - died 1983  
Edditon, George - died 1983

Plot. 70 [Closed]

Chambers, Henry Sr. - died 1932  
Chambers, Pearl - died 1981  
Chambers, Cleveland - died 1918  
Chambers, Martha Luster - died 1919  
Chambers, Henry Jr. - died 1998  
Chambers, Ethel Marie - died 2003

Plot. 71

Chambers, Powell - died 1942  
Chamber, (baby) Grady Jr. - died 1950  
Chambers, Rosie Lee Dunn - died  
Chambers, Grady Sr. - died

Plot. 72 [Closed]

Walker, Travis  
Walker, Zelma Payne

Plot. 73

Ross, Mattie - died 1930  
1 stone unmarked grave  
Gibbs, Earline - died 1996  
Gibbs, Carl  
Gibbs, Jerry - died 2010

Plot. 74

Harris, Charles - died 1944  
Harris, Mary - died 1961

Plot. 75

Ellis, W. M.  
1 stone marked - died 1894  
1 unmarked stone  
Ross, Robert - died 1894

Plot. 76

Hinton, Mike - died 1921  
Jones, Horace Jr. - died 1977  
Jones, Curtis - died 1982  
Jones, Horace Sr. - died 1985

Plot. 77 [Closed]

Ray, Hue  
Childress, George - died  
Childress, Alice Ray  
Hearne, Velma Ray  
Ray, Freddie Lee - died 1966

Plot. 78 [Closed]

Ray, Priscilla - died 1899  
Ray, Anthony - died

Gillum, Tempie

Plot. 79 [Closed]

Bishop, Lillie

Dunn, Leroy

Fryson, Beulah Dunn

Fryson, William - died 1964

Hollis, Sallie Dunn

Plot. 80

Dunn, George

Dunn, Emma

Bassett, Josephine - died 1979

Norwood Christine - died 1982

Hall, Louise - died 1997

Norwood, Susie B. Dunn - died 2002

Bassett, James Sr. - died 1999

Bassett, James Jr. - died 2005

Plot. 81 "A" - Owner: Susie Bassett Davis

Plot. 81 "B" - Owner: Mary Bassett Satchel

Plot. 82

Green, Tommie - died 1968

Green, Aaron L. Jr. - died 1979

Green, Charles - died

Green, Roma - Feb. 17, 1905 - March 23, 1989

Green, Rosie

Plot. 83

Green, Aaron Sr. - Feb. 22, 1928 - Aug. 8, 2007

Plot. 84

Stovall, Frank Sr. - Sept. 16, 1931 - June 21, 2004

Plot. 85

McClain, Peggy - died 2010

Plot. 86 - Owner: Eddie Lewis

**LOT II (all black)**

Plot. 1 [Closed]

Sheppard, Rance  
Sheppard, Pearlie  
Sheppard, Marshall  
Sheppard, Ella  
Sheppard, Ellen

Plot. 2 [Closed]

Tipton, Leroy  
Tipton, Mamie  
Tipton, Irene

Plot. 3

Sikes, Prunella Petty

Plot. 4

Petty, Imogene

Plot. 5

Vacant Lot

Plot. 6

Robertson, Johnnie  
Robertson, Sallie B.

Plot. 7 [Closed]

Cavitt, Tom - June 1, 1872 - April 28, 1917

There are three to four graves (rocks but no names) in this plot.

Plot. 8

Wooley, Grace - died 1917  
Wooley, Dave - died 1968  
Wooley, Anna - died  
Wooley, Howard - died  
Wooley, Nathaniel - died 1969  
Wooley, Rich - died  
Wooley, Edward - died  
Knox, L. G. - died 1996  
Knox, Blanch - died

Plot. 9

Wooley, Cecil - died

Wooley, Joyce - died

Plot. 10

Galloway, Mativia - died (first wife of M. C. Gooden)

Gooden, M. C. - died

Plot. 11

Ross, Lawrence - died

Ross, Laura - died

**LOT III (black)**

Plot. 1 [Closed]

Hill, George - died Mar.3, 1921

Hill, Margaret - died Sept. 24, 1924

Calhoun, Clarence - died Oct. 2, 1942

Hill, Infant twins

Wilson, Mary - born: 1878 - died: 1958

Plot. 2

Thomas, Martha - Nov. 24, 1878 - June 18, 1971

Plot. 3

Ross, Alfred - March 11, 1892 - Nov. 30, 1947

Ross, Eva H. - Feb. 16, 1904 - Oct. 1992

Ross, Williams Tenola - Feb. 22, 1927 - May 15, 1990

Ross, Anthony

Ross, Wanda Faye

Plot. 4

Gator, Dicey - born: 1902 - died 1993

Plot. 5

Chatman, no first name - born: 1972 - died: 1993

Plot. 6

Williams, Otha L.

Williams, Henry Sr. - died 1957

Williams, Freddie - died 1968

Plot. 7



Monroe, William H. - June 11, 1926 - June 28, 1985  
Monroe, George  
Monroe, Mattie - born: 1898 - died: 1966

Plot.8 [Closed]

Cavitt, Samuel - born: 1883 - died: 1977  
Cavitt, Rachel - born: 1890 - died: 1951  
Infant baby - buried at the foot of Rachel Cavitt  
Cavitt, Servillia - born: 1910 - died: 1993  
Cavitt, William Jr. - born: 1928 - died: 1968  
Cavitt, William Sr. - born: 1910 - died: 1970  
Washington, Norma Ray - died 1949  
Hood, Daisy Washington - born: 1947 - died: 1979  
Hutchinson, Jamie - born: 1933 - died: 1991  
Cavitt, A. D. - Jan. 6, 1970 - April 19, 1992  
McGee, Minerva - Jan 6, 1914 - Feb, 1962  
Caldwell, M. C. - June 25, 1936 - June 10, 1968  
Grace, Debra Dean - June 19, 1954 - 1954  
Grace, Valeria Cavitt - March, 1926 - Feb. 9, 1972

Plot. 9

Jefferson, no first name  
1 grave - no marker

Plot. 10

Curry, Willard D. - Sept. 27, 1935 - Feb. 21, 1960  
Curry, Dewitt - Sept. 23 1909 - June 30, 1947  
Curry, Viola - March 9, 1903 - March 24, 1989

Plot. 11

Nash, Joe - June 17, 1887 - July 2, 1970  
Nash, Leona - Aug. 9, 1883 - March 13, 1974  
Bryant, Alline Nash - born: 1919 - died: 1954  
Bryant, Debra K. - died Oct. 26, 1950  
Nash, Joe Jr. - died Oct. 26, 1974  
Nash, Rosie Lee - June 25, 1927 - May 13, 1986

Plot.12

Phillips, Jim - born: 1885 - died: 1985

Plot. 13

Walker, Eddie Sr. - June 26, 1916 - Nov. 9, 1985  
Walker, Jessie

Walker, Eddie Jr.

Plot. 14

Elmore, Millie -1880

Elmore, Oscar Curtis - March 2, 1909 - March 31, 1968

Blocker, Corine Elmore - Jan. 21, 1897 - Aug. 7, 1967

Elmore, Beulah - April 22, 1912 - April 11, 1992

Plot. 15

Brown Rock - No Name

one grave - no marker

Plot. 16

Brown Rock - No Name

one grave - no marker

Plot. 17

Foley, Leatha - born: 1910 - died: 1992

Foley, Patsy - born: 1955 - died: 1994

Byrd, Jessie - May 10, 1904 - May 10, 1971

Plot. 18

Smith, Regina - Jan. 30, 1967 - Feb. 13, 1978

Bishop, Bennie - born: 1933 - died: 1955

Reed, Earlene Bishop - born: 1936 - died: 1997

Jones, Minnie - born: 1936 - died: 1997

Jones, Irene Bishop - died 2010

Plot. 19

Johnson, Gwendolyn - June 12, 1996 - Jan. 15, 1990

Robinson, Martha Ann - May 21, 1897 - Feb 9, 1988

Williams, Freddie - born: 1944 - died: 1988

Teague, Ora - born: 1907 - died: 1980

Williams, Henry

Taylor, James - died 1999

Plot. 20

Childress, George - Aug. 15, 1876 - March 4, 1960

Childress, Mattie - born: 1980 - died: 1963

Green, Minnie - born: 1903 - died: 1977

Childress, Edith L. - June 25, 1921 - July 13, 1984

Childress, Vernon - Oct. 12, 1912 - Aug. 31, 1982

Childress, Sylvan - March 23, 1898 - Jan. 25, 1985

Richard, Roy Lee Jr. - Oct. 24, 1975 - Aug. 9 1995  
Childress, Laverne - Aug. 25, 1949 - March 19, 1996  
Nixon, Ernest A. -1943 -1988  
Childress, Pauline - died  
Edwards, Dave - died

Plot. 21

Monroe, Johnnie Mae - Jan. 29, 1935 - Sept. 24, 1984

**LOT IV (integrated plots)**

Plot.1 (Hickman, Betty- assigned)

Plot.2 (Green, Mazelle - assigned)

Plot.3 (Monroe, Mary- assigned)

Plot.4

Hamilton, Patricia - died 2004

Plot.5 (Cavitt, Kenneth & Janet -assigned)

Plot.6 (Harris, Rachel - assigned)

Plot.7 (Ransom, Elinor Groce - assigned)

Plot.8 (Groce, Williams & Jennifer - assigned)

Plot.9

Smith, Jeremiah - born: 1921 - died: 2010

Smith, Savannah – died 2011

Plot.10 (William, George - assigned)

Plot.11 (Young, Rachel - assigned)

Plot. 12 (Childress & Green Family -assigned)

Plot.13 (Rhodes, Debra Cavitt -assigned)

Plot. 14

Newton, Oscar - died 2007

Plot. 15 (Coleman, Sandra - assigned)

Plot. 16 (Hutchinson, Donna -assigned)  
Brown, Christopher Hutchinson - died 2010

Plot. 17 (Chambers, Billy - assigned)

Plot. 18 [Vacant]

Plot. 19 (Nix, Virginia – assigned)

Plot.20 (Cavitt, Valyree - assigned)

Plot.21 (Williams, Henry – assigned)

Plot.22 (Blue, Tommie Robinson - assigned)

Plot.23 (William John H. Jr. - assigned)

Plot.24 [Vacant]

Plot.25 (Edwards, Amy Williams - assigned)

Plot.26 (Williams, Leon – assigned)

Plot.27 [Vacant]

Plot.28 [Vacant]

Plot.29 [Vacant]

Plot.30 [Vacant]

Plot.31 [Vacant]

Plot.32 [Vacant]

Plot.33 [Vacant]

Plot.34 [Vacant]

Plot.35 [Vacant]

Plot.36 [Vacant]

Plot.37 (Johnson, Coretha Williams - assigned)

Plot.38 (Williams, Willie - assigned)

Plot.39 (Williams, Joe - assigned)

Plot.50 (Williams, John Sr. - assigned)

Plot.51 (Gulley, Leslie Williams - assigned)

Plot.52 (Williams, Joe – assigned)

**LOT V (Hispanic plots)**

**VETERANS HONORED AND BURIED IN WHEELOCK CEMETERY**

*(Each veteran has an official military service tombstone)*

**World War I -named in Plot 14**

Elijah Mitchell Sr.

Rev. J. D. Dunn

George Dunn

Joe Ray

Harvey Petty

Fred Ray

Henry Carter

Bess Ray

Norman Carter

Henry Dunn Jr.

William Frierson

Nathaniel Hickmon

Oscar Elmore

Clarence Calhoun

**World War II -named in Plot 15**

J. W. Petty

Sylvester Ray

Pete Holt

John Latson Sr.

James Brown

Felix Petty Jr.  
James Bassett  
Johnnie Roberson  
Willie Drayton  
Joe Nash Jr.  
Freddie Ray  
Alfred Ross  
Jessie Byrd  
Archie Pierson  
John Foster  
Chester W. Adams

**Korean War -named in Plot 7**

Robert Dunn  
Claudia Dunn  
William Ross  
Joseph Solomon  
Andrew Bishop  
M.C. Caldwell  
Willie Wilson  
Aaron Green

**Vietnam War -named in Plot 3**

Ernest Nixon  
Prince Adelle Dunn  
Horace Jones

